



Rogers

Assessment Property Record Card for Tax Year 2026

Data provided by LISA DELOZIER County Assessor

Date 04/18/2026
Time 09:47:25
Page 1

Assessment Data					Primary Image																																																																												
Account 660101845 Parcel ID 22N16E-09-2-00000-000-0002 Cadastral ID 09-22-16-00720 Property Type REAL - Real Property Property Class RR VI Area 1 Tax Area 11 - SEQUOYAH/NW FIRE Name ID 325590 MCKINLEY, RANDALL N & TAMMY L 12006 E 420 RD CLAREMORE OK 74017-0000 Parcel Location Situs 12006 E 420 RD Subdivision Lot/Block / Parcel Size 10 - Acres Sec/Twn/Rng 9 / 22 / 16 / 2 Neighborhood 6040 - UNPLATTED School District S006 - SEQUOYAH SCHOOLS																																																																																	
Legal Description Lat/Long: 36.40787991 -95.61382639																																																																																	
Building Permits					<table border="1"> <thead> <tr> <th>Number</th> <th>Description</th> <th>Opened</th> <th>Closed</th> <th>Amount</th> </tr> </thead> <tbody> <tr> <td colspan="5"> </td> </tr> </tbody> </table>					Number	Description	Opened	Closed	Amount																																																																			
Number	Description	Opened	Closed	Amount																																																																													
Exemptions					Sale History																																																																												
<table border="1"> <thead> <tr> <th>Code</th> <th>Type</th> <th>Active</th> <th>Maximum</th> <th>Exemption</th> </tr> </thead> <tbody> <tr> <td>H</td> <td>Homestead</td> <td>Yes</td> <td>1,000</td> <td>1,000</td> </tr> </tbody> </table>					Code	Type	Active	Maximum	Exemption	H	Homestead	Yes	1,000	1,000	<table border="1"> <thead> <tr> <th>Bk/Pg</th> <th>Grantor</th> <th>Date</th> <th>Price</th> <th>Code</th> </tr> </thead> <tbody> <tr> <td>2725/744</td> <td>GUZMAN, AUGUSTIN SR & LUCILA</td> <td>07/20/2018</td> <td>335,000</td> <td>YES</td> </tr> </tbody> </table>					Bk/Pg	Grantor	Date	Price	Code	2725/744	GUZMAN, AUGUSTIN SR & LUCILA	07/20/2018	335,000	YES																																																				
Code	Type	Active	Maximum	Exemption																																																																													
H	Homestead	Yes	1,000	1,000																																																																													
Bk/Pg	Grantor	Date	Price	Code																																																																													
2725/744	GUZMAN, AUGUSTIN SR & LUCILA	07/20/2018	335,000	YES																																																																													
Parcel Valuation																																																																																	
<table border="1"> <thead> <tr> <th>Source</th> <th>REAL</th> </tr> </thead> <tbody> <tr> <td>Remove Cap</td> <td>2019</td> </tr> </tbody> </table>		Source	REAL	Remove Cap	2019	<table border="1"> <thead> <tr> <th>Fair Cash</th> <th>Capped</th> <th>Asmnt Level</th> <th>Assessed</th> </tr> </thead> <tbody> <tr> <td>Land Value</td> <td>106,730</td> <td>88,598</td> <td>11%</td> <td>9,746</td> </tr> <tr> <td>Improvements</td> <td>337,974</td> <td>327,533</td> <td></td> <td>36,029</td> </tr> <tr> <td>Uncapped Value</td> <td>0</td> <td>0</td> <td>0</td> <td>0</td> </tr> <tr> <td>TIF Project ID</td> <td>0</td> <td></td> <td></td> <td></td> </tr> <tr> <td>Total Value</td> <td>444,704</td> <td>416,131</td> <td></td> <td>45,775</td> </tr> </tbody> </table>			Fair Cash	Capped	Asmnt Level	Assessed	Land Value	106,730	88,598	11%	9,746	Improvements	337,974	327,533		36,029	Uncapped Value	0	0	0	0	TIF Project ID	0				Total Value	444,704	416,131		45,775	<table border="1"> <thead> <tr> <th>Levy Rate</th> <th>Current Tax</th> </tr> </thead> <tbody> <tr> <td>102.332</td> <td></td> </tr> <tr> <td>Assessed</td> <td>45,775</td> </tr> <tr> <td>Penalty</td> <td>0</td> </tr> <tr> <td>Exemption</td> <td>1,000</td> </tr> <tr> <td>Total Taxable</td> <td>44,775</td> </tr> </tbody> </table>		Levy Rate	Current Tax	102.332		Assessed	45,775	Penalty	0	Exemption	1,000	Total Taxable	44,775																														
Source	REAL																																																																																
Remove Cap	2019																																																																																
Fair Cash	Capped	Asmnt Level	Assessed																																																																														
Land Value	106,730	88,598	11%	9,746																																																																													
Improvements	337,974	327,533		36,029																																																																													
Uncapped Value	0	0	0	0																																																																													
TIF Project ID	0																																																																																
Total Value	444,704	416,131		45,775																																																																													
Levy Rate	Current Tax																																																																																
102.332																																																																																	
Assessed	45,775																																																																																
Penalty	0																																																																																
Exemption	1,000																																																																																
Total Taxable	44,775																																																																																
Assessment History																																																																																	
<table border="1"> <thead> <tr> <th>Tax Year</th> <th>Statement Number</th> <th>Billed Owner</th> <th>Tax Area</th> <th>Total Value</th> <th>Exemptions</th> <th>Taxable Value</th> <th>Billed Tax</th> </tr> </thead> <tbody> <tr> <td>2025</td> <td>2025-660101845</td> <td>MCKINLEY, RANDALL N & TAMMY L</td> <td>11</td> <td>424,724</td> <td>1000</td> <td>43,441</td> <td>4,460.00</td> </tr> <tr> <td>2024</td> <td>2024-660101845</td> <td>MCKINLEY, RANDALL N & TAMMY L</td> <td>11</td> <td>441,115</td> <td>1000</td> <td>42,147</td> <td>4,343.00</td> </tr> <tr> <td>2023</td> <td>2023-660101845</td> <td>MCKINLEY, RANDALL N & TAMMY L</td> <td>11</td> <td>390,266</td> <td>1000</td> <td>40,890</td> <td>4,299.00</td> </tr> <tr> <td>2022</td> <td>2022-660101845</td> <td>MCKINLEY, RANDALL N & TAMMY L</td> <td>11</td> <td>393,820</td> <td>1000</td> <td>39,671</td> <td>4,198.00</td> </tr> <tr> <td>2021</td> <td>2021-660101845</td> <td>MCKINLEY, RANDALL N & TAMMY L</td> <td>11</td> <td>368,323</td> <td>0</td> <td>39,486</td> <td>4,019.00</td> </tr> <tr> <td>2020</td> <td>2020-660101845</td> <td>MCKINLEY, RANDALL N & TAMMY L</td> <td>11</td> <td>366,051</td> <td>0</td> <td>38,336</td> <td>4,029.00</td> </tr> <tr> <td>2019</td> <td>2019-660101845</td> <td>MCKINLEY, RANDALL N & TAMMY L</td> <td>11</td> <td>338,356</td> <td>0</td> <td>37,219</td> <td>3,858.00</td> </tr> <tr> <td>2018</td> <td>2018-660101845</td> <td>MCKINLEY, RANDALL N & TAMMY L</td> <td>11</td> <td>282,952</td> <td>0</td> <td>30,047</td> <td>3,148.00</td> </tr> </tbody> </table>										Tax Year	Statement Number	Billed Owner	Tax Area	Total Value	Exemptions	Taxable Value	Billed Tax	2025	2025-660101845	MCKINLEY, RANDALL N & TAMMY L	11	424,724	1000	43,441	4,460.00	2024	2024-660101845	MCKINLEY, RANDALL N & TAMMY L	11	441,115	1000	42,147	4,343.00	2023	2023-660101845	MCKINLEY, RANDALL N & TAMMY L	11	390,266	1000	40,890	4,299.00	2022	2022-660101845	MCKINLEY, RANDALL N & TAMMY L	11	393,820	1000	39,671	4,198.00	2021	2021-660101845	MCKINLEY, RANDALL N & TAMMY L	11	368,323	0	39,486	4,019.00	2020	2020-660101845	MCKINLEY, RANDALL N & TAMMY L	11	366,051	0	38,336	4,029.00	2019	2019-660101845	MCKINLEY, RANDALL N & TAMMY L	11	338,356	0	37,219	3,858.00	2018	2018-660101845	MCKINLEY, RANDALL N & TAMMY L	11	282,952	0	30,047	3,148.00
Tax Year	Statement Number	Billed Owner	Tax Area	Total Value	Exemptions	Taxable Value	Billed Tax																																																																										
2025	2025-660101845	MCKINLEY, RANDALL N & TAMMY L	11	424,724	1000	43,441	4,460.00																																																																										
2024	2024-660101845	MCKINLEY, RANDALL N & TAMMY L	11	441,115	1000	42,147	4,343.00																																																																										
2023	2023-660101845	MCKINLEY, RANDALL N & TAMMY L	11	390,266	1000	40,890	4,299.00																																																																										
2022	2022-660101845	MCKINLEY, RANDALL N & TAMMY L	11	393,820	1000	39,671	4,198.00																																																																										
2021	2021-660101845	MCKINLEY, RANDALL N & TAMMY L	11	368,323	0	39,486	4,019.00																																																																										
2020	2020-660101845	MCKINLEY, RANDALL N & TAMMY L	11	366,051	0	38,336	4,029.00																																																																										
2019	2019-660101845	MCKINLEY, RANDALL N & TAMMY L	11	338,356	0	37,219	3,858.00																																																																										
2018	2018-660101845	MCKINLEY, RANDALL N & TAMMY L	11	282,952	0	30,047	3,148.00																																																																										



Rogers

Assessment Property Record Card for Tax Year 2026

Data provided by LISA DELOZIER County Assessor

Date 04/18/2026
 Time 09:47:25
 Page 2

Lot Data		Square-Foot - NBHD 6040 #1	
Lot Size			
Lot Count			
Units Buildable			
Non-Ag Acres	10.001		
Topography			
Street Access			
Utilities			
Amenities	LAND QUALITY	0	0
Method	Square-Foot		
Base Lot Value	435,641.00 x .24 = 106,730		
Factor Value			
Adjustments	1.0000		
Lot Value	106,730		



\\tsclient\T\LOGAN\LOGAN RESIDENTIAL VI\2022-11-15\IMG_001 11/15/2022

Residential Data	
Type	1 Single Family Residence
Condition	3 - Average
Quality	3.5 - Average
Architecture	
Style	100% 1 1/2 Story Finished
Exterior Wall	100% Veneer, Masonry
Base/Total Area	1,932 / 2,732
Style	100% 1 1/2 Story Finished
HVAC	100% Warmed & Cooled Air
Roof Cover	1 Composition Shingle
Area on Slab	1,932
Fixture/RghIn	16 /
Bed/F/H Bath	3 / 2.5 /
Basement Area	
Garage Type	796 Attached Garage - Unfinished
Remodel	
Year/Eff Age	2002 / 18

GRM Approach	
GRM Code	
Gross Rent	0.00
Indicated Value	

Multiple Regression	
MRA Code	1 Test
Adusted R	0.8445
Indicated Value	381,760 139.74 Per SqFt

Direct Comparables	
Selection Model	1 Res
Adjustment Model	A2 AO Test
Comparables	
Indicated Value	

Cost Approach		Manual : 01/2025	
Base Cost	99.05	Total Misc Impr	+ 22,201
Roofing Adj	+ 3.84	Garage Cost	+ 29,619
Subfloor Adj	+ -2.43	Total RCN	= 391,216
Heat/Cool Adj	+ 14.47	Depreciation (20%)	- 78,243
Plumbing Adj	+ 9.30	Lump Sums	+ 0
Basement Adj	+ 0.00	RCNLD	= 312,973
Adj Base Cost	= 124.23	Lot Value	+ 106,730
Total Area	x 2,732	Indicated Value	= 419,703
Adjusted Cost	= 339,396	Value Per SqFt	153.62

Value Reconciliation	
Selected Approach	Cost Approach
Improvements	312,973
Lot Value	106,730
Indicated Value	419,703 153.62 Per SqFt
Agland Value	
Site Improvements	25,001
Total Value	444,704 162.78 Total Value Per SqFt

Miscellaneous Improvements								
Code	Description	Sketch ID	Size	Year	Units	Unit Cost	Depr	Value
FPR1	FIREPLACE - RESIDENTIAL 1 STORY	0		1	1	6,429.63		6,430
PRCH	SLAB PORCH - COVERED	23698		508	508	27.81		14,127
PRCH	SLAB PORCH - COVERED	23699		8x7	56	29.35		1,644



Rogers

Assessment Property Record Card for Tax Year 2026

Data provided by LISA DELOZIER County Assessor

Date 04/18/2026

Time 09:47:25

Page 3

Sketch Image

660101845

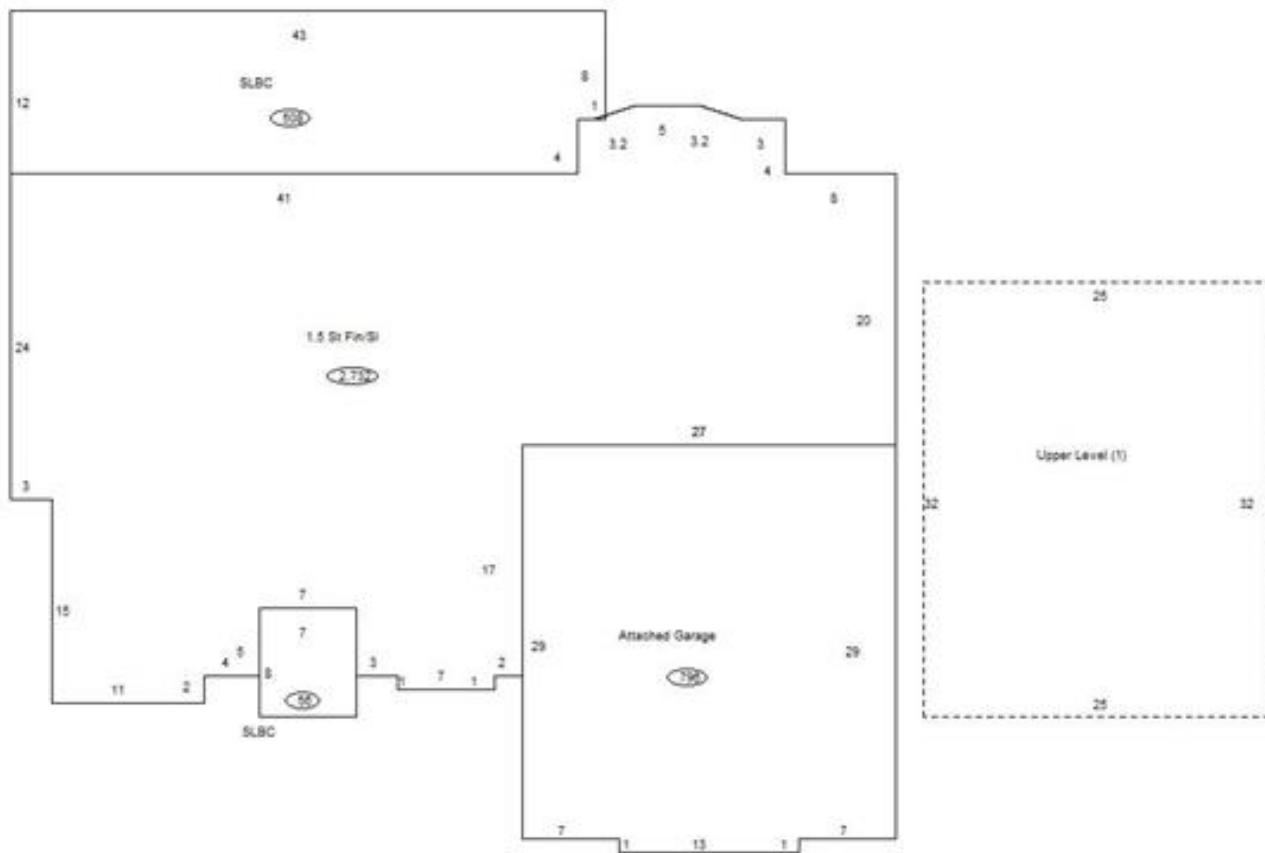

Sketch Vector Information

Sequence	Code	Type	Built Over	Scale	Section Label	Base Area	Multiplier	Total Area
1	R	5	Slab	10	1.5 St Fin/SI	1,932	1.414	2,732
2	G	1		10	Attached Garage	796	1.000	796
3	M	PRCH		10	SLBC	508	1.000	508
4	M	PRCH		10	SLBC	56	1.000	56
5	U	^UL		10	Upper Level (1)	800	1.000	800
Total Building Area						1,932		2,732



Rogers

Assessment Property Record Card for Tax Year 2026

Data provided by LISA DELOZIER County Assessor

Date 04/18/2026
Time 09:47:26
Page 4

660101845

Outbuildings/Site Improvements

Building Image	Code	Description	Dimensions	Floor	Roofing	Total Units
	BGP	BARN-GENERAL PUR (POLE)	0x0x0			2,100
	Qual	3	Cond 3	Year	Eff Age	
	Valuation Summary		Modifier Total	RCN	Depr (1% Phys/ % Func)	RCNLD
	Base Cost (10.66 x 2,100)	22,386		22,386	224	22,162
	LT	LEAN-TO	18x60x0			1,080
	Qual	3	Cond 3	Year	Eff Age	
	Valuation Summary		Modifier Total	RCN	Depr (10% Phys/ % Func)	RCNLD
	Base Cost (2.92 x 1,080)	3,154		3,154	315	2,839