



Rogers

Assessment Property Record Card for Tax Year 2026

Data provided by LISA DELOZIER County Assessor

Date 04/18/2026
Time 09:48:23
Page 1

Assessment Data					Primary Image																																																																												
Account 660101922 Parcel ID 22N16E-19-3-00000-000-0006 Cadastral ID 19-22-16-03434 Property Type REAL - Real Property Property Class RR VI Area 1 Tax Area 10 - OOLOGAH RURAL/NW FIRE Name ID 328131 ALEXANDER, RYAN WAYNE & ALLISON ELIZABETH 10114 E 445 RD CLAREMORE OK 74017-0000 Parcel Location Situs 10114 E 445 RD Subdivision Lot/Block / Parcel Size 1.03 - Acres Sec/Twn/Rng 19 / 22 / 16 / 3 Neighborhood 6030 - UNPLATTED School District S004 - OOLOGAH SCHOOLS																																																																																	
Legal Description Lat/Long: 36.37212925 -95.64870868																																																																																	
Legal Description TR COMM NW/C LOT 3; N88.2919E 510.15' TO POB; N88.2919E 150'; S01.2143E 300'; S88.2919W 150'; N01.2143W 300' TO POB					Building Permits <table border="1"> <thead> <tr> <th>Number</th> <th>Description</th> <th>Opened</th> <th>Closed</th> <th>Amount</th> </tr> </thead> <tbody> <tr> <td>R19</td> <td>R20- SPLIT</td> <td>10/2018</td> <td>04/2019</td> <td></td> </tr> </tbody> </table>					Number	Description	Opened	Closed	Amount	R19	R20- SPLIT	10/2018	04/2019																																																															
Number	Description	Opened	Closed	Amount																																																																													
R19	R20- SPLIT	10/2018	04/2019																																																																														
Exemptions <table border="1"> <thead> <tr> <th>Code</th> <th>Type</th> <th>Active</th> <th>Maximum</th> <th>Exemption</th> </tr> </thead> <tbody> <tr> <td>H</td> <td>Homestead</td> <td>Yes</td> <td>1,000</td> <td>1,000</td> </tr> </tbody> </table>					Code	Type	Active	Maximum	Exemption	H	Homestead	Yes	1,000	1,000	Sale History <table border="1"> <thead> <tr> <th>Bk/Pg</th> <th>Grantor</th> <th>Date</th> <th>Price</th> <th>Code</th> </tr> </thead> <tbody> <tr> <td>/</td> <td>DAKE PROPERTIES INC</td> <td>07/02/2019</td> <td>194,000</td> <td>YES</td> </tr> <tr> <td>/</td> <td>INTRINSIC DEVELOPMENT LLC</td> <td>09/25/2018</td> <td>0</td> <td>4</td> </tr> </tbody> </table>					Bk/Pg	Grantor	Date	Price	Code	/	DAKE PROPERTIES INC	07/02/2019	194,000	YES	/	INTRINSIC DEVELOPMENT LLC	09/25/2018	0	4																																															
Code	Type	Active	Maximum	Exemption																																																																													
H	Homestead	Yes	1,000	1,000																																																																													
Bk/Pg	Grantor	Date	Price	Code																																																																													
/	DAKE PROPERTIES INC	07/02/2019	194,000	YES																																																																													
/	INTRINSIC DEVELOPMENT LLC	09/25/2018	0	4																																																																													
Parcel Valuation <table border="1"> <thead> <tr> <th>Source</th> <th>REAL</th> <th>Fair Cash</th> <th>Capped</th> <th>Asmnt Level</th> <th>Assessed</th> <th>Levy Rate</th> <th>108.182</th> <th>Current Tax</th> </tr> </thead> <tbody> <tr> <td>Remove Cap</td> <td>2020</td> <td>Land Value</td> <td>45,225</td> <td>36,221</td> <td>11%</td> <td>3,984</td> <td>Assessed</td> <td>25,360 2,743.48</td> </tr> <tr> <td>Year Frozen</td> <td></td> <td>Improvements</td> <td>236,134</td> <td>194,330</td> <td></td> <td>21,376</td> <td>Penalty</td> <td>0</td> </tr> <tr> <td>Uncapped Value</td> <td>0</td> <td>Mobile Home</td> <td>0</td> <td>0</td> <td>0</td> <td>0</td> <td>Exemption</td> <td>1,000 -94.00</td> </tr> <tr> <td>TIF Project ID</td> <td>0</td> <td>Total Value</td> <td>281,359</td> <td>230,551</td> <td>25,360</td> <td>Total Taxable</td> <td>24,360</td> <td>2,649.00</td> </tr> </tbody> </table>										Source	REAL	Fair Cash	Capped	Asmnt Level	Assessed	Levy Rate	108.182	Current Tax	Remove Cap	2020	Land Value	45,225	36,221	11%	3,984	Assessed	25,360 2,743.48	Year Frozen		Improvements	236,134	194,330		21,376	Penalty	0	Uncapped Value	0	Mobile Home	0	0	0	0	Exemption	1,000 -94.00	TIF Project ID	0	Total Value	281,359	230,551	25,360	Total Taxable	24,360	2,649.00																											
Source	REAL	Fair Cash	Capped	Asmnt Level	Assessed	Levy Rate	108.182	Current Tax																																																																									
Remove Cap	2020	Land Value	45,225	36,221	11%	3,984	Assessed	25,360 2,743.48																																																																									
Year Frozen		Improvements	236,134	194,330		21,376	Penalty	0																																																																									
Uncapped Value	0	Mobile Home	0	0	0	0	Exemption	1,000 -94.00																																																																									
TIF Project ID	0	Total Value	281,359	230,551	25,360	Total Taxable	24,360	2,649.00																																																																									
Assessment History <table border="1"> <thead> <tr> <th>Tax Year</th> <th>Statement Number</th> <th>Billed Owner</th> <th>Tax Area</th> <th>Total Value</th> <th>Exemptions</th> <th>Taxable Value</th> <th>Billed Tax</th> </tr> </thead> <tbody> <tr> <td>2025</td> <td>2025-660101922</td> <td>ALEXANDER, RYAN WAYNE &</td> <td>10</td> <td>271,710</td> <td>1000</td> <td>23,622</td> <td>2,569.00</td> </tr> <tr> <td>2024</td> <td>2024-660101922</td> <td>ALEXANDER, RYAN WAYNE &</td> <td>10</td> <td>287,724</td> <td>1000</td> <td>22,905</td> <td>2,413.00</td> </tr> <tr> <td>2023</td> <td>2023-660101922</td> <td>ALEXANDER, RYAN WAYNE &</td> <td>10</td> <td>236,256</td> <td>1000</td> <td>22,209</td> <td>2,323.00</td> </tr> <tr> <td>2022</td> <td>2022-660101922</td> <td>ALEXANDER, RYAN WAYNE &</td> <td>10</td> <td>238,312</td> <td>1000</td> <td>21,533</td> <td>2,242.00</td> </tr> <tr> <td>2021</td> <td>2021-660101922</td> <td>ALEXANDER, RYAN &</td> <td>10</td> <td>199,260</td> <td>1000</td> <td>20,877</td> <td>2,191.00</td> </tr> <tr> <td>2020</td> <td>2020-660101922</td> <td>ALEXANDER, RYAN &</td> <td>10</td> <td>193,085</td> <td>1000</td> <td>20,239</td> <td>2,155.00</td> </tr> <tr> <td>2019</td> <td>2019-660101922</td> <td>ALEXANDER, RYAN &</td> <td>10</td> <td>24,209</td> <td>0</td> <td>2,663</td> <td>277.00</td> </tr> <tr> <td>2018</td> <td>2018-660101922</td> <td>DAKE PROPERTIES INC</td> <td>10</td> <td>268</td> <td>0</td> <td>29</td> <td>3.00</td> </tr> </tbody> </table>										Tax Year	Statement Number	Billed Owner	Tax Area	Total Value	Exemptions	Taxable Value	Billed Tax	2025	2025-660101922	ALEXANDER, RYAN WAYNE &	10	271,710	1000	23,622	2,569.00	2024	2024-660101922	ALEXANDER, RYAN WAYNE &	10	287,724	1000	22,905	2,413.00	2023	2023-660101922	ALEXANDER, RYAN WAYNE &	10	236,256	1000	22,209	2,323.00	2022	2022-660101922	ALEXANDER, RYAN WAYNE &	10	238,312	1000	21,533	2,242.00	2021	2021-660101922	ALEXANDER, RYAN &	10	199,260	1000	20,877	2,191.00	2020	2020-660101922	ALEXANDER, RYAN &	10	193,085	1000	20,239	2,155.00	2019	2019-660101922	ALEXANDER, RYAN &	10	24,209	0	2,663	277.00	2018	2018-660101922	DAKE PROPERTIES INC	10	268	0	29	3.00
Tax Year	Statement Number	Billed Owner	Tax Area	Total Value	Exemptions	Taxable Value	Billed Tax																																																																										
2025	2025-660101922	ALEXANDER, RYAN WAYNE &	10	271,710	1000	23,622	2,569.00																																																																										
2024	2024-660101922	ALEXANDER, RYAN WAYNE &	10	287,724	1000	22,905	2,413.00																																																																										
2023	2023-660101922	ALEXANDER, RYAN WAYNE &	10	236,256	1000	22,209	2,323.00																																																																										
2022	2022-660101922	ALEXANDER, RYAN WAYNE &	10	238,312	1000	21,533	2,242.00																																																																										
2021	2021-660101922	ALEXANDER, RYAN &	10	199,260	1000	20,877	2,191.00																																																																										
2020	2020-660101922	ALEXANDER, RYAN &	10	193,085	1000	20,239	2,155.00																																																																										
2019	2019-660101922	ALEXANDER, RYAN &	10	24,209	0	2,663	277.00																																																																										
2018	2018-660101922	DAKE PROPERTIES INC	10	268	0	29	3.00																																																																										



Rogers

Assessment Property Record Card for Tax Year 2026

Data provided by LISA DELOZIER County Assessor

Date 04/18/2026
 Time 09:48:23
 Page 2

Lot Data	Square-Foot - UNPLATTED (ACRES)	Primary Image
Lot Size		
Lot Count		
Units Buildable		
Non-Ag Acres	0	
Topography		
Street Access		
Utilities		
Amenities	LAND QUALITY	
	0	
	0	
Method	Square-Foot	
Base Lot Value	45,004.00 x 1.00 = 45,225	
Factor Value		
Adjustments	1.0000	
Lot Value	45,225	

Residential Data	
Type	1 Single Family Residence
Condition	3 - Average
Quality	3 - Average
Architecture	
Style	100% One Story
Exterior Wall	10% Frame, Siding, Wood 90% Veneer, Masonry
Base/Total Area	1,700 / 1,700
Style	100% One Story
HVAC	100% Warmed & Cooled Air
Roof Cover	1 Composition Shingle
Area on Slab	1,700
Fixture/RghIn	11 /
Bed/F/H Bath	3 / 2.0 /
Basement Area	
Garage Type	462 Attached Garage - Unfinished
Remodel	
Year/Eff Age	2019 / 5



\\tsclient\T\LOGAN\LOGAN RESIDENTIAL VI\2022-12-07\IMG_00 12/9/2022

GRM Approach	
GRM Code	
Gross Rent	0.00
Indicated Value	

Multiple Regression			
MRA Code	1	Test	
Adusted R	0.8445		
Indicated Value	246,438	144.96	Per SqFt

Direct Comparables	
Selection Model	1 Res
Adjustment Model	A2 AO Test
Comparables	
Indicated Value	

Cost Approach				Manual : 01/2025	
Base Cost	110.38	Total Misc Impr	+	4,557	
Roofing Adj	+ 4.86	Garage Cost	+	15,015	
Subfloor Adj	+ -2.31	Total RCN	=	248,562	
Heat/Cool Adj	+ 12.64	Depreciation (5%)	-	12,428	
Plumbing Adj	+ 9.13	Lump Sums	+	0	
Basement Adj	+ 0.00	RCNLD	=	236,134	
Adj Base Cost	= 134.70	Lot Value	+	45,225	
Total Area	x 1,700	Indicated Value	=	281,359	
Adjusted Cost	= 228,990	Value Per SqFt		165.51	

Value Reconciliation			
Selected Approach	Cost Approach		
Improvements	236,134		
Lot Value	45,225		
Indicated Value	281,359	165.51	Per SqFt
Agland Value			
Site Improvements			
Total Value	281,359	165.51	Total Value Per SqFt

Miscellaneous Improvements								
Code	Description	Sketch ID	Size	Year	Units	Unit Cost	Depr	Value
PRCH	SLAB PORCH - COVERED	140885	19x8		152	26.45		4,020
PRCH	SLAB PORCH - COVERED	140886	5x4		20	26.87		537



Rogers

Assessment Property Record Card for Tax Year 2026

Data provided by LISA DELOZIER County Assessor

Date 04/18/2026
 Time 09:48:23
 Page 3

Sketch Image

660101922

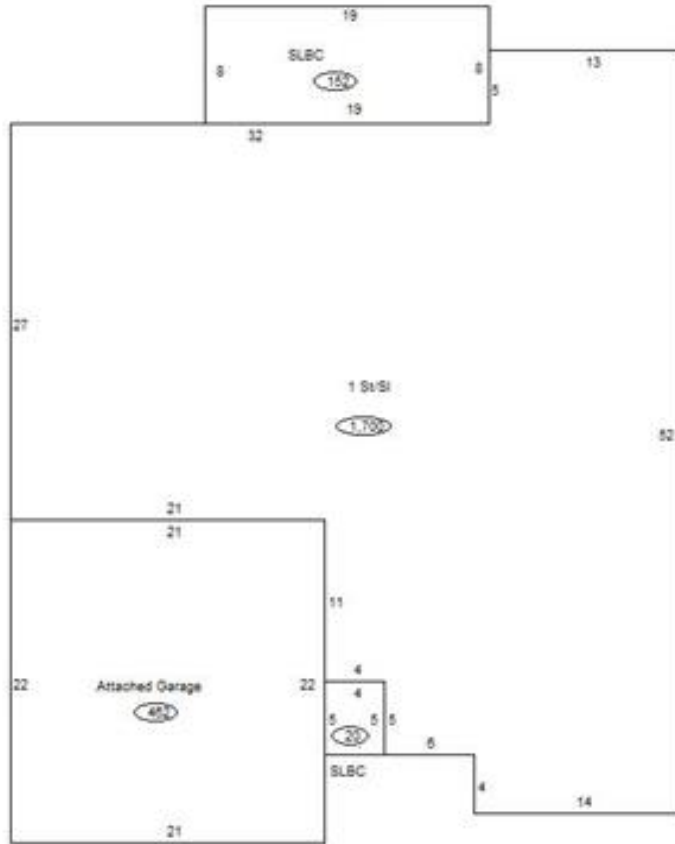

Sketch Vector Information

Sequence	Code	Type	Built Over	Scale	Section Label	Base Area	Multiplier	Total Area
1	R	1	Slab	10	1 St/SI	1,700	1.000	1,700
2	G	1		10	Attached Garage	462	1.000	462
3	M	PRCH		10	SLBC	152	1.000	152
4	M	PRCH		10	SLBC	20	1.000	20
Total Building Area						1,700		1,700