



Rogers

Assessment Property Record Card for Tax Year 2026

Data provided by LISA DELOZIER County Assessor

Date 04/18/2026
 Time 09:49:10
 Page 1

Assessment Data				Primary Image																																																																					
Account 660101968 Parcel ID 00000-00-0-330021-003-0005 Cadastral ID 31-21-15-05220 Property Type REAL - Real Property Property Class RRP VI Area 4 Tax Area 7 - OWASSO/LIMESTONE FIRE Name ID 328119 MORRIS, SAMUEL C & BRITTANY 19551 E SLATE DR OWASSO OK 74055-0000 Parcel Location Situs 19551 E SLATE DR Subdivision BOULDER POINT PHASE I Lot/Block 0005 / 0003 Parcel Size 1 - Lots Sec/Twn/Rng 31 / 21 / 15 / 5 Neighborhood 1074 - R-V01,3,4-SW OWASSO CATOOSA School District S021 - OWASSO SCHOOLS																																																																									
Legal Description Lot/Long: 36.25183646 -95.75559261 LOT 5 BLOCK 3 BOULDER POINT PHASE I										Building Permits <table border="1"> <thead> <tr> <th>Number</th> <th>Description</th> <th>Opened</th> <th>Closed</th> <th>Amount</th> </tr> </thead> <tbody> <tr> <td>R18 000288</td> <td>R20- NEW 2946 SQ FT SFR</td> <td>10/2018</td> <td>07/2019</td> <td>220,000</td> </tr> </tbody> </table>						Number	Description	Opened	Closed	Amount	R18 000288	R20- NEW 2946 SQ FT SFR	10/2018	07/2019	220,000																																																
Number	Description	Opened	Closed	Amount																																																																					
R18 000288	R20- NEW 2946 SQ FT SFR	10/2018	07/2019	220,000																																																																					
Exemptions <table border="1"> <thead> <tr> <th>Code</th> <th>Type</th> <th>Active</th> <th>Maximum</th> <th>Exemption</th> </tr> </thead> <tbody> <tr> <td></td> <td></td> <td></td> <td></td> <td></td> </tr> </tbody> </table>				Code	Type	Active	Maximum	Exemption						Sale History <table border="1"> <thead> <tr> <th>Bk/Pg</th> <th>Grantor</th> <th>Date</th> <th>Price</th> <th>Code</th> </tr> </thead> <tbody> <tr> <td>/</td> <td>EXECUTIVE HOMES LLC</td> <td>07/02/2019</td> <td>419,000</td> <td>YES</td> </tr> <tr> <td>/</td> <td>GREEN PROPERTY MANAGEMENT IN</td> <td>11/28/2018</td> <td>2,236,000</td> <td>WB</td> </tr> </tbody> </table>						Bk/Pg	Grantor	Date	Price	Code	/	EXECUTIVE HOMES LLC	07/02/2019	419,000	YES	/	GREEN PROPERTY MANAGEMENT IN	11/28/2018	2,236,000	WB																																							
Code	Type	Active	Maximum	Exemption																																																																					
Bk/Pg	Grantor	Date	Price	Code																																																																					
/	EXECUTIVE HOMES LLC	07/02/2019	419,000	YES																																																																					
/	GREEN PROPERTY MANAGEMENT IN	11/28/2018	2,236,000	WB																																																																					
Parcel Valuation <table border="1"> <thead> <tr> <th>Source</th> <th>REAL</th> <th>Fair Cash</th> <th>Capped</th> <th>Asmnt Level</th> <th>Assessed</th> <th>Levy Rate</th> <th>108.538</th> <th>Current Tax</th> </tr> </thead> <tbody> <tr> <td>Remove Cap</td> <td>2020</td> <td>Land Value 85,860</td> <td>85,860</td> <td>11%</td> <td>9,445</td> <td>Assessed</td> <td>55,278</td> <td>5,999.76</td> </tr> <tr> <td>Year Frozen</td> <td></td> <td>Improvements 416,665</td> <td>416,665</td> <td></td> <td>45,833</td> <td>Penalty</td> <td>0</td> <td></td> </tr> <tr> <td>Uncapped Value</td> <td>0</td> <td>Mobile Home 0</td> <td>0</td> <td></td> <td>0</td> <td>Exemption</td> <td>0</td> <td>0.00</td> </tr> <tr> <td>TIF Project ID</td> <td>0</td> <td>Total Value 502,525</td> <td>502,525</td> <td></td> <td>55,278</td> <td>Total Taxable</td> <td>55,278</td> <td>6,000.00</td> </tr> </tbody> </table>										Source	REAL	Fair Cash	Capped	Asmnt Level	Assessed	Levy Rate	108.538	Current Tax	Remove Cap	2020	Land Value 85,860	85,860	11%	9,445	Assessed	55,278	5,999.76	Year Frozen		Improvements 416,665	416,665		45,833	Penalty	0		Uncapped Value	0	Mobile Home 0	0		0	Exemption	0	0.00	TIF Project ID	0	Total Value 502,525	502,525		55,278	Total Taxable	55,278	6,000.00																			
Source	REAL	Fair Cash	Capped	Asmnt Level	Assessed	Levy Rate	108.538	Current Tax																																																																	
Remove Cap	2020	Land Value 85,860	85,860	11%	9,445	Assessed	55,278	5,999.76																																																																	
Year Frozen		Improvements 416,665	416,665		45,833	Penalty	0																																																																		
Uncapped Value	0	Mobile Home 0	0		0	Exemption	0	0.00																																																																	
TIF Project ID	0	Total Value 502,525	502,525		55,278	Total Taxable	55,278	6,000.00																																																																	
Assessment History <table border="1"> <thead> <tr> <th>Tax Year</th> <th>Statement Number</th> <th>Billed Owner</th> <th>Tax Area</th> <th>Total Value</th> <th>Exemptions</th> <th>Taxable Value</th> <th>Billed Tax</th> </tr> </thead> <tbody> <tr> <td>2025</td> <td>2025-660101968</td> <td>MORRIS, SAMUEL C &</td> <td>7</td> <td>490,430</td> <td>0</td> <td>53,948</td> <td>5,856.00</td> </tr> <tr> <td>2024</td> <td>2024-660101968</td> <td>MORRIS, SAMUEL C &</td> <td>7</td> <td>521,507</td> <td>0</td> <td>51,848</td> <td>5,721.00</td> </tr> <tr> <td>2023</td> <td>2023-660101968</td> <td>MORRIS, SAMUEL C &</td> <td>7</td> <td>448,900</td> <td>0</td> <td>49,379</td> <td>5,332.00</td> </tr> <tr> <td>2022</td> <td>2022-660101968</td> <td>MORRIS, SAMUEL C &</td> <td>7</td> <td>432,974</td> <td>0</td> <td>47,627</td> <td>5,346.00</td> </tr> <tr> <td>2021</td> <td>2021-660101968</td> <td>MORRIS, SAMUEL C &</td> <td>7</td> <td>428,009</td> <td>0</td> <td>47,081</td> <td>5,227.00</td> </tr> <tr> <td>2020</td> <td>2020-660101968</td> <td>MORRIS, SAMUEL C &</td> <td>7</td> <td>418,962</td> <td>0</td> <td>46,086</td> <td>5,110.00</td> </tr> <tr> <td>2019</td> <td>2019-660101968</td> <td>MORRIS, SAMUEL C &</td> <td>7</td> <td>57,000</td> <td>0</td> <td>6,270</td> <td>696.00</td> </tr> </tbody> </table>										Tax Year	Statement Number	Billed Owner	Tax Area	Total Value	Exemptions	Taxable Value	Billed Tax	2025	2025-660101968	MORRIS, SAMUEL C &	7	490,430	0	53,948	5,856.00	2024	2024-660101968	MORRIS, SAMUEL C &	7	521,507	0	51,848	5,721.00	2023	2023-660101968	MORRIS, SAMUEL C &	7	448,900	0	49,379	5,332.00	2022	2022-660101968	MORRIS, SAMUEL C &	7	432,974	0	47,627	5,346.00	2021	2021-660101968	MORRIS, SAMUEL C &	7	428,009	0	47,081	5,227.00	2020	2020-660101968	MORRIS, SAMUEL C &	7	418,962	0	46,086	5,110.00	2019	2019-660101968	MORRIS, SAMUEL C &	7	57,000	0	6,270	696.00
Tax Year	Statement Number	Billed Owner	Tax Area	Total Value	Exemptions	Taxable Value	Billed Tax																																																																		
2025	2025-660101968	MORRIS, SAMUEL C &	7	490,430	0	53,948	5,856.00																																																																		
2024	2024-660101968	MORRIS, SAMUEL C &	7	521,507	0	51,848	5,721.00																																																																		
2023	2023-660101968	MORRIS, SAMUEL C &	7	448,900	0	49,379	5,332.00																																																																		
2022	2022-660101968	MORRIS, SAMUEL C &	7	432,974	0	47,627	5,346.00																																																																		
2021	2021-660101968	MORRIS, SAMUEL C &	7	428,009	0	47,081	5,227.00																																																																		
2020	2020-660101968	MORRIS, SAMUEL C &	7	418,962	0	46,086	5,110.00																																																																		
2019	2019-660101968	MORRIS, SAMUEL C &	7	57,000	0	6,270	696.00																																																																		



Rogers

Assessment Property Record Card for Tax Year 2026

Data provided by LISA DELOZIER County Assessor

Date 04/18/2026
Time 09:49:10
Page 2

Lot Data		Square-Foot - NBHD 1074 #1	
Lot Size	0	0	
Lot Count	1		
Units Buildable			
Non-Ag Acres	0.657		
Topography			
Street Access			
Utilities			
Amenities	LAND QUALITY		0
	LAND USE		0
Method	Square-Foot		
Base Lot Value	28,620.00 x 3.00 = 85,860		
Factor Value			
Adjustments	1.0000		
Lot Value	85,860		



\\tsclient\C\Users\Randy Necessary\Pictures\101_0628\IMG_0082. 6/30/2022

Residential Data	
Type	1 Single Family Residence
Condition	3 - Average
Quality	3.5 - Average
Architecture	
Style	100% One Story
Exterior Wall	100% Veneer, Masonry
Base/Total Area	3,054 / 3,054
Style	100% One Story
HVAC	100% Warmed & Cooled Air
Roof Cover	1 Composition Shingle
Area on Slab	3,054
Fixture/RghIn	22 /
Bed/F/H Bath	4 / 2.0 / 1.0
Basement Area	
Garage Type	665 Attached Garage - Unfinished
Remodel	
Year/Eff Age	2016 / 8

GRM Approach	
GRM Code	
Gross Rent	0.00
Indicated Value	

Multiple Regression			
MRA Code	1	Test	
Adjusted R	0.8445		
Indicated Value	395,073	129.36	Per SqFt

Direct Comparables			
Selection Model	A	Adam Test	
Adjustment Model	1	2022 Residential	
Comparables	7		
Indicated Value	537,160		Per SqFt

Cost Approach		Manual : 01/2025	
Base Cost	104.91	Total Misc Impr	+ 23,205
Roofing Adj	+ 4.99	Garage Cost	+ 25,037
Subfloor Adj	+ -3.21	Total RCN	= 452,897
Heat/Cool Adj	+ 14.47	Depreciation (8%)	- 36,232
Plumbing Adj	+ 11.34	Lump Sums	+ 0
Basement Adj	+ 0.00	RCNLD	= 416,665
Adj Base Cost	= 132.50	Lot Value	+ 85,860
Total Area	x 3,054	Indicated Value	= 502,525
Adjusted Cost	= 404,655	Value Per SqFt	164.55

Value Reconciliation			
Selected Approach	Cost Approach		
Improvements	416,665		
Lot Value	85,860		
Indicated Value	502,525	164.55	Per SqFt
Agland Value			
Site Improvements			
Total Value	502,525	164.55	Total Value Per SqFt

Miscellaneous Improvements								
Code	Description	Sketch ID	Size	Year	Units	Unit Cost	Depr	Value
PRCH	SLAB PORCH - COVERED	141478	8x4		32	29.43		942
PRCH	SLAB PORCH - COVERED	141479	572		572	27.68		15,833
FPR1	FIREPLACE - RESIDENTIAL 1 STORY		1		1	6,429.63		6,430



Rogers

Assessment Property Record Card for Tax Year 2026

Data provided by LISA DELOZIER County Assessor

Date 04/18/2026
 Time 09:49:10
 Page 3

Sketch Image

660101968

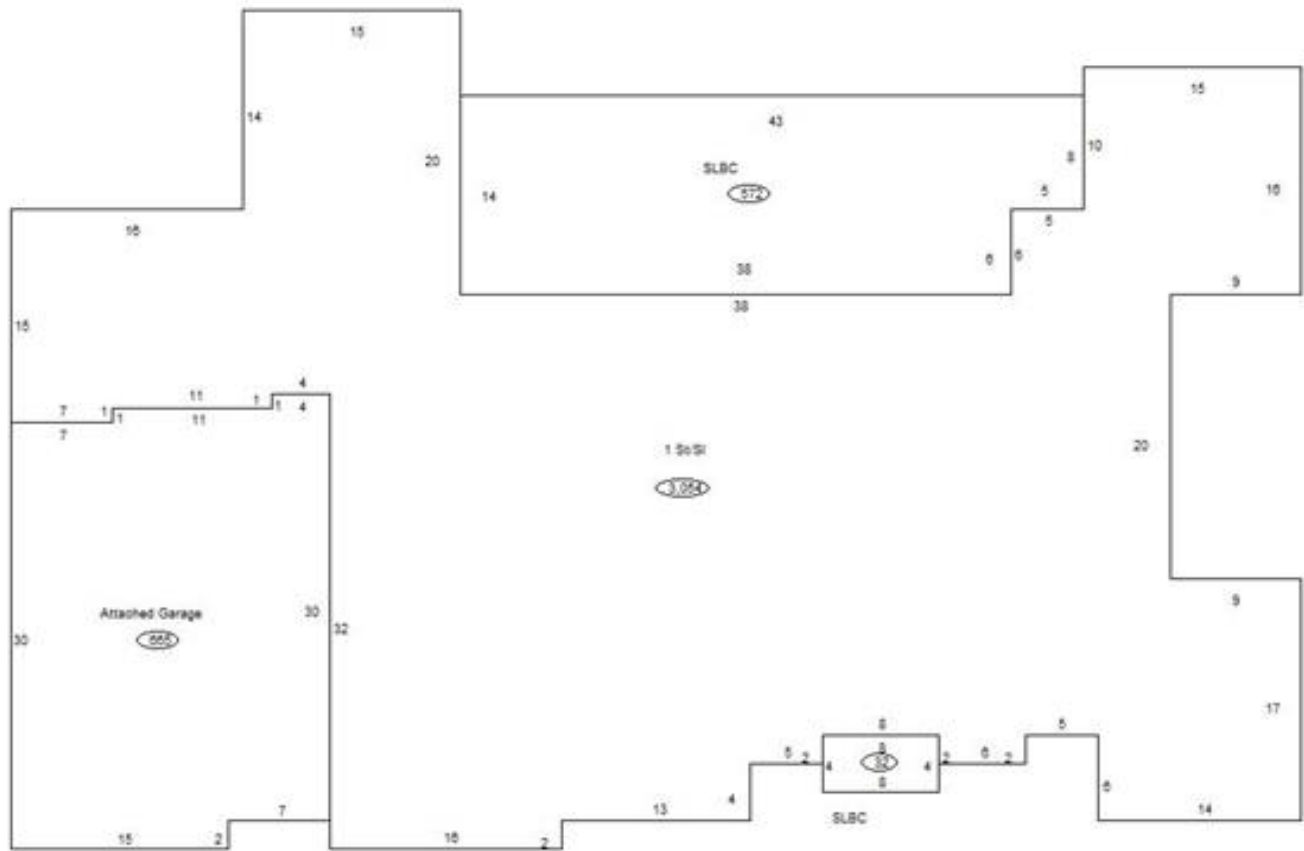

Sketch Vector Information

Sequence	Code	Type	Built Over	Scale	Section Label	Base Area	Multiplier	Total Area
1	R	1	Slab	10	1 St/SI	3,054	1.000	3,054
2	G	1		10	Attached Garage	665	1.000	665
3	M	PRCH		10	SLBC	32	1.000	32
4	M	PRCH		10	SLBC	572	1.000	572
Total Building Area						3,054		3,054