



# Rogers

## Assessment Property Record Card for Tax Year 2026

Data provided by LISA DELOZIER County Assessor

Date 04/18/2026  
Time 09:49:15  
Page 1

Assessment Data					Primary Image																																																																				
<b>Account</b> 660101971 <b>Parcel ID</b> 00000-00-0-330021-004-0002 <b>Cadastral ID</b> 31-21-15-05250 <b>Property Type</b> REAL - Real Property <b>Property Class</b> RRP VI Area 4 <b>Tax Area</b> 7 - OWASSO/LIMESTONE FIRE <b>Name ID</b> 330550 LORD, GLENN W & GINA M TRUSTEES LORD LIVING TRUST 19462 E SLATE DR OWASSO OK 74055-0000																																																																									
<b>Parcel Location</b> <b>Situs</b> 19462 E SLATE DR <b>Subdivision</b> BOULDER POINT PHASE I <b>Lot/Block</b> 0002 / 0004 <b>Parcel Size</b> 1 - Lots <b>Sec/Twn/Rng</b> 31 / 21 / 15 / 5 <b>Neighborhood</b> 1074 - R-V01,3,4-SW OWASSO CATOOSA <b>School District</b> S021 - OWASSO SCHOOLS																																																																									
<b>Legal Description</b> Lat/Long: 36.25122722 -95.75675100 LOT 2 BLOCK 4 BOULDER POINT PHASE I					<b>Building Permits</b> <table border="1"> <thead> <tr> <th>Number</th> <th>Description</th> <th>Opened</th> <th>Closed</th> <th>Amount</th> </tr> </thead> <tbody> <tr> <td>R18 000286</td> <td>R21- NEW 3353 SQ FT SFR</td> <td>10/2018</td> <td>05/2020</td> <td>230,000</td> </tr> </tbody> </table>					Number	Description	Opened	Closed	Amount	R18 000286	R21- NEW 3353 SQ FT SFR	10/2018	05/2020	230,000																																																						
Number	Description	Opened	Closed	Amount																																																																					
R18 000286	R21- NEW 3353 SQ FT SFR	10/2018	05/2020	230,000																																																																					
<b>Exemptions</b> <table border="1"> <thead> <tr> <th>Code</th> <th>Type</th> <th>Active</th> <th>Maximum</th> <th>Exemption</th> </tr> </thead> <tbody> <tr> <td>H</td> <td>Homestead</td> <td>Yes</td> <td>1,000</td> <td>1,000</td> </tr> </tbody> </table>					Code	Type	Active	Maximum	Exemption	H	Homestead	Yes	1,000	1,000	<b>Sale History</b> <table border="1"> <thead> <tr> <th>Bk/Pg</th> <th>Grantor</th> <th>Date</th> <th>Price</th> <th>Code</th> </tr> </thead> <tbody> <tr> <td>/</td> <td>EXECUTIVE HOMES LLC</td> <td>04/09/2020</td> <td>449,000</td> <td>YES</td> </tr> <tr> <td>/</td> <td>GREEN PROPERTY MANAGEMENT IN</td> <td>11/28/2018</td> <td>2,236,000</td> <td>WB</td> </tr> </tbody> </table>					Bk/Pg	Grantor	Date	Price	Code	/	EXECUTIVE HOMES LLC	04/09/2020	449,000	YES	/	GREEN PROPERTY MANAGEMENT IN	11/28/2018	2,236,000	WB																																							
Code	Type	Active	Maximum	Exemption																																																																					
H	Homestead	Yes	1,000	1,000																																																																					
Bk/Pg	Grantor	Date	Price	Code																																																																					
/	EXECUTIVE HOMES LLC	04/09/2020	449,000	YES																																																																					
/	GREEN PROPERTY MANAGEMENT IN	11/28/2018	2,236,000	WB																																																																					
<b>Parcel Valuation</b> <table border="1"> <thead> <tr> <th>Source</th> <th>REAL</th> <th>Fair Cash</th> <th>Capped</th> <th>Asmnt Level</th> <th>Assessed</th> <th>Levy Rate</th> <th>108.538</th> <th>Current Tax</th> </tr> </thead> <tbody> <tr> <td>Remove Cap</td> <td>2021</td> <td>Land Value</td> <td>66,858</td> <td>66,858</td> <td>11%</td> <td>7,354</td> <td>Assessed</td> <td>57,599 6,251.68</td> </tr> <tr> <td>Year Frozen</td> <td></td> <td>Improvements</td> <td>483,132</td> <td>456,773</td> <td></td> <td>50,245</td> <td>Penalty</td> <td>0</td> </tr> <tr> <td>Uncapped Value</td> <td>0</td> <td>Mobile Home</td> <td>0</td> <td>0</td> <td>0</td> <td>0</td> <td>Exemption</td> <td>1,000 -98.00</td> </tr> <tr> <td>TIF Project ID</td> <td>0</td> <td>Total Value</td> <td>549,990</td> <td>523,631</td> <td>57,599</td> <td>Total Taxable</td> <td>56,599</td> <td>6,154.00</td> </tr> </tbody> </table>										Source	REAL	Fair Cash	Capped	Asmnt Level	Assessed	Levy Rate	108.538	Current Tax	Remove Cap	2021	Land Value	66,858	66,858	11%	7,354	Assessed	57,599 6,251.68	Year Frozen		Improvements	483,132	456,773		50,245	Penalty	0	Uncapped Value	0	Mobile Home	0	0	0	0	Exemption	1,000 -98.00	TIF Project ID	0	Total Value	549,990	523,631	57,599	Total Taxable	56,599	6,154.00																			
Source	REAL	Fair Cash	Capped	Asmnt Level	Assessed	Levy Rate	108.538	Current Tax																																																																	
Remove Cap	2021	Land Value	66,858	66,858	11%	7,354	Assessed	57,599 6,251.68																																																																	
Year Frozen		Improvements	483,132	456,773		50,245	Penalty	0																																																																	
Uncapped Value	0	Mobile Home	0	0	0	0	Exemption	1,000 -98.00																																																																	
TIF Project ID	0	Total Value	549,990	523,631	57,599	Total Taxable	56,599	6,154.00																																																																	
<b>Assessment History</b> <table border="1"> <thead> <tr> <th>Tax Year</th> <th>Statement Number</th> <th>Billed Owner</th> <th>Tax Area</th> <th>Total Value</th> <th>Exemptions</th> <th>Taxable Value</th> <th>Billed Tax</th> </tr> </thead> <tbody> <tr> <td>2025</td> <td>2025-660101971</td> <td>LORD, GLENN W &amp; GINA M</td> <td>7</td> <td>535,060</td> <td>1000</td> <td>54,921</td> <td>5,972.00</td> </tr> <tr> <td>2024</td> <td>2024-660101971</td> <td>LORD, GLENN W &amp; GINA M</td> <td>7</td> <td>571,990</td> <td>1000</td> <td>53,293</td> <td>5,895.00</td> </tr> <tr> <td>2023</td> <td>2023-660101971</td> <td>LORD, GLENN W &amp; GINA M</td> <td>7</td> <td>546,112</td> <td>1000</td> <td>51,712</td> <td>5,599.00</td> </tr> <tr> <td>2022</td> <td>2022-660101971</td> <td>LORD, GLENN W &amp; GINA M</td> <td>7</td> <td>530,177</td> <td>1000</td> <td>50,177</td> <td>5,647.00</td> </tr> <tr> <td>2021</td> <td>2021-660101971</td> <td>LORD, GLENN W &amp; GINA M</td> <td>7</td> <td>451,691</td> <td>1000</td> <td>48,686</td> <td>5,420.00</td> </tr> <tr> <td>2020</td> <td>2020-660101971</td> <td>LORD, GLENN W &amp; GINA M</td> <td>7</td> <td>57,500</td> <td>0</td> <td>6,325</td> <td>701.00</td> </tr> <tr> <td>2019</td> <td>2019-660101971</td> <td>EXECUTIVE HOMES LLC</td> <td>7</td> <td>57,000</td> <td>0</td> <td>6,270</td> <td>696.00</td> </tr> </tbody> </table>										Tax Year	Statement Number	Billed Owner	Tax Area	Total Value	Exemptions	Taxable Value	Billed Tax	2025	2025-660101971	LORD, GLENN W & GINA M	7	535,060	1000	54,921	5,972.00	2024	2024-660101971	LORD, GLENN W & GINA M	7	571,990	1000	53,293	5,895.00	2023	2023-660101971	LORD, GLENN W & GINA M	7	546,112	1000	51,712	5,599.00	2022	2022-660101971	LORD, GLENN W & GINA M	7	530,177	1000	50,177	5,647.00	2021	2021-660101971	LORD, GLENN W & GINA M	7	451,691	1000	48,686	5,420.00	2020	2020-660101971	LORD, GLENN W & GINA M	7	57,500	0	6,325	701.00	2019	2019-660101971	EXECUTIVE HOMES LLC	7	57,000	0	6,270	696.00
Tax Year	Statement Number	Billed Owner	Tax Area	Total Value	Exemptions	Taxable Value	Billed Tax																																																																		
2025	2025-660101971	LORD, GLENN W & GINA M	7	535,060	1000	54,921	5,972.00																																																																		
2024	2024-660101971	LORD, GLENN W & GINA M	7	571,990	1000	53,293	5,895.00																																																																		
2023	2023-660101971	LORD, GLENN W & GINA M	7	546,112	1000	51,712	5,599.00																																																																		
2022	2022-660101971	LORD, GLENN W & GINA M	7	530,177	1000	50,177	5,647.00																																																																		
2021	2021-660101971	LORD, GLENN W & GINA M	7	451,691	1000	48,686	5,420.00																																																																		
2020	2020-660101971	LORD, GLENN W & GINA M	7	57,500	0	6,325	701.00																																																																		
2019	2019-660101971	EXECUTIVE HOMES LLC	7	57,000	0	6,270	696.00																																																																		



# Rogers

## Assessment Property Record Card for Tax Year 2026

Data provided by LISA DELOZIER County Assessor

Date 04/18/2026  
Time 09:49:15  
Page 2

Lot Data		Square-Foot - NBHD 1074 #1	
Lot Size	0	0	
Lot Count	1		
Units Buildable			
Non-Ag Acres	0.5116		
Topography			
Street Access			
Utilities			
Amenities	LAND QUALITY		0
	LAND USE		0
Method	Square-Foot		
Base Lot Value	22,286.00 x 3.00 = 66,858		
Factor Value			
Adjustments	1.0000		
Lot Value	66,858		



\\tsclient\C\Users\Randy Necessary\Pictures\101\_0628\IMG\_0088. 6/30/2022

Residential Data	
Type	1 Single Family Residence
Condition	3 - Average
Quality	3.5 - Average
Architecture	EXEC EXCEPTIONAL
Style	100% 1 1/2 Story Finished
Exterior Wall	95% Veneer, Masonry 5% Veneer, Stone
Base/Total Area	2,716 / 3,185
Style	100% 1 1/2 Story Finished
HVAC	100% Warmed & Cooled Air
Roof Cover	1 Composition Shingle
Area on Slab	2,716
Fixture/RghIn	16 /
Bed/F/H Bath	5 / 3.0 / 1.0
Basement Area	
Garage Type	693 Attached Garage - Unfinished
Remodel	
Year/Eff Age	2020 / 5

GRM Approach	
GRM Code	
Gross Rent	0.00
Indicated Value	

Multiple Regression			
MRA Code	1	Test	
Adjusted R	0.8445		
Indicated Value	418,006	131.24	Per SqFt

Direct Comparables			
Selection Model	A	Adam Test	
Adjustment Model	1	2022 Residential	
Comparables	1		
Indicated Value	171,700		Per SqFt

Cost Approach		Manual : 01/2025	
Base Cost	121.99	Total Misc Impr	+ 17,643
Roofing Adj	+ 4.34	Garage Cost	+ 25,939
Subfloor Adj	+ -2.79	Total RCN	= 508,560
Heat/Cool Adj	+ 14.47	Depreciation ( 5%)	- 25,428
Plumbing Adj	+ 7.98	Lump Sums	+ 0
Basement Adj	+ 0.00	RCNLD	= 483,132
Adj Base Cost	= 145.99	Lot Value	+ 66,858
Total Area	x 3,185	Indicated Value	= 549,990
Adjusted Cost	= 464,978	Value Per SqFt	172.68

Value Reconciliation			
Selected Approach	Cost Approach		
Improvements	483,132		
Lot Value	66,858		
Indicated Value	549,990	172.68	Per SqFt
Agland Value			
Site Improvements			
Total Value	549,990	172.68	Total Value Per SqFt

Miscellaneous Improvements								
Code	Description	Sketch ID	Size	Year	Units	Unit Cost	Depr	Value
PRCH	SLAB PORCH - COVERED	145592	22x15		330	28.38		9,365
PRCH	SLAB PORCH - COVERED	145593	9x7		63	29.33		1,848
FPR1	FIREPLACE - RESIDENTIAL 1 STORY			1	1	6,429.63		6,430



# Rogers

## Assessment Property Record Card for Tax Year 2026

Data provided by LISA DELOZIER County Assessor

Date 04/18/2026  
 Time 09:49:15  
 Page 3

Sketch Image

660101971

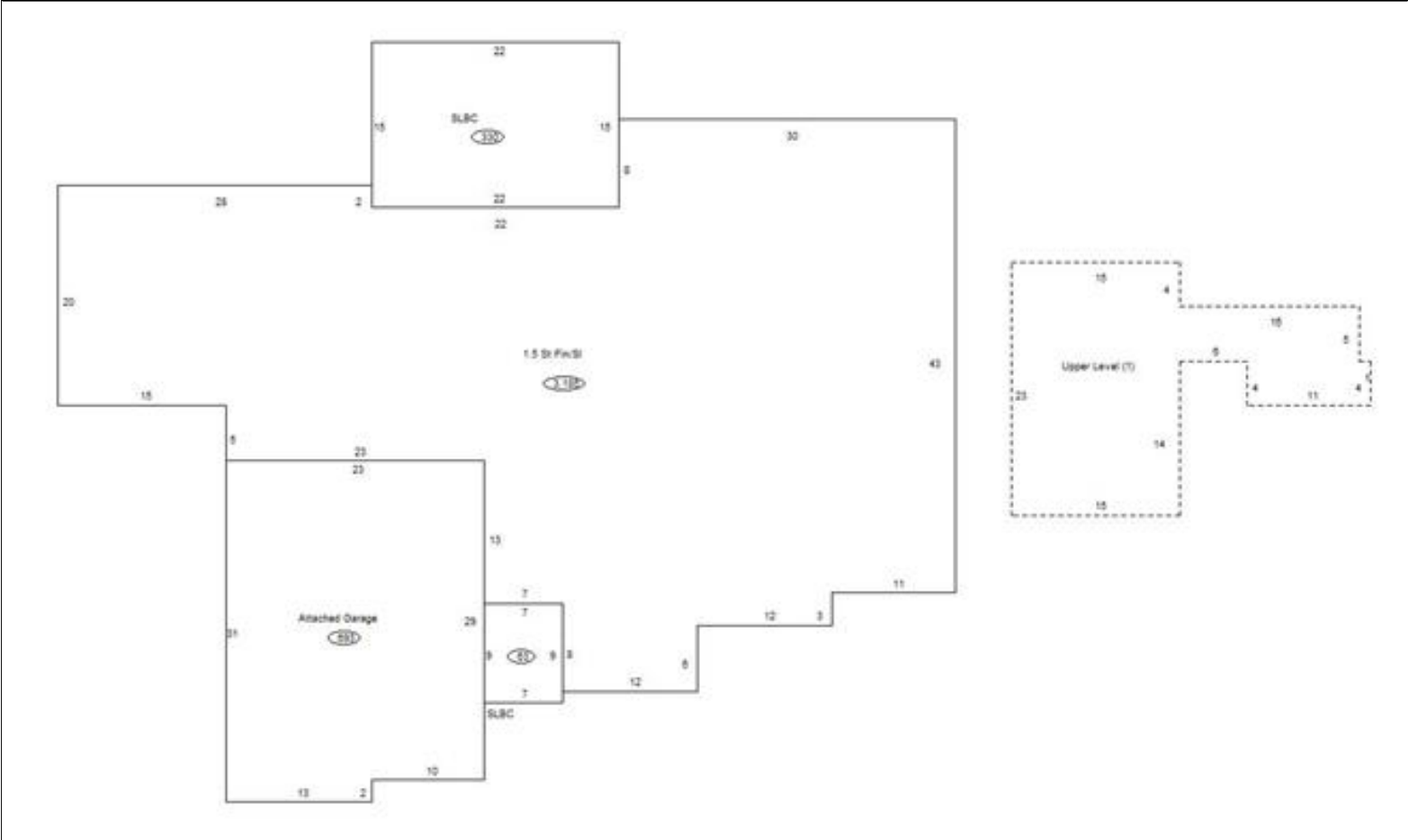

### Sketch Vector Information

Sequence	Code	Type	Built Over	Scale	Section Label	Base Area	Multiplier	Total Area
1	R	5	Slab	10	1.5 St Fin/SI	2,716	1.173	3,185
2	U	^UL		10	Upper Level (1)	469	1.000	469
3	G	1		10	Attached Garage	693	1.000	693
4	M	PRCH		10	SLBC	330	1.000	330
5	M	PRCH		10	SLBC	63	1.000	63
<b>Total Building Area</b>						<b>2,716</b>		<b>3,185</b>