



Rogers

Assessment Property Record Card for Tax Year 2026

Data provided by LISA DELOZIER County Assessor

Date 04/18/2026
Time 09:50:07
Page 1

Assessment Data					Primary Image																																																																				
Account 660101999 Parcel ID 00000-00-0-330021-008-0013 Cadastral ID 31-21-15-05530 Property Type REAL - Real Property Property Class RRP VI Area 4 Tax Area 7 - OWASSO/LIMESTONE FIRE Name ID 331769 PRIMEAUX, TRAVIS & TIFFANIE M CHERRY PRIMEAUX 6641 N GRANITE LN OWASSO OK 74055-0000 Parcel Location Situs 06641 N GRANITE LN Subdivision BOULDER POINT PHASE I Lot/Block 0013 / 0008 Parcel Size 1 - Lots Sec/Twn/Rng 31 / 21 / 15 / 5 Neighborhood 1074 - R-V01,3,4-SW OWASSO CATOOSA School District S021 - OWASSO SCHOOLS																																																																									
Legal Description Lot/Long: 36.25029253 -95.75229936																																																																									
Building Permits					<table border="1"> <thead> <tr> <th>Number</th> <th>Description</th> <th>Opened</th> <th>Closed</th> <th>Amount</th> </tr> </thead> <tbody> <tr> <td>R19 00433</td> <td>R21- NEW 2810 SQ FT SFR</td> <td>12/2019</td> <td>10/2020</td> <td>220,000</td> </tr> </tbody> </table>					Number	Description	Opened	Closed	Amount	R19 00433	R21- NEW 2810 SQ FT SFR	12/2019	10/2020	220,000																																																						
Number	Description	Opened	Closed	Amount																																																																					
R19 00433	R21- NEW 2810 SQ FT SFR	12/2019	10/2020	220,000																																																																					
Exemptions					Sale History																																																																				
<table border="1"> <thead> <tr> <th>Code</th> <th>Type</th> <th>Active</th> <th>Maximum</th> <th>Exemption</th> </tr> </thead> <tbody> <tr> <td>H</td> <td>Homestead</td> <td>Yes</td> <td>1,000</td> <td>1,000</td> </tr> </tbody> </table>					Code	Type	Active	Maximum	Exemption	H	Homestead	Yes	1,000	1,000	<table border="1"> <thead> <tr> <th>Bk/Pg</th> <th>Grantor</th> <th>Date</th> <th>Price</th> <th>Code</th> </tr> </thead> <tbody> <tr> <td>/</td> <td>EXECUTIVE HOMES LLC</td> <td>08/28/2020</td> <td>403,500</td> <td>YES</td> </tr> <tr> <td>/</td> <td>GREEN PROPERTY MANAGEMENT IN</td> <td>11/28/2018</td> <td>2,236,000</td> <td>WB</td> </tr> </tbody> </table>					Bk/Pg	Grantor	Date	Price	Code	/	EXECUTIVE HOMES LLC	08/28/2020	403,500	YES	/	GREEN PROPERTY MANAGEMENT IN	11/28/2018	2,236,000	WB																																							
Code	Type	Active	Maximum	Exemption																																																																					
H	Homestead	Yes	1,000	1,000																																																																					
Bk/Pg	Grantor	Date	Price	Code																																																																					
/	EXECUTIVE HOMES LLC	08/28/2020	403,500	YES																																																																					
/	GREEN PROPERTY MANAGEMENT IN	11/28/2018	2,236,000	WB																																																																					
Parcel Valuation																																																																									
<table border="1"> <thead> <tr> <th>Source</th> <th>REAL</th> </tr> </thead> <tbody> <tr> <td>Remove Cap</td> <td>2021</td> </tr> </tbody> </table>		Source	REAL	Remove Cap	2021	<table border="1"> <thead> <tr> <th>Fair Cash</th> <th>Capped</th> </tr> </thead> <tbody> <tr> <td>Land Value</td> <td>82,482</td> </tr> <tr> <td>Improvements</td> <td>402,916</td> </tr> <tr> <td>Mobile Home</td> <td>0</td> </tr> <tr> <td>Total Value</td> <td>485,398</td> </tr> </tbody> </table>		Fair Cash	Capped	Land Value	82,482	Improvements	402,916	Mobile Home	0	Total Value	485,398	<table border="1"> <thead> <tr> <th>Asmnt Level</th> <th>Assessed</th> </tr> </thead> <tbody> <tr> <td>11%</td> <td>8,538</td> </tr> <tr> <td></td> <td>43,688</td> </tr> <tr> <td></td> <td>0</td> </tr> <tr> <td></td> <td>52,226</td> </tr> </tbody> </table>		Asmnt Level	Assessed	11%	8,538		43,688		0		52,226	<table border="1"> <thead> <tr> <th>Levy Rate</th> <th>Current Tax</th> </tr> </thead> <tbody> <tr> <td>108.538</td> <td>5,668.51</td> </tr> <tr> <td></td> <td>0</td> </tr> <tr> <td></td> <td>1,000</td> </tr> <tr> <td></td> <td>51,226</td> </tr> </tbody> </table>		Levy Rate	Current Tax	108.538	5,668.51		0		1,000		51,226																																
Source	REAL																																																																								
Remove Cap	2021																																																																								
Fair Cash	Capped																																																																								
Land Value	82,482																																																																								
Improvements	402,916																																																																								
Mobile Home	0																																																																								
Total Value	485,398																																																																								
Asmnt Level	Assessed																																																																								
11%	8,538																																																																								
	43,688																																																																								
	0																																																																								
	52,226																																																																								
Levy Rate	Current Tax																																																																								
108.538	5,668.51																																																																								
	0																																																																								
	1,000																																																																								
	51,226																																																																								
Assessment History																																																																									
<table border="1"> <thead> <tr> <th>Tax Year</th> <th>Statement Number</th> <th>Billed Owner</th> <th>Tax Area</th> <th>Total Value</th> <th>Exemptions</th> <th>Taxable Value</th> <th>Billed Tax</th> </tr> </thead> <tbody> <tr> <td>2025</td> <td>2025-660101999</td> <td>PRIMEAUX, TRAVIS &</td> <td>7</td> <td>472,688</td> <td>1000</td> <td>49,704</td> <td>5,405.00</td> </tr> <tr> <td>2024</td> <td>2024-660101999</td> <td>PRIMEAUX, TRAVIS &</td> <td>7</td> <td>505,363</td> <td>1000</td> <td>48,228</td> <td>5,336.00</td> </tr> <tr> <td>2023</td> <td>2023-660101999</td> <td>PRIMEAUX, TRAVIS &</td> <td>7</td> <td>450,658</td> <td>1000</td> <td>46,794</td> <td>5,067.00</td> </tr> <tr> <td>2022</td> <td>2022-660101999</td> <td>PRIMEAUX, TRAVIS &</td> <td>7</td> <td>430,428</td> <td>1000</td> <td>45,402</td> <td>5,111.00</td> </tr> <tr> <td>2021</td> <td>2021-660101999</td> <td>PRIMEAUX, TRAVIS &</td> <td>7</td> <td>409,552</td> <td>1000</td> <td>44,051</td> <td>4,904.00</td> </tr> <tr> <td>2020</td> <td>2020-660101999</td> <td>PRIMEAUX, TRAVIS &</td> <td>7</td> <td>62,500</td> <td>0</td> <td>6,584</td> <td>730.00</td> </tr> <tr> <td>2019</td> <td>2019-660101999</td> <td>EXECUTIVE HOMES LLC</td> <td>7</td> <td>57,000</td> <td>0</td> <td>6,270</td> <td>696.00</td> </tr> </tbody> </table>										Tax Year	Statement Number	Billed Owner	Tax Area	Total Value	Exemptions	Taxable Value	Billed Tax	2025	2025-660101999	PRIMEAUX, TRAVIS &	7	472,688	1000	49,704	5,405.00	2024	2024-660101999	PRIMEAUX, TRAVIS &	7	505,363	1000	48,228	5,336.00	2023	2023-660101999	PRIMEAUX, TRAVIS &	7	450,658	1000	46,794	5,067.00	2022	2022-660101999	PRIMEAUX, TRAVIS &	7	430,428	1000	45,402	5,111.00	2021	2021-660101999	PRIMEAUX, TRAVIS &	7	409,552	1000	44,051	4,904.00	2020	2020-660101999	PRIMEAUX, TRAVIS &	7	62,500	0	6,584	730.00	2019	2019-660101999	EXECUTIVE HOMES LLC	7	57,000	0	6,270	696.00
Tax Year	Statement Number	Billed Owner	Tax Area	Total Value	Exemptions	Taxable Value	Billed Tax																																																																		
2025	2025-660101999	PRIMEAUX, TRAVIS &	7	472,688	1000	49,704	5,405.00																																																																		
2024	2024-660101999	PRIMEAUX, TRAVIS &	7	505,363	1000	48,228	5,336.00																																																																		
2023	2023-660101999	PRIMEAUX, TRAVIS &	7	450,658	1000	46,794	5,067.00																																																																		
2022	2022-660101999	PRIMEAUX, TRAVIS &	7	430,428	1000	45,402	5,111.00																																																																		
2021	2021-660101999	PRIMEAUX, TRAVIS &	7	409,552	1000	44,051	4,904.00																																																																		
2020	2020-660101999	PRIMEAUX, TRAVIS &	7	62,500	0	6,584	730.00																																																																		
2019	2019-660101999	EXECUTIVE HOMES LLC	7	57,000	0	6,270	696.00																																																																		



Rogers

Assessment Property Record Card for Tax Year 2026

Data provided by LISA DELOZIER County Assessor

Date 04/18/2026
 Time 09:50:07
 Page 2

Lot Data		Square-Foot - NBHD 1074 #1	
Lot Size	0	0	
Lot Count	1		
Units Buildable			
Non-Ag Acres	0.6312		
Topography			
Street Access			
Utilities			
Amenities	LAND QUALITY		0
	LAND USE		0
Method	Square-Foot		
Base Lot Value	27,494.00 x 3.00 = 82,482		
Factor Value			
Adjustments	1.0000		
Lot Value	82,482		



\\tsclient\C\Users\Randy Necessary\Pictures\101_0629\IMG_0020. 6/30/2022

Residential Data	
Type	1 Single Family Residence
Condition	3 - Average
Quality	3.5 - Average
Architecture	
Style	100% One Story
Exterior Wall	100% Veneer, Masonry
Base/Total Area	2,973 / 2,973
Style	100% One Story
HVAC	100% Warmed & Cooled Air
Roof Cover	1 Composition Shingle
Area on Slab	2,973
Fixture/RghIn	11 /
Bed/F/H Bath	4 / 2.0 / 1.0
Basement Area	
Garage Type	877 Attached Garage - Unfinished
Remodel	
Year/Eff Age	2020 / 5

GRM Approach

GRM Code	
Gross Rent	0.00
Indicated Value	

Multiple Regression

MRA Code	1	Test
Adjusted R	0.8445	
Indicated Value	416,243	140.01 Per SqFt

Direct Comparables

Selection Model	A	Adam Test
Adjustment Model	1	2022 Residential
Comparables	1	
Indicated Value	228,920	Per SqFt

Value Reconciliation

Selected Approach	Cost Approach		
Improvements	402,916		
Lot Value	82,482		
Indicated Value	485,398	163.27	Per SqFt
Agland Value			
Site Improvements			
Total Value	485,398	163.27	Total Value Per SqFt

Cost Approach		Manual : 01/2025	
Base Cost	105.35	Total Misc Impr	+ 12,134
Roofing Adj	+ 5.02	Garage Cost	+ 32,633
Subfloor Adj	+ -3.22	Total RCN	= 424,122
Heat/Cool Adj	+ 14.47	Depreciation (5%)	- 21,206
Plumbing Adj	+ 5.98	Lump Sums	+ 0
Basement Adj	+ 0.00	RCNLD	= 402,916
Adj Base Cost	= 127.60	Lot Value	+ 82,482
Total Area	x 2,973	Indicated Value	= 485,398
Adjusted Cost	= 379,355	Value Per SqFt	163.27

Miscellaneous Improvements

Code	Description	Sketch ID	Size	Year	Units	Unit Cost	Depr	Value
PRCH	SLAB PORCH - COVERED	147716	20x19		380	28.22		10,724
PRCH	SLAB PORCH - COVERED	147717	8x6		48	29.38		1,410



Rogers

Assessment Property Record Card for Tax Year 2026

Data provided by LISA DELOZIER County Assessor

Date 04/18/2026

Time 09:50:07

Page 3

Sketch Image

660101999

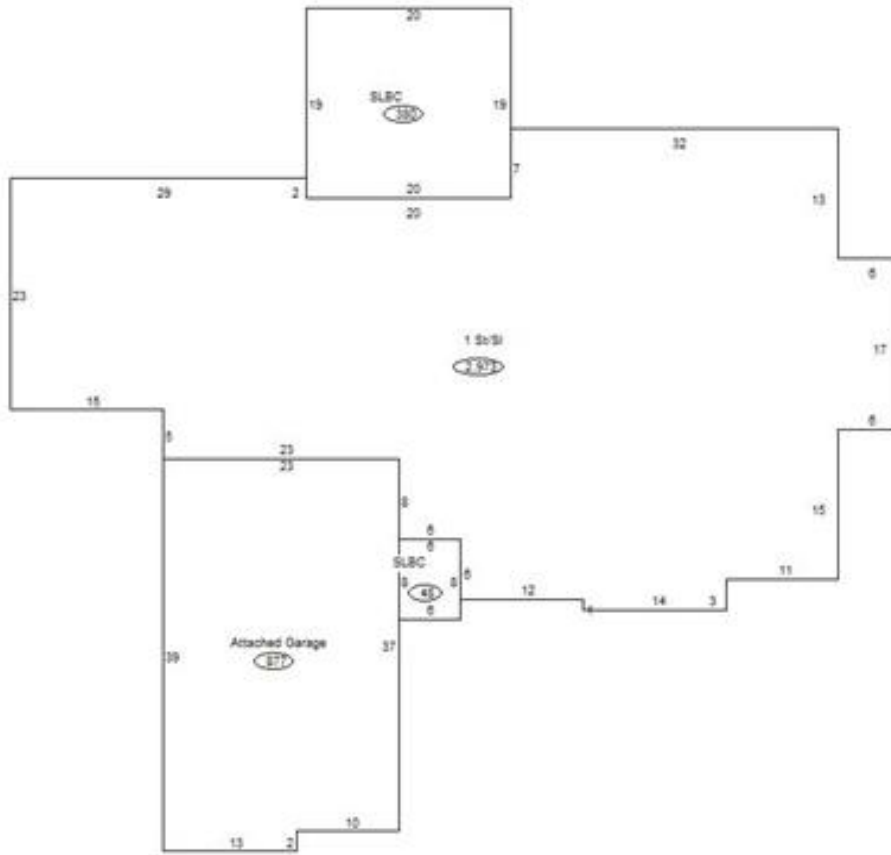

Sketch Vector Information

Sequence	Code	Type	Built Over	Scale	Section Label	Base Area	Multiplier	Total Area
1	R	1	Slab	13	1 St/SI	2,973	1.000	2,973
2	G	1		13	Attached Garage	877	1.000	877
3	M	PRCH		13	SLBC	380	1.000	380
4	M	PRCH		13	SLBC	48	1.000	48
Total Building Area						2,973		2,973