



# Rogers

## Assessment Property Record Card for Tax Year 2026

Data provided by LISA DELOZIER County Assessor

Date 04/18/2026  
 Time 09:52:45  
 Page 1

| Assessment Data                                                                                                                                                                                                                 |                            |                 |              |             | Primary Image |               |               |                 |        |  |  |  |  |  |
|---------------------------------------------------------------------------------------------------------------------------------------------------------------------------------------------------------------------------------|----------------------------|-----------------|--------------|-------------|---------------|---------------|---------------|-----------------|--------|--|--|--|--|--|
| Account                                                                                                                                                                                                                         | 660102218                  |                 |              |             |               |               |               |                 |        |  |  |  |  |  |
| Parcel ID                                                                                                                                                                                                                       | 22N16E-27-4-00000-001-0000 |                 |              |             |               |               |               |                 |        |  |  |  |  |  |
| Cadastral ID                                                                                                                                                                                                                    | 27-22-16-02611             |                 |              |             |               |               |               |                 |        |  |  |  |  |  |
| Property Type                                                                                                                                                                                                                   | REAL - Real Property       |                 |              |             |               |               |               |                 |        |  |  |  |  |  |
| Property Class                                                                                                                                                                                                                  | RR                         | VI Area         | 1            |             |               |               |               |                 |        |  |  |  |  |  |
| Tax Area                                                                                                                                                                                                                        | 9 - SEQUOYAH/ NO FIRE      |                 |              |             |               |               |               |                 |        |  |  |  |  |  |
| Name ID                                                                                                                                                                                                                         | 332341                     |                 |              |             |               |               |               |                 |        |  |  |  |  |  |
| BREWER, BRENT                                                                                                                                                                                                                   |                            |                 |              |             |               |               |               |                 |        |  |  |  |  |  |
| 17950 S 4168 RD<br>CLAREMORE OK 74017-0000                                                                                                                                                                                      |                            |                 |              |             |               |               |               |                 |        |  |  |  |  |  |
| Parcel Location                                                                                                                                                                                                                 |                            |                 |              |             |               |               |               |                 |        |  |  |  |  |  |
| Situs                                                                                                                                                                                                                           | 17950 S 4168 RD            |                 |              |             |               |               |               |                 |        |  |  |  |  |  |
| Subdivision                                                                                                                                                                                                                     |                            |                 |              |             |               |               |               |                 |        |  |  |  |  |  |
| Lot/Block                                                                                                                                                                                                                       | /                          | Parcel Size     | 1.33 - Acres |             |               |               |               |                 |        |  |  |  |  |  |
| Sec/Twn/Rng                                                                                                                                                                                                                     | 27 / 22 / 16 / 4           |                 |              |             |               |               |               |                 |        |  |  |  |  |  |
| Neighborhood                                                                                                                                                                                                                    | 2116 - UNPLATTED           |                 |              |             |               |               |               |                 |        |  |  |  |  |  |
| School District                                                                                                                                                                                                                 | S006 - SEQUOYAH SCHOOLS    |                 |              |             |               |               |               |                 |        |  |  |  |  |  |
| Legal Description Lat/Long: 36.35104972 -95.58282333                                                                                                                                                                            |                            |                 |              |             |               |               |               |                 |        |  |  |  |  |  |
| S 175' SW SW SE SE                                                                                                                                                                                                              |                            |                 |              |             |               |               |               |                 |        |  |  |  |  |  |
| Building Permits                                                                                                                                                                                                                |                            |                 |              |             |               |               |               |                 |        |  |  |  |  |  |
| <table border="1"> <thead> <tr> <th>Number</th> <th>Description</th> <th>Opened</th> <th>Closed</th> <th>Amount</th> </tr> </thead> <tbody> <tr> <td> </td> <td> </td> <td> </td> <td> </td> <td> </td> </tr> </tbody> </table> |                            |                 |              |             | Number        | Description   | Opened        | Closed          | Amount |  |  |  |  |  |
| Number                                                                                                                                                                                                                          | Description                | Opened          | Closed       | Amount      |               |               |               |                 |        |  |  |  |  |  |
|                                                                                                                                                                                                                                 |                            |                 |              |             |               |               |               |                 |        |  |  |  |  |  |
| Exemptions                                                                                                                                                                                                                      |                            |                 |              |             |               |               |               |                 |        |  |  |  |  |  |
| Code                                                                                                                                                                                                                            | Type                       | Active          | Maximum      | Exemption   |               |               |               |                 |        |  |  |  |  |  |
| H                                                                                                                                                                                                                               | Homestead                  | Yes             | 1,000        | 1,000       |               |               |               |                 |        |  |  |  |  |  |
| Sale History                                                                                                                                                                                                                    |                            |                 |              |             |               |               |               |                 |        |  |  |  |  |  |
| Bk/Pg                                                                                                                                                                                                                           | Grantor                    | Date            | Price        | Code        |               |               |               |                 |        |  |  |  |  |  |
| /                                                                                                                                                                                                                               | WALDEN, JAMIE W            | 09/23/2020      | 156,000      | YES         |               |               |               |                 |        |  |  |  |  |  |
| /                                                                                                                                                                                                                               | TIAWAH HILLS STORAGE LLC   | 11/14/2018      | 150,000      | YES         |               |               |               |                 |        |  |  |  |  |  |
| Parcel Valuation                                                                                                                                                                                                                |                            |                 |              |             |               |               |               |                 |        |  |  |  |  |  |
| Source                                                                                                                                                                                                                          | REAL                       | Fair Cash       | Capped       | Asmnt Level | Assessed      | Levy Rate     | 88.320        | Current Tax     |        |  |  |  |  |  |
| Remove Cap                                                                                                                                                                                                                      | 2021                       | Land Value      | 44,865       | 38,109      | 11%           | 4,192         | Assessed      | 20,494 1,810.03 |        |  |  |  |  |  |
| Year Frozen                                                                                                                                                                                                                     |                            | Improvements    | 174,890      | 148,200     |               | 16,302        | Penalty       | 0               |        |  |  |  |  |  |
| Uncapped Value                                                                                                                                                                                                                  | 0                          | Mobile Home     | 0            | 0           |               | 0             | Exemption     | 1,000 -88.00    |        |  |  |  |  |  |
| TIF Project ID                                                                                                                                                                                                                  | 0                          | Total Value     | 219,755      | 186,309     |               | 20,494        | Total Taxable | 19,494 1,722.00 |        |  |  |  |  |  |
| Assessment History                                                                                                                                                                                                              |                            |                 |              |             |               |               |               |                 |        |  |  |  |  |  |
| Tax Year                                                                                                                                                                                                                        | Statement Number           | Billed Owner    | Tax Area     | Total Value | Exemptions    | Taxable Value | Billed Tax    |                 |        |  |  |  |  |  |
| 2025                                                                                                                                                                                                                            | 2025-660102218             | BREWER, BRENT   | 9            | 210,482     | 1000          | 18,897        | 1,669.00      |                 |        |  |  |  |  |  |
| 2024                                                                                                                                                                                                                            | 2024-660102218             | BREWER, BRENT   | 9            | 222,360     | 1000          | 18,317        | 1,625.00      |                 |        |  |  |  |  |  |
| 2023                                                                                                                                                                                                                            | 2023-660102218             | BREWER, BRENT   | 9            | 186,237     | 1000          | 17,755        | 1,612.00      |                 |        |  |  |  |  |  |
| 2022                                                                                                                                                                                                                            | 2022-660102218             | BREWER, BRENT   | 9            | 187,868     | 1000          | 17,209        | 1,580.00      |                 |        |  |  |  |  |  |
| 2021                                                                                                                                                                                                                            | 2021-660102218             | BREWER, BRENT   | 9            | 160,713     | 1000          | 16,679        | 1,471.00      |                 |        |  |  |  |  |  |
| 2020                                                                                                                                                                                                                            | 2020-660102218             | WALDEN, JAMIE W | 9            | 165,958     | 1000          | 16,246        | 1,479.00      |                 |        |  |  |  |  |  |
| 2019                                                                                                                                                                                                                            | 2019-660102218             | WALDEN, JAMIE W | 9            | 152,213     | 1000          | 15,744        | 1,410.00      |                 |        |  |  |  |  |  |



# Rogers

## Assessment Property Record Card for Tax Year 2026

Data provided by LISA DELOZIER County Assessor

Date 04/18/2026  
 Time 09:52:45  
 Page 2

| Lot Data        |                          | Square-Foot - NBHD 2116 #1 |   |
|-----------------|--------------------------|----------------------------|---|
| Lot Size        |                          |                            |   |
| Lot Count       |                          |                            |   |
| Units Buildable |                          |                            |   |
| Non-Ag Acres    | 1.3409                   |                            |   |
| Topography      |                          |                            |   |
| Street Access   |                          |                            |   |
| Utilities       |                          |                            |   |
| Amenities       | LAND QUALITY             | 0                          | 0 |
| Method          | Square-Foot              |                            |   |
| Base Lot Value  | 58,407.00 x .77 = 44,865 |                            |   |
| Factor Value    |                          |                            |   |
| Adjustments     | 1.0000                   |                            |   |
| Lot Value       | 44,865                   |                            |   |



\\tsclient\T\LOGAN\LOGAN RESIDENTIAL VI\2023-1-20\IMG\_003 1/20/2023

| Residential Data |                                             |
|------------------|---------------------------------------------|
| Type             | 1 Single Family Residence                   |
| Condition        | 3 - Average                                 |
| Quality          | 3 - Average                                 |
| Architecture     |                                             |
| Style            | 100% One Story                              |
| Exterior Wall    | 40% Veneer, Masonry 60% Frame, Siding, Wood |
| Base/Total Area  | 1,243 / 1,243                               |
| Style            | 100% One Story                              |
| HVAC             | 100% Warmed & Cooled Air                    |
| Roof Cover       | 1 Composition Shingle                       |
| Area on Slab     | 1,243                                       |
| Fixture/RghIn    | 10 /                                        |
| Bed/F/H Bath     | 3 / 2.0 /                                   |
| Basement Area    |                                             |
| Garage Type      | 500 Attached Garage - Unfinished            |
| Remodel          |                                             |
| Year/Eff Age     | 2013 / 10                                   |

| GRM Approach    |      |
|-----------------|------|
| GRM Code        |      |
| Gross Rent      | 0.00 |
| Indicated Value |      |

| Multiple Regression |         |        |          |
|---------------------|---------|--------|----------|
| MRA Code            | 1       | Test   |          |
| Adusted R           | 0.8445  |        |          |
| Indicated Value     | 203,831 | 163.98 | Per SqFt |

| Direct Comparables |             |
|--------------------|-------------|
| Selection Model    | A Adam Test |
| Adjustment Model   | NewTest     |
| Comparables        |             |
| Indicated Value    |             |

| Cost Approach |           |                     |   | Manual : 01/2025 |  |
|---------------|-----------|---------------------|---|------------------|--|
| Base Cost     | 113.37    | Total Misc Impr     | + | 4,161            |  |
| Roofing Adj   | + 5.19    | Garage Cost         | + | 15,930           |  |
| Subfloor Adj  | + -2.43   | Total RCN           | = | 194,322          |  |
| Heat/Cool Adj | + 12.64   | Depreciation ( 10%) | - | 19,432           |  |
| Plumbing Adj  | + 11.40   | Lump Sums           | + | 0                |  |
| Basement Adj  | + 0.00    | RCNLD               | = | 174,890          |  |
| Adj Base Cost | = 140.17  | Lot Value           | + | 44,865           |  |
| Total Area    | x 1,243   | Indicated Value     | = | 219,755          |  |
| Adjusted Cost | = 174,231 | Value Per SqFt      |   | 176.79           |  |

| Value Reconciliation |               |        |                      |
|----------------------|---------------|--------|----------------------|
| Selected Approach    | Cost Approach |        |                      |
| Improvements         | 174,890       |        |                      |
| Lot Value            | 44,865        |        |                      |
| Indicated Value      | 219,755       | 176.79 | Per SqFt             |
| Agland Value         |               |        |                      |
| Site Improvements    |               |        |                      |
| Total Value          | 219,755       | 176.79 | Total Value Per SqFt |

| Miscellaneous Improvements |                      |           |      |      |       |           |      |       |
|----------------------------|----------------------|-----------|------|------|-------|-----------|------|-------|
| Code                       | Description          | Sketch ID | Size | Year | Units | Unit Cost | Depr | Value |
| PRCH                       | SLAB PORCH - COVERED | 117565    | 72   |      | 72    | 26.70     |      | 1,922 |
| PRCH                       | SLAB PORCH - COVERED | 117566    | 14x6 |      | 84    | 26.66     |      | 2,239 |



# Rogers

## Assessment Property Record Card for Tax Year 2026

Data provided by LISA DELOZIER County Assessor

Date 04/18/2026  
 Time 09:52:45  
 Page 3

Sketch Image

660102218

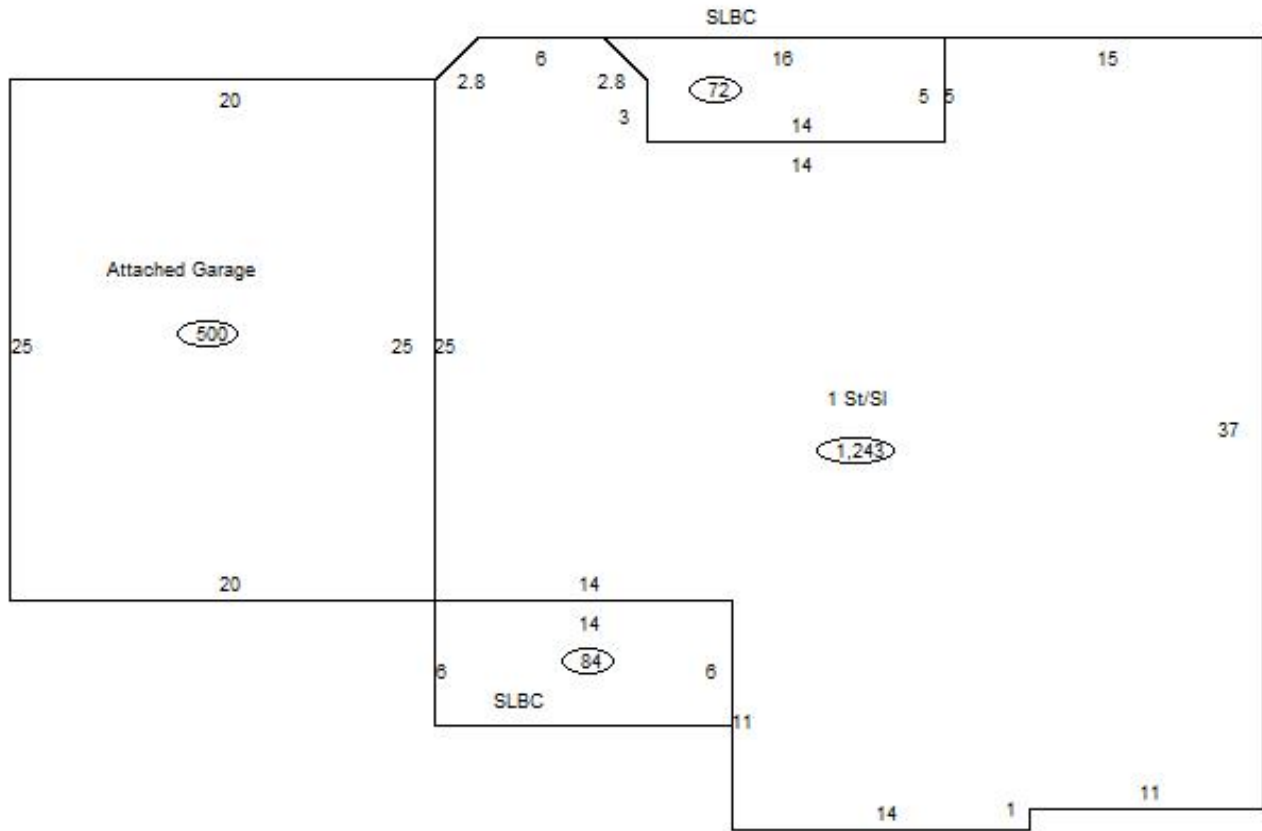

### Sketch Vector Information

| Sequence                   | Code | Type | Built Over | Scale | Section Label   | Base Area | Multiplier | Total Area |
|----------------------------|------|------|------------|-------|-----------------|-----------|------------|------------|
| 1                          | R    | 1    | Slab       | 10    | 1 St/SI         | 1,243     | 1.000      | 1,243      |
| 2                          | G    | 1    |            | 10    | Attached Garage | 500       | 1.000      | 500        |
| 3                          | M    | PRCH |            | 10    | SLBC            | 72        | 1.000      | 72         |
| 4                          | M    | PRCH |            | 10    | SLBC            | 84        | 1.000      | 84         |
| <b>Total Building Area</b> |      |      |            |       |                 | 1,243     |            | 1,243      |