



# Rogers

## Assessment Property Record Card for Tax Year 2026

Data provided by LISA DELOZIER County Assessor

Date 04/18/2026  
 Time 09:56:04  
 Page 1

Assessment Data				Primary Image																																																																					
<b>Account</b> 660102449 <b>Parcel ID</b> 000000-00-0-00159-002-0016 <b>Cadastral ID</b> 12-21-17-02051 <b>Property Type</b> REAL - Real Property <b>Property Class</b> RRP VI Area 3 <b>Tax Area</b> 94 - SEQUOYAH/TRI-DISTRICT FI <b>Name ID</b> 327007 SUMMERS, BILLY R & LUCY & DAWSON, LAURA M  21422 E RENEE RD CLAREMORE OK 74019-0000  <b>Parcel Location</b> <b>Situs</b> 21422 E RENEE RD <b>Subdivision</b> CIRCLE H RANCH <b>Lot/Block</b> 0016 / 0001 <b>Parcel Size</b> .5 - Lots <b>Sec/Twn/Rng</b> 12 / 21 / 17 / 5 <b>Neighborhood</b> 1215 - R-V03-SE SEQUOYAH <b>School District</b> S006 - SEQUOYAH SCHOOLS				<p>660102449 12/17/25</p> <p>660102449_001.JPG 12/17/2025</p>																																																																					
<b>Legal Description</b> Lat/Long: 36.30885156 -95.44495759 N 165.30' LOT 16 BLOCK 1 CIRCLE H RANCH																																																																									
<b>Exemptions</b>				<b>Building Permits</b>																																																																					
<table border="1"> <thead> <tr> <th>Code</th> <th>Type</th> <th>Active</th> <th>Maximum</th> <th>Exemption</th> </tr> </thead> <tbody> <tr> <td></td> <td></td> <td></td> <td></td> <td></td> </tr> </tbody> </table>				Code	Type	Active	Maximum	Exemption						<table border="1"> <thead> <tr> <th>Number</th> <th>Description</th> <th>Opened</th> <th>Closed</th> <th>Amount</th> </tr> </thead> <tbody> <tr> <td>R20</td> <td>R20- VERIFY STRUCTURES</td> <td>03/2019</td> <td>01/2020</td> <td></td> </tr> </tbody> </table>						Number	Description	Opened	Closed	Amount	R20	R20- VERIFY STRUCTURES	03/2019	01/2020																																													
Code	Type	Active	Maximum	Exemption																																																																					
Number	Description	Opened	Closed	Amount																																																																					
R20	R20- VERIFY STRUCTURES	03/2019	01/2020																																																																						
<b>Sale History</b>				<table border="1"> <thead> <tr> <th>Bk/Pg</th> <th>Grantor</th> <th>Date</th> <th>Price</th> <th>Code</th> </tr> </thead> <tbody> <tr> <td>/</td> <td>SUMMERS, BILLY R &amp; LUCY M</td> <td>09/18/2015</td> <td>0</td> <td>4</td> </tr> </tbody> </table>						Bk/Pg	Grantor	Date	Price	Code	/	SUMMERS, BILLY R & LUCY M	09/18/2015	0	4																																																						
Bk/Pg	Grantor	Date	Price	Code																																																																					
/	SUMMERS, BILLY R & LUCY M	09/18/2015	0	4																																																																					
<b>Parcel Valuation</b>																																																																									
<table border="1"> <thead> <tr> <th>Source</th> <th>REAL</th> <th>Fair Cash</th> <th>Capped</th> <th>Asmnt Level</th> <th>Assessed</th> <th>Levy Rate</th> <th>98.320</th> <th>Current Tax</th> </tr> </thead> <tbody> <tr> <td>Remove Cap</td> <td>0</td> <td>Land Value 9,799</td> <td>9,799</td> <td>11%</td> <td>1,078</td> <td>Assessed</td> <td>2,436</td> <td>239.51</td> </tr> <tr> <td>Year Frozen</td> <td></td> <td>Improvements 13,386</td> <td>5,457</td> <td></td> <td>601</td> <td>Penalty</td> <td>0</td> <td></td> </tr> <tr> <td>Uncapped Value</td> <td>0</td> <td>Mobile Home 6,878</td> <td>6,878</td> <td></td> <td>757</td> <td>Exemption</td> <td>0</td> <td>0.00</td> </tr> <tr> <td>TIF Project ID</td> <td>0</td> <td>Total Value 30,063</td> <td>22,134</td> <td></td> <td>2,436</td> <td>Total Taxable</td> <td>2,436</td> <td>240.00</td> </tr> </tbody> </table>		Source	REAL	Fair Cash	Capped	Asmnt Level	Assessed	Levy Rate	98.320	Current Tax	Remove Cap	0	Land Value 9,799	9,799	11%	1,078	Assessed	2,436	239.51	Year Frozen		Improvements 13,386	5,457		601	Penalty	0		Uncapped Value	0	Mobile Home 6,878	6,878		757	Exemption	0	0.00	TIF Project ID	0	Total Value 30,063	22,134		2,436	Total Taxable	2,436	240.00																											
Source	REAL	Fair Cash	Capped	Asmnt Level	Assessed	Levy Rate	98.320	Current Tax																																																																	
Remove Cap	0	Land Value 9,799	9,799	11%	1,078	Assessed	2,436	239.51																																																																	
Year Frozen		Improvements 13,386	5,457		601	Penalty	0																																																																		
Uncapped Value	0	Mobile Home 6,878	6,878		757	Exemption	0	0.00																																																																	
TIF Project ID	0	Total Value 30,063	22,134		2,436	Total Taxable	2,436	240.00																																																																	
<b>Assessment History</b>																																																																									
<table border="1"> <thead> <tr> <th>Tax Year</th> <th>Statement Number</th> <th>Billed Owner</th> <th>Tax Area</th> <th>Total Value</th> <th>Exemptions</th> <th>Taxable Value</th> <th>Billed Tax</th> </tr> </thead> <tbody> <tr> <td>2025</td> <td>2025-660102449</td> <td>SUMMERS, BILLY R &amp; LUCY &amp;</td> <td>94</td> <td>21,080</td> <td>0</td> <td>2,318</td> <td>228.00</td> </tr> <tr> <td>2024</td> <td>2024-660102449</td> <td>SUMMERS, BILLY R &amp; LUCY &amp;</td> <td>94</td> <td>24,212</td> <td>0</td> <td>2,255</td> <td>236.00</td> </tr> <tr> <td>2023</td> <td>2023-660102449</td> <td>SUMMERS, BILLY R &amp; LUCY &amp;</td> <td>94</td> <td>21,640</td> <td>0</td> <td>2,147</td> <td>229.00</td> </tr> <tr> <td>2022</td> <td>2022-660102449</td> <td>SUMMERS, BILLY R &amp; LUCY &amp;</td> <td>94</td> <td>19,786</td> <td>0</td> <td>2,045</td> <td>221.00</td> </tr> <tr> <td>2021</td> <td>2021-660102449</td> <td>SUMMERS, BILLY R &amp; LUCY &amp;</td> <td>94</td> <td>17,705</td> <td>0</td> <td>1,948</td> <td>203.00</td> </tr> <tr> <td>2020</td> <td>2020-660102449</td> <td>SUMMERS, BILLY R &amp; LUCY &amp;</td> <td>94</td> <td>17,514</td> <td>0</td> <td>1,927</td> <td>200.00</td> </tr> <tr> <td>2019</td> <td>2019-660102449</td> <td>SUMMERS, BILLY R &amp; LUCY &amp;</td> <td>94</td> <td>16,939</td> <td>0</td> <td>1,863</td> <td>191.00</td> </tr> </tbody> </table>										Tax Year	Statement Number	Billed Owner	Tax Area	Total Value	Exemptions	Taxable Value	Billed Tax	2025	2025-660102449	SUMMERS, BILLY R & LUCY &	94	21,080	0	2,318	228.00	2024	2024-660102449	SUMMERS, BILLY R & LUCY &	94	24,212	0	2,255	236.00	2023	2023-660102449	SUMMERS, BILLY R & LUCY &	94	21,640	0	2,147	229.00	2022	2022-660102449	SUMMERS, BILLY R & LUCY &	94	19,786	0	2,045	221.00	2021	2021-660102449	SUMMERS, BILLY R & LUCY &	94	17,705	0	1,948	203.00	2020	2020-660102449	SUMMERS, BILLY R & LUCY &	94	17,514	0	1,927	200.00	2019	2019-660102449	SUMMERS, BILLY R & LUCY &	94	16,939	0	1,863	191.00
Tax Year	Statement Number	Billed Owner	Tax Area	Total Value	Exemptions	Taxable Value	Billed Tax																																																																		
2025	2025-660102449	SUMMERS, BILLY R & LUCY &	94	21,080	0	2,318	228.00																																																																		
2024	2024-660102449	SUMMERS, BILLY R & LUCY &	94	24,212	0	2,255	236.00																																																																		
2023	2023-660102449	SUMMERS, BILLY R & LUCY &	94	21,640	0	2,147	229.00																																																																		
2022	2022-660102449	SUMMERS, BILLY R & LUCY &	94	19,786	0	2,045	221.00																																																																		
2021	2021-660102449	SUMMERS, BILLY R & LUCY &	94	17,705	0	1,948	203.00																																																																		
2020	2020-660102449	SUMMERS, BILLY R & LUCY &	94	17,514	0	1,927	200.00																																																																		
2019	2019-660102449	SUMMERS, BILLY R & LUCY &	94	16,939	0	1,863	191.00																																																																		



# Rogers

## Assessment Property Record Card for Tax Year 2026

Data provided by LISA DELOZIER County Assessor

Date 04/18/2026  
Time 09:56:05  
Page 2

Lot Data		Square-Foot - NBHD 1215 #1		Primary Image				
Lot Size	0 0							
Lot Count	0.5							
Units Buildable	0							
Non-Ag Acres	1.1664							
Topography								
Street Access								
Utilities								
Amenities	HYW FRONTAGE 0							
	0							
Method	Square-Foot							
Base Lot Value	50,808.00 x .19 = 9,799	660102449_001.JPG 12/17/2025						
Factor Value		<b>GRM Approach</b>						
Adjustments	1.0000	GRM Code						
Lot Value	9,799	Gross Rent 0.00						
<b>Residential Data</b>		Indicated Value						
Type		<b>Multiple Regression</b>						
Condition	-	MRA Code						
Quality	-	Adusted R						
Architecture		Indicated Value						
Style		<b>Direct Comparables</b>						
Exterior Wall		Selection Model A Adam Test						
Base/Total Area /		Adjustment Model 1 2022 Residential						
Style		Comparables						
HVAC		Indicated Value						
Roof Cover		<b>Value Reconciliation</b>						
Area on Slab		Selected Approach Cost Approach						
Fixture/RghIn /		Improvements						
Bed/F/H Bath / /		Lot Value 9,799						
Basement Area		Indicated Value 9,799 0.00 Per SqFt						
Garage Type		Agland Value						
Remodel		Site Improvements 10,171						
Year/Eff Age /		Total Value 19,970 0.00 Total Value Per SqFt						
<b>Cost Approach</b>		<b>Manual : 01/2025</b>						
Base Cost	0.00	Total Misc Impr	+	0				
Roofing Adj	+ 0.00	Garage Cost	+					
Subfloor Adj	+ 0.00	Total RCN	=	0				
Heat/Cool Adj	+ 0.00	Depreciation ( 0%)	-	0				
Plumbing Adj	+ 0.00	Lump Sums	+	0				
Basement Adj	+ 0.00	RCNLD	=					
Adj Base Cost	= 0.00	Lot Value	+	9,799				
Total Area	x	Indicated Value	=	9,799				
Adjusted Cost	= 0	Value Per SqFt		0.00				
<b>Miscellaneous Improvements</b>								
Code	Description	Sketch ID	Size	Year	Units	Unit Cost	Depr	Value



# Rogers

## Assessment Property Record Card for Tax Year 2026

Data provided by LISA DELOZIER County Assessor

Date 04/18/2026  
Time 09:56:05  
Page 3

660102449

### Outbuildings/Site Improvements

Building Image	Code	Description	Dimensions	Floor	Roofing	Total Units
	SHDS	Shed - Small	20x16x8	Plank		320
	Qual	2	Cond 3	Year 2018	Eff Age 6	
	<b>Valuation Summary</b>		<b>Modifier Total</b>	<b>RCN</b>	<b>Depr (28% Phys/ % Func)</b>	<b>RCNLD</b>
	Base Cost (17.85 x 320)		5,712	5,712	1,599	4,113
	ASC	Awning/Shelter/Carport	24x12x8	Dirt	Formed Metal	288
	Qual	3	Cond 3	Year 2010	Eff Age 12	
	<b>Valuation Summary</b>		<b>Modifier Total</b>	<b>RCN</b>	<b>Depr (53% Phys/ % Func)</b>	<b>RCNLD</b>
	Base Cost (4.37 x 288)		1,259	1,259	667	592
	SHDS	Shed - Small	10x20x8	Plank	Composition Shingle	200
	Qual	2	Cond 3	Year 2010	Eff Age 12	
	<b>Valuation Summary</b>		<b>Modifier Total</b>	<b>RCN</b>	<b>Depr (46% Phys/ % Func)</b>	<b>RCNLD</b>
	Base Cost (18.81 x 200)		3,762	3,762	1,731	2,031
	SHDS	Shed - Small	24x22x6	Plank	Composition Shingle	528
	Qual	2	Cond 3	Year 2000	Eff Age 20	
	<b>Valuation Summary</b>		<b>Modifier Total</b>	<b>RCN</b>	<b>Depr (59% Phys/ % Func)</b>	<b>RCNLD</b>
	Base Cost (15.87 x 528)		8,379	8,379	4,944	3,435



# Rogers

## Assessment Property Record Card for Tax Year 2026

Data provided by LISA DELOZIER County Assessor

Date 04/18/2026  
 Time 09:56:05  
 Page 4

Lot Data	Primary Image
Lot Size Lot Count Units Buildable Non-Ag Acres Topography Street Access Utilities Amenities HYW FRONTAGE  Method Base Lot Value Factor Value Adjustments Lot Value	

D:\Appraisers\JAYSON\JAYSON RESIDENTIAL VI\2021-5-14\IMG 5/14/2021

Residential Data	
Type	6 Mobile Home 76 x 14
Condition	1.9 - Low
Quality	2 - Fair
Architecture	6 MS ADJ
Style	100% Single Wide
Exterior Wall	100% Aluminum Sheet
Base/Total Area	1,064 / 1,064
Style	100% Single Wide
HVAC	
Roof Cover	14 Metal, Ribbed
Area on Slab	0
Fixture/RghIn	/
Bed/F/H Bath	/ /
Basement Area	
Garage Type	
Remodel	
Year/Eff Age	1981 / 47

GRM Approach	
GRM Code	
Gross Rent	0.00
Indicated Value	

Multiple Regression	
MRA Code	
Adjusted R	
Indicated Value	

Direct Comparables	
Selection Model	A Adam Test
Adjustment Model	1 2022 Residential
Comparables	
Indicated Value	

Cost Approach				Manual : 01/2025			
Base Cost	31.15	Total Misc Impr	+ 5,742				
Roofing Adj	+ 2.58	Garage Cost	+ 0				
Subfloor Adj	+ 0.00	Total RCN	= 49,132				
Heat/Cool Adj	+ 0.00	Depreciation ( 86%)	- 42,254				
Plumbing Adj	+ 7.05	Lump Sums	+ 3,215				
Basement Adj	+ 0.00	RCNLD	= 10,093				
Adj Base Cost	= 40.78	Lot Value	+ 0				
Total Area	x 1,064	Indicated Value	= 10,093				
Adjusted Cost	= 43,390	Value Per SqFt	9.49				

Value Reconciliation			
Selected Approach	Cost Approach		
Improvements	10,093		
Lot Value			
Indicated Value	10,093	9.49	Per SqFt
Agland Value			
Site Improvements			
Total Value	10,093	9.49	Total Value Per SqFt

Miscellaneous Improvements								
Code	Description	Sketch ID	Size	Year	Units	Unit Cost	Depr	Value
WODO	WOOD DECK - OPEN	136148	20x12		240	17.86	25%	3,215
EPSW	ENCLOSED PORCH - SOLID WALL	136149	13x12		156	36.81		5,742



# Rogers

## Assessment Property Record Card for Tax Year 2026

Data provided by LISA DELOZIER County Assessor

Date 04/18/2026  
Time 09:56:05  
Page 5

### Sketch Image

660102449

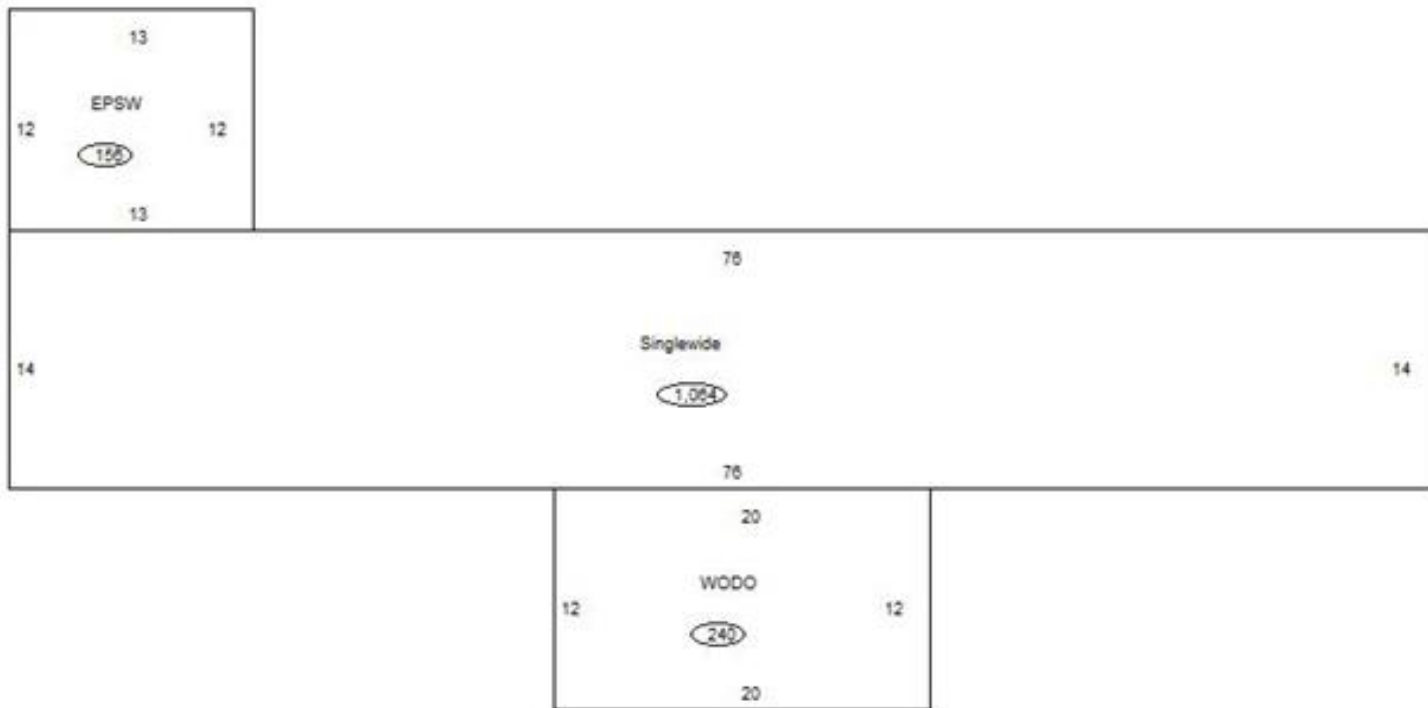

### Sketch Vector Information

Sequence	Code	Type	Built Over	Scale	Section Label	Base Area	Multiplier	Total Area
1	R	13		10	Singlewide	1,064	1.000	1,064
2	M	WODO		10	WODO	240	1.000	240
3	M	EPSW		10	EPSW	156	1.000	156
<b>Total Building Area</b>						1,064		1,064