



Rogers

Assessment Property Record Card for Tax Year 2026

Data provided by LISA DELOZIER County Assessor

Date 04/18/2026
Time 10:01:58
Page 1

Assessment Data					Primary Image																																																																
Account 660103332 Parcel ID 00000-0-0-0000860-002-0002 Cadastral ID 24-20-14-03410 Property Type REAL - Real Property Property Class URP VI Area 3 Tax Area 1 - CATOOSA OT Name ID 333242 MYERS, MORGAN 2911 N BRIARWOOD AVE CATOOSA OK 74015-0000 Parcel Location Situs 02911 N BRIARWOOD AVE Subdivision VALE AT REDBUD PHASE 1 (THE) Lot/Block 0002 / 0002 Parcel Size 1 - Lots Sec/Twn/Rng 24 / 20 / 14 / 5 Neighborhood 1135 - R-V01-NW CATOOSA School District S002 - CATOOSA SCHOOLS					 <p>660103332_002.JPG 9/13/2025</p>																																																																
Legal Description Lot/Long: 36.19706364 -95.76321494 LOT 2 BLOCK 2 THE VALE AT REDBUD PHASE 1																																																																					
Exemptions <table border="1"> <thead> <tr> <th>Code</th> <th>Type</th> <th>Active</th> <th>Maximum</th> <th>Exemption</th> </tr> </thead> <tbody> <tr> <td>HV</td> <td>Veteran</td> <td>Yes</td> <td>999,999</td> <td>35,940</td> </tr> </tbody> </table>					Code	Type	Active	Maximum	Exemption	HV	Veteran	Yes	999,999	35,940	Building Permits <table border="1"> <thead> <tr> <th>Number</th> <th>Description</th> <th>Opened</th> <th>Closed</th> <th>Amount</th> </tr> </thead> <tbody> <tr> <td>R20 170741</td> <td>R21- NEW SFR</td> <td>07/2020</td> <td>11/2020</td> <td>290,000</td> </tr> </tbody> </table>					Number	Description	Opened	Closed	Amount	R20 170741	R21- NEW SFR	07/2020	11/2020	290,000																																								
Code	Type	Active	Maximum	Exemption																																																																	
HV	Veteran	Yes	999,999	35,940																																																																	
Number	Description	Opened	Closed	Amount																																																																	
R20 170741	R21- NEW SFR	07/2020	11/2020	290,000																																																																	
Parcel Valuation <table border="1"> <thead> <tr> <th>Source</th> <th>REAL</th> <th>Fair Cash</th> <th>Capped</th> <th>Asmnt Level</th> <th>Assessed</th> <th>Levy Rate</th> <th>106.660</th> <th>Current Tax</th> </tr> </thead> <tbody> <tr> <td>Remove Cap</td> <td>2022</td> <td>Land Value</td> <td>53,563</td> <td>47,406</td> <td>11%</td> <td>5,215</td> <td>Assessed</td> <td>35,940 3,833.36</td> </tr> <tr> <td>Year Frozen</td> <td></td> <td>Improvements</td> <td>320,669</td> <td>279,319</td> <td></td> <td>30,725</td> <td>Penalty</td> <td>0</td> </tr> <tr> <td>Uncapped Value</td> <td>0</td> <td>Mobile Home</td> <td>0</td> <td>0</td> <td></td> <td>0</td> <td>Exemption</td> <td>35,940 -3,833.00</td> </tr> <tr> <td>TIF Project ID</td> <td>0</td> <td>Total Value</td> <td>374,232</td> <td>326,725</td> <td></td> <td>35,940</td> <td>Total Taxable</td> <td>0 0.00</td> </tr> </tbody> </table>					Source	REAL	Fair Cash	Capped	Asmnt Level	Assessed	Levy Rate	106.660	Current Tax	Remove Cap	2022	Land Value	53,563	47,406	11%	5,215	Assessed	35,940 3,833.36	Year Frozen		Improvements	320,669	279,319		30,725	Penalty	0	Uncapped Value	0	Mobile Home	0	0		0	Exemption	35,940 -3,833.00	TIF Project ID	0	Total Value	374,232	326,725		35,940	Total Taxable	0 0.00	Sale History <table border="1"> <thead> <tr> <th>Bk/Pg</th> <th>Grantor</th> <th>Date</th> <th>Price</th> <th>Code</th> </tr> </thead> <tbody> <tr> <td>/</td> <td>MCAFEE HOLDING GROUP INC</td> <td>01/05/2021</td> <td>299,000</td> <td>YES</td> </tr> <tr> <td>/</td> <td>THE VALE AT REDBUD LLC</td> <td>07/10/2020</td> <td>43,500</td> <td>YES</td> </tr> </tbody> </table>					Bk/Pg	Grantor	Date	Price	Code	/	MCAFEE HOLDING GROUP INC	01/05/2021	299,000	YES	/	THE VALE AT REDBUD LLC	07/10/2020	43,500	YES
Source	REAL	Fair Cash	Capped	Asmnt Level	Assessed	Levy Rate	106.660	Current Tax																																																													
Remove Cap	2022	Land Value	53,563	47,406	11%	5,215	Assessed	35,940 3,833.36																																																													
Year Frozen		Improvements	320,669	279,319		30,725	Penalty	0																																																													
Uncapped Value	0	Mobile Home	0	0		0	Exemption	35,940 -3,833.00																																																													
TIF Project ID	0	Total Value	374,232	326,725		35,940	Total Taxable	0 0.00																																																													
Bk/Pg	Grantor	Date	Price	Code																																																																	
/	MCAFEE HOLDING GROUP INC	01/05/2021	299,000	YES																																																																	
/	THE VALE AT REDBUD LLC	07/10/2020	43,500	YES																																																																	
Assessment History <table border="1"> <thead> <tr> <th>Tax Year</th> <th>Statement Number</th> <th>Billed Owner</th> <th>Tax Area</th> <th>Total Value</th> <th>Exemptions</th> <th>Taxable Value</th> <th>Billed Tax</th> </tr> </thead> <tbody> <tr> <td>2025</td> <td>2025-660103332</td> <td>MYERS, MORGAN</td> <td>1</td> <td>359,849</td> <td>34893</td> <td></td> <td>.00</td> </tr> <tr> <td>2024</td> <td>2024-660103332</td> <td>MYERS, MORGAN</td> <td>1</td> <td>372,766</td> <td>33876</td> <td></td> <td>.00</td> </tr> <tr> <td>2023</td> <td>2023-660103332</td> <td>MYERS, MORGAN</td> <td>1</td> <td>299,000</td> <td>32890</td> <td></td> <td>.00</td> </tr> <tr> <td>2022</td> <td>2022-660103332</td> <td>MYERS, MORGAN</td> <td>1</td> <td>299,000</td> <td>32890</td> <td></td> <td>.00</td> </tr> <tr> <td>2021</td> <td>2021-660103332</td> <td>MYERS, MORGAN</td> <td>1</td> <td>302,596</td> <td>0</td> <td>33,286</td> <td>2,929.00</td> </tr> <tr> <td>2020</td> <td>2020-660103332</td> <td>MCAFEE HOLDING GROUP INC</td> <td>1</td> <td>2,519</td> <td>0</td> <td>277</td> <td>25.00</td> </tr> </tbody> </table>										Tax Year	Statement Number	Billed Owner	Tax Area	Total Value	Exemptions	Taxable Value	Billed Tax	2025	2025-660103332	MYERS, MORGAN	1	359,849	34893		.00	2024	2024-660103332	MYERS, MORGAN	1	372,766	33876		.00	2023	2023-660103332	MYERS, MORGAN	1	299,000	32890		.00	2022	2022-660103332	MYERS, MORGAN	1	299,000	32890		.00	2021	2021-660103332	MYERS, MORGAN	1	302,596	0	33,286	2,929.00	2020	2020-660103332	MCAFEE HOLDING GROUP INC	1	2,519	0	277	25.00				
Tax Year	Statement Number	Billed Owner	Tax Area	Total Value	Exemptions	Taxable Value	Billed Tax																																																														
2025	2025-660103332	MYERS, MORGAN	1	359,849	34893		.00																																																														
2024	2024-660103332	MYERS, MORGAN	1	372,766	33876		.00																																																														
2023	2023-660103332	MYERS, MORGAN	1	299,000	32890		.00																																																														
2022	2022-660103332	MYERS, MORGAN	1	299,000	32890		.00																																																														
2021	2021-660103332	MYERS, MORGAN	1	302,596	0	33,286	2,929.00																																																														
2020	2020-660103332	MCAFEE HOLDING GROUP INC	1	2,519	0	277	25.00																																																														



Rogers

Assessment Property Record Card for Tax Year 2026

Data provided by LISA DELOZIER County Assessor

Date 04/18/2026
Time 10:01:59
Page 2

Lot Data	Square-Foot - NBHD 1135 #1	Primary Image
Lot Size	0 0	
Lot Count	1	
Units Buildable		
Non-Ag Acres	0.2053	
Topography		
Street Access		
Utilities		
Amenities	0	
	0	
Method	Square-Foot	
Base Lot Value	8,942.00 x 5.99 = 53,563	
Factor Value		
Adjustments	1.0000	
Lot Value	53,563	

Residential Data	
Type	1 Single Family Residence
Condition	3 - Average
Quality	3 - Average
Architecture	TRAD TRADITIONAL
Style	100% One Story
Exterior Wall	98% Veneer, Masonry 2% Frame, Siding, Wood
Base/Total Area	2,348 / 2,348
Style	100% One Story
HVAC	100% Warmed & Cooled Air
Roof Cover	1 Composition Shingle
Area on Slab	2,348
Fixture/RghIn	14 /
Bed/F/H Bath	3 / 2.0 /
Basement Area	
Garage Type	655 Attached Garage - Finished 2 Stalls
Remodel	
Year/Eff Age	2020 / 5

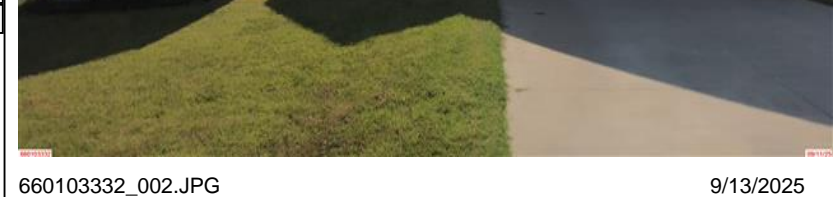

660103332_002.JPG 9/13/2025

GRM Approach	
GRM Code	
Gross Rent	0.00
Indicated Value	

Multiple Regression			
MRA Code	1	Test	
Adusted R	0.8445		
Indicated Value	313,917	133.70	Per SqFt

Direct Comparables			
Selection Model	A	Adam Test	
Adjustment Model	1	2022 Residential	
Comparables	8		
Indicated Value	333,660		Per SqFt

Cost Approach				Manual : 01/2025			
Base Cost	104.06	Total Misc Impr	+	13,666			
Roofing Adj	+ 4.55	Garage Cost	+	24,792			
Subfloor Adj	+ -2.19	Total RCN	=	337,546			
Heat/Cool Adj	+ 12.64	Depreciation (5%)	-	16,877			
Plumbing Adj	+ 8.32	Lump Sums	+	0			
Basement Adj	+ 0.00	RCNLD	=	320,669			
Adj Base Cost	= 127.38	Lot Value	+	53,563			
Total Area	x 2,348	Indicated Value	=	374,232			
Adjusted Cost	= 299,088	Value Per SqFt		159.38			

Value Reconciliation			
Selected Approach	Cost Approach		
Improvements	320,669		
Lot Value	53,563		
Indicated Value	374,232	159.38	Per SqFt
Agland Value			
Site Improvements			
Total Value	374,232	159.38	Total Value Per SqFt

Miscellaneous Improvements								
Code	Description	Sketch ID	Size	Year	Units	Unit Cost	Depr	Value
FPR1	FIREPLACE - RESIDENTIAL 1 STORY	0		1	1	5,615.40		5,615
PRCH	SLAB PORCH - COVERED	148192	17x12		204	26.29		5,363
PRCH	SLAB PORCH - COVERED	148194	101		101	26.61		2,688



Rogers
Assessment Property Record Card for Tax Year 2026

Data provided by LISA DELOZIER County Assessor

Date 04/18/2026
 Time 10:01:59
 Page 3

Sketch Image

660103332

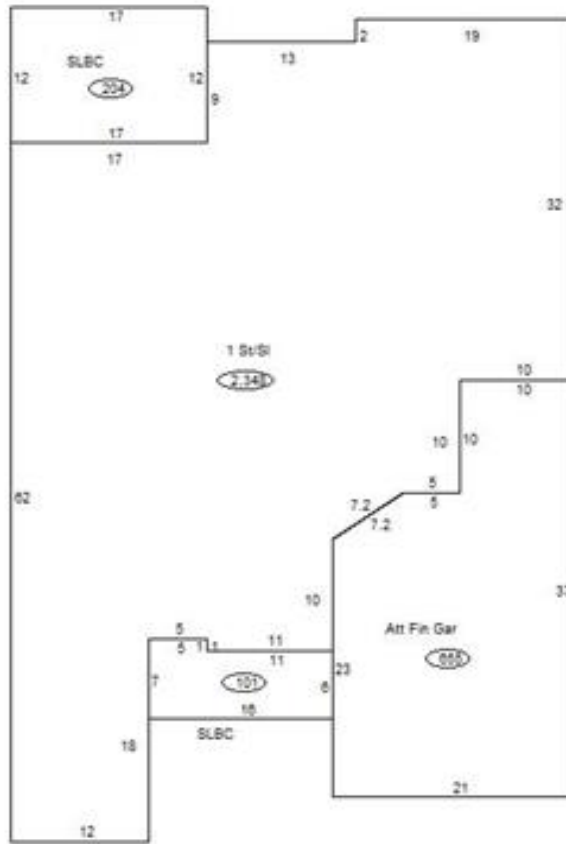

Sketch Vector Information

Sequence	Code	Type	Built Over	Scale	Section Label	Base Area	Multiplier	Total Area
1	R	1	Slab	13	1 St/SI	2,348	1.000	2,348
2	M	PRCH		13	SLBC	204	1.000	204
3	G	5		13	Att Fin Gar	655	1.000	655
4	M	PRCH		13	SLBC	101	1.000	101
Total Building Area						2,348		2,348