



Rogers

Assessment Property Record Card for Tax Year 2026

Data provided by LISA DELOZIER County Assessor

Date 04/18/2026
Time 10:07:49
Page 1

| Assessment Data | | | | | Primary Image | | | | |
|---|-------------------------|--------------------------------|--------------------|------------------|--|--------------------------------|-------------------|----------------------|--------------------|
| Account 660103912 Parcel ID 21N16E-29-1-00000-001-0000 Cadastral ID 29-21-16-01830 Property Type REAL - Real Property Property Class RR VI Area 1 Tax Area 21 - CLAREMORE RURAL/VERD FIR Name ID 330615 HENDRICKSON, BRIAN J & PATTI L 11910 E TANNER DR CLAREMORE OK 74019-0000 Parcel Location Situs 11910 E TANNER DR Subdivision Lot/Block / Parcel Size 2 - Acres Sec/Twn/Rng 29 / 21 / 16 / 1 Neighborhood 2116 - UNPLATTED School District S001 - CLAREMORE SCHOOLS | | | | | <p>\\tsclient\A\TOMMY DUNLAP\New folder (230)\IMG_0059.JPG 7/17/2023</p> | | | | |
| Legal Description Lat/Long: 36.27161808 -95.61539618 | | | | | | | | | |
| E 264' S2 S2 SE NE | | | | | Building Permits | | | | |
| | | | | | Number | Description | Opened | Closed | Amount |
| | | | | | R20 | R22- SPLIT | 06/2020 | 04/2021 | |
| Exemptions | | | | | Sale History | | | | |
| Code | Type | Active | Maximum | Exemption | Bk/Pg | Grantor | Date | Price | Code |
| H | Homestead | Yes | 1,000 | 1,000 | / | HENDRICKSON, JAMES E & SALLY A | 03/05/2020 | | 4 |
| Parcel Valuation | | | | | | | | | |
| Source | REAL | | Fair Cash | Capped | Asmnt Level | Assessed | Levy Rate | 109.172 | Current Tax |
| Remove Cap | 2015 | | Land Value | 57,509 | 42,278 | 11% | 4,651 | Assessed | 48,687 5,315.25 |
| Year Frozen | | | Improvements | 439,828 | 400,331 | | 44,036 | Penalty | 0 |
| Uncapped Value | 0 | | Mobile Home | 0 | 0 | | 0 | Exemption | 1,000 -92.00 |
| TIF Project ID | 0 | | Total Value | 497,337 | 442,609 | | 48,687 | Total Taxable | 47,687 5,223.00 |
| Assessment History | | | | | | | | | |
| Tax Year | Statement Number | Billed Owner | | | Tax Area | Total Value | Exemptions | Taxable Value | Billed Tax |
| 2025 | 2025-660103912 | HENDRICKSON, BRIAN J & PATTI L | | | 21 | 475,160 | 1000 | 46,269 | 5,068.00 |
| 2024 | 2024-660103912 | HENDRICKSON, BRIAN J & PATTI L | | | 21 | 498,324 | 1000 | 44,892 | 4,622.00 |
| 2023 | 2023-660103912 | HENDRICKSON, BRIAN J & PATTI L | | | 21 | 378,837 | 1000 | 40,672 | 4,155.00 |
| 2022 | 2022-660103912 | HENDRICKSON, BRIAN J & PATTI L | | | 21 | 395,855 | 1000 | 39,937 | 4,119.00 |
| 2021 | 2021-660103912 | HENDRICKSON, BRIAN J & PATTI L | | | 21 | 31,500 | 0 | 2,334 | 230.00 |
| 2020 | 2020-660103912 | HENDRICKSON, BRIAN J & PATTI L | | | 21 | 31,000 | 0 | 2,223 | 227.00 |



Rogers

Assessment Property Record Card for Tax Year 2026

Data provided by LISA DELOZIER County Assessor

Date 04/18/2026
 Time 10:07:49
 Page 2

| Lot Data | | Square-Foot - NBHD 2116 #1 | |
|-----------------|--------------------------|----------------------------|---|
| Lot Size | 0 | 0 | |
| Lot Count | 0 | | |
| Units Buildable | 0 | | |
| Non-Ag Acres | 2.0012 | | |
| Topography | | | |
| Street Access | | | |
| Utilities | | | |
| Amenities | LAND QUALITY | | 0 |
| | | | 0 |
| Method | Square-Foot | | |
| Base Lot Value | 87,170.00 x .66 = 57,509 | | |
| Factor Value | | | |
| Adjustments | 1.0000 | | |
| Lot Value | 57,509 | | |



\\tsclient\A\TOMMY DUNLAP\New folder (230)\IMG_0059.JPG 7/17/2023

| Residential Data | |
|------------------|-------------------------------------|
| Type | 1 Single Family Residence |
| Condition | 4 - Good |
| Quality | 3.5 - Average |
| Architecture | |
| Style | 100% One Story |
| Exterior Wall | 80% Frame, Stucco 20% Veneer, Stone |
| Base/Total Area | 2,426 / 2,426 |
| Style | 100% One Story |
| HVAC | 100% Warmed & Cooled Air |
| Roof Cover | 1 Composition Shingle |
| Area on Slab | 2,426 |
| Fixture/RghIn | 11 / |
| Bed/F/H Bath | 3 / 2.0 / |
| Basement Area | |
| Garage Type | 756 Attached Garage - Unfinished |
| Remodel | |
| Year/Eff Age | 2021 / 3 |

| GRM Approach | |
|-----------------|------|
| GRM Code | |
| Gross Rent | 0.00 |
| Indicated Value | |

| Multiple Regression | | | |
|---------------------|---------|--------|----------|
| MRA Code | 1 | Test | |
| Adusted R | 0.8445 | | |
| Indicated Value | 451,001 | 185.90 | Per SqFt |

| Direct Comparables | |
|--------------------|-------------|
| Selection Model | A Adam Test |
| Adjustment Model | NewTest |
| Comparables | |
| Indicated Value | |

| Cost Approach | | Manual : 01/2025 | |
|---------------|-----------|--------------------|-----------|
| Base Cost | 104.96 | Total Misc Impr | + 20,859 |
| Roofing Adj | + 5.19 | Garage Cost | + 28,131 |
| Subfloor Adj | + -3.40 | Total RCN | = 360,852 |
| Heat/Cool Adj | + 14.47 | Depreciation (3%) | - 10,826 |
| Plumbing Adj | + 7.33 | Lump Sums | + 0 |
| Basement Adj | + 0.00 | RCNLD | = 350,026 |
| Adj Base Cost | = 128.55 | Lot Value | + 57,509 |
| Total Area | x 2,426 | Indicated Value | = 407,535 |
| Adjusted Cost | = 311,862 | Value Per SqFt | 167.99 |

| Value Reconciliation | | | |
|----------------------|---------------|--------|----------------------|
| Selected Approach | Cost Approach | | |
| Improvements | 350,026 | | |
| Lot Value | 57,509 | | |
| Indicated Value | 407,535 | 167.99 | Per SqFt |
| Agland Value | | | |
| Site Improvements | 89,802 | | |
| Total Value | 497,337 | 205.00 | Total Value Per SqFt |

| Miscellaneous Improvements | | | | | | | | |
|----------------------------|---------------------------------|-----------|-------|------|-------|-----------|------|-------|
| Code | Description | Sketch ID | Size | Year | Units | Unit Cost | Depr | Value |
| SHLT | STORM SHELTER | 0 | 4x6 | 2020 | 24 | 0.00 | | |
| PRCH | SLAB PORCH - COVERED | 149882 | 32x11 | | 352 | 28.31 | | 9,965 |
| PRCH | SLAB PORCH - COVERED | 149884 | 154 | | 154 | 28.99 | | 4,464 |
| FPR1 | FIREPLACE - RESIDENTIAL 1 STORY | | 1 | | 1 | 6,429.63 | | 6,430 |



Rogers

Assessment Property Record Card for Tax Year 2026

Data provided by LISA DELOZIER County Assessor

Date 04/18/2026

Time 10:07:49

Page 3

Sketch Image

660103912

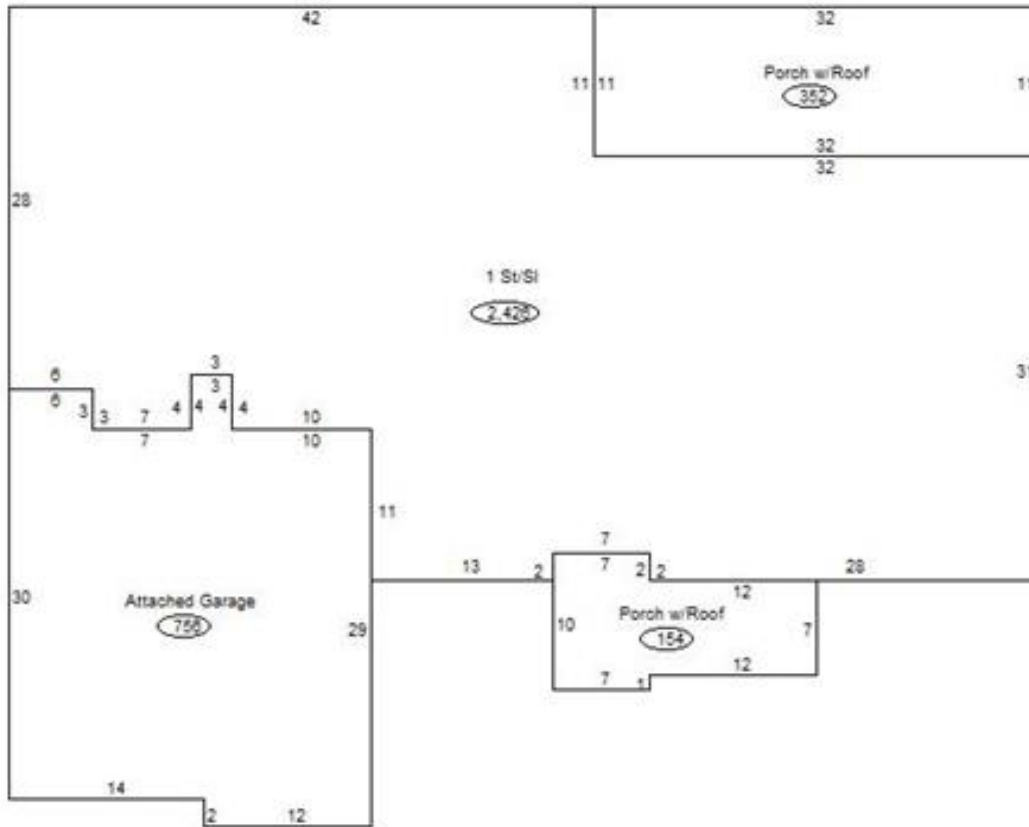

Sketch Vector Information

| Sequence | Code | Type | Built Over | Scale | Section Label | Base Area | Multiplier | Total Area |
|----------------------------|------|------|------------|-------|-----------------|-----------|------------|------------|
| 1 | R | 1 | Slab | 13 | 1 St/Sl | 2,426 | 1.000 | 2,426 |
| 2 | M | PRCH | | 13 | SLBC | 352 | 1.000 | 352 |
| 3 | G | 1 | | 13 | Attached Garage | 756 | 1.000 | 756 |
| 4 | M | PRCH | | 13 | SLBC | 154 | 1.000 | 154 |
| Total Building Area | | | | | | 2,426 | | 2,426 |



Rogers



Assessment Property Record Card for Tax Year 2026

Data provided by LISA DELOZIER County Assessor

Date 04/18/2026
Time 10:07:49
Page 4

660103912

Outbuildings/Site Improvements

| Building Image | Code | Description | Dimensions | Floor | Roofing | Total Units | |
|--|------|---------------------------|-----------------------|---------------------|--------------------------------|--------------|--------|
|  | SPLG | Swimming Pool - In Ground | 36x20x0 | Reinforced-Concrete | | 720 | |
| | Qual | 3 | Cond 3 | Year 2022 | Eff Age 3 | | |
| | | Valuation Summary | Modifier Total | RCN | Depr (15% Phys/ % Func) | RCNLD | |
| | | Base Cost (49.25 x 720) | 35,460 | | 35,460 | 5,319 | 30,141 |
|  | GRDT | GARAGE - DETACHED | 0x0x0 | | | 1,690 | |
| | Qual | 4 | Cond 3 | Year 2021 | Eff Age 4 | | |
| | | Valuation Summary | Modifier Total | RCN | Depr (7% Phys/ % Func) | RCNLD | |
| | | Base Cost (37.96 x 1,690) | 64,152 | | 64,152 | 4,491 | 59,661 |