



# Rogers

## Assessment Property Record Card for Tax Year 2026

Data provided by LISA DELOZIER County Assessor

Date 04/18/2026  
Time 10:30:09  
Page 1

Assessment Data					Primary Image																																																																
<b>Account</b> 660105579 <b>Parcel ID</b> 000000-0007-005-0-000-00 <b>Cadastral ID</b> 27-21-14-08080 <b>Property Type</b> REAL - Real Property <b>Property Class</b> URP VI Area 4 <b>Tax Area</b> 40 - OWASSO CITY <b>Name ID</b> 338747 KOEHLER, JEFFEREY & REBEKAH LYNN  8007 N 147TH E AVE OWASSO OK 74055-0000  <b>Parcel Location</b> <b>Situs</b> 08007 N 147TH E AVE <b>Subdivision</b> PRESLEY HOLLOW <b>Lot/Block</b> 0005 / 0007 <b>Parcel Size</b> 1 - Lots <b>Sec/Twn/Rng</b> 27 / 21 / 14 / 5 <b>Neighborhood</b> 1087 - R-V04-SW OWASSO <b>School District</b> S021 - OWASSO SCHOOLS																																																																					
<b>Legal Description</b> Lot/Long: 36.27019863 -95.80904647 LOT 5 BLOCK 7 PRESLEY HOLLOW																																																																					
<b>Exemptions</b> <table border="1"> <thead> <tr> <th>Code</th> <th>Type</th> <th>Active</th> <th>Maximum</th> <th>Exemption</th> </tr> </thead> <tbody> <tr> <td>HV</td> <td>Veteran</td> <td>Yes</td> <td>999,999</td> <td>48,130</td> </tr> </tbody> </table>					Code	Type	Active	Maximum	Exemption	HV	Veteran	Yes	999,999	48,130	<b>Building Permits</b> <table border="1"> <thead> <tr> <th>Number</th> <th>Description</th> <th>Opened</th> <th>Closed</th> <th>Amount</th> </tr> </thead> <tbody> <tr> <td>R21 1003X</td> <td>R23- NEW 2430 SQ FT SFR</td> <td>11/2021</td> <td>08/2022</td> <td>171,765</td> </tr> </tbody> </table>					Number	Description	Opened	Closed	Amount	R21 1003X	R23- NEW 2430 SQ FT SFR	11/2021	08/2022	171,765																																								
Code	Type	Active	Maximum	Exemption																																																																	
HV	Veteran	Yes	999,999	48,130																																																																	
Number	Description	Opened	Closed	Amount																																																																	
R21 1003X	R23- NEW 2430 SQ FT SFR	11/2021	08/2022	171,765																																																																	
<b>Parcel Valuation</b> <table border="1"> <thead> <tr> <th>Source</th> <th>REAL</th> <th>Fair Cash</th> <th>Capped</th> <th>Asmnt Level</th> <th>Assessed</th> <th>Levy Rate</th> <th>97.960</th> <th>Current Tax</th> </tr> </thead> <tbody> <tr> <td>Remove Cap</td> <td>2023</td> <td>Land Value</td> <td>64,133</td> <td>64,133</td> <td>11%</td> <td>7,055</td> <td>Assessed</td> <td>48,130 4,714.81</td> </tr> <tr> <td>Year Frozen</td> <td></td> <td>Improvements</td> <td>376,370</td> <td>373,412</td> <td></td> <td>41,075</td> <td>Penalty</td> <td>0</td> </tr> <tr> <td>Uncapped Value</td> <td>0</td> <td>Mobile Home</td> <td>0</td> <td>0</td> <td></td> <td>0</td> <td>Exemption</td> <td>48,130 -4,715.00</td> </tr> <tr> <td>TIF Project ID</td> <td>0</td> <td>Total Value</td> <td>440,503</td> <td>437,545</td> <td></td> <td>48,130</td> <td>Total Taxable</td> <td>0 0.00</td> </tr> </tbody> </table>					Source	REAL	Fair Cash	Capped	Asmnt Level	Assessed	Levy Rate	97.960	Current Tax	Remove Cap	2023	Land Value	64,133	64,133	11%	7,055	Assessed	48,130 4,714.81	Year Frozen		Improvements	376,370	373,412		41,075	Penalty	0	Uncapped Value	0	Mobile Home	0	0		0	Exemption	48,130 -4,715.00	TIF Project ID	0	Total Value	440,503	437,545		48,130	Total Taxable	0 0.00	<b>Sale History</b> <table border="1"> <thead> <tr> <th>Bk/Pg</th> <th>Grantor</th> <th>Date</th> <th>Price</th> <th>Code</th> </tr> </thead> <tbody> <tr> <td>/</td> <td>EXECUTIVE HOMES LLC</td> <td>06/22/2022</td> <td>429,000</td> <td>YES</td> </tr> <tr> <td>/</td> <td>BLUE CHIP LAND CO LLC</td> <td>12/02/2021</td> <td>0</td> <td>WB</td> </tr> </tbody> </table>					Bk/Pg	Grantor	Date	Price	Code	/	EXECUTIVE HOMES LLC	06/22/2022	429,000	YES	/	BLUE CHIP LAND CO LLC	12/02/2021	0	WB
Source	REAL	Fair Cash	Capped	Asmnt Level	Assessed	Levy Rate	97.960	Current Tax																																																													
Remove Cap	2023	Land Value	64,133	64,133	11%	7,055	Assessed	48,130 4,714.81																																																													
Year Frozen		Improvements	376,370	373,412		41,075	Penalty	0																																																													
Uncapped Value	0	Mobile Home	0	0		0	Exemption	48,130 -4,715.00																																																													
TIF Project ID	0	Total Value	440,503	437,545		48,130	Total Taxable	0 0.00																																																													
Bk/Pg	Grantor	Date	Price	Code																																																																	
/	EXECUTIVE HOMES LLC	06/22/2022	429,000	YES																																																																	
/	BLUE CHIP LAND CO LLC	12/02/2021	0	WB																																																																	
<b>Assessment History</b> <table border="1"> <thead> <tr> <th>Tax Year</th> <th>Statement Number</th> <th>Billed Owner</th> <th>Tax Area</th> <th>Total Value</th> <th>Exemptions</th> <th>Taxable Value</th> <th>Billed Tax</th> </tr> </thead> <tbody> <tr> <td>2025</td> <td>2025-660105579</td> <td>KOEHLER, JEFFEREY &amp;</td> <td>40</td> <td>424,801</td> <td>46728</td> <td></td> <td>.00</td> </tr> <tr> <td>2024</td> <td>2024-660105579</td> <td>KOEHLER, JEFFEREY &amp;</td> <td>40</td> <td>429,000</td> <td>1000</td> <td>46,190</td> <td>4,437.00</td> </tr> <tr> <td>2023</td> <td>2023-660105579</td> <td>KOEHLER, JEFFEREY &amp;</td> <td>40</td> <td>429,000</td> <td>1000</td> <td>46,190</td> <td>4,328.00</td> </tr> <tr> <td>2022</td> <td>2022-660105579</td> <td>KOEHLER, JEFFEREY &amp;</td> <td>40</td> <td>3,394</td> <td>0</td> <td>373</td> <td>37.00</td> </tr> </tbody> </table>										Tax Year	Statement Number	Billed Owner	Tax Area	Total Value	Exemptions	Taxable Value	Billed Tax	2025	2025-660105579	KOEHLER, JEFFEREY &	40	424,801	46728		.00	2024	2024-660105579	KOEHLER, JEFFEREY &	40	429,000	1000	46,190	4,437.00	2023	2023-660105579	KOEHLER, JEFFEREY &	40	429,000	1000	46,190	4,328.00	2022	2022-660105579	KOEHLER, JEFFEREY &	40	3,394	0	373	37.00																				
Tax Year	Statement Number	Billed Owner	Tax Area	Total Value	Exemptions	Taxable Value	Billed Tax																																																														
2025	2025-660105579	KOEHLER, JEFFEREY &	40	424,801	46728		.00																																																														
2024	2024-660105579	KOEHLER, JEFFEREY &	40	429,000	1000	46,190	4,437.00																																																														
2023	2023-660105579	KOEHLER, JEFFEREY &	40	429,000	1000	46,190	4,328.00																																																														
2022	2022-660105579	KOEHLER, JEFFEREY &	40	3,394	0	373	37.00																																																														



# Rogers

## Assessment Property Record Card for Tax Year 2026

Data provided by LISA DELOZIER County Assessor

Date 04/18/2026  
 Time 10:30:09  
 Page 2

Lot Data		Square-Foot - NBHD 1087 #1	
Lot Size	0	0	
Lot Count	1		
Units Buildable			
Non-Ag Acres	0.1963		
Topography			
Street Access			
Utilities			
Amenities			0
			0
Method	Square-Foot		
Base Lot Value	8,551.00 x 6.00 = 51,306		
Factor Value			
Adjustments	1.2500		
Lot Value	64,133		



\\tsclient\X\Rob Stuff\ROBS NEW CONST\2022-8-12\IMG\_0021.JF 8/12/2022

Residential Data	
Type	1 Single Family Residence
Condition	4 - Good
Quality	4 - Good
Architecture	
Style	100% One Story
Exterior Wall	95% Veneer, Masonry 5% Veneer, Stone
Base/Total Area	2,424 / 2,424
Style	100% One Story
HVAC	100% Warmed & Cooled Air
Roof Cover	1 Composition Shingle
Area on Slab	2,424
Fixture/RghIn	/
Bed/F/H Bath	3 / 2.0 / 1.0
Basement Area	
Garage Type	671 Attached Garage - Finished
Remodel	
Year/Eff Age	2022 / 3

### GRM Approach

GRM Code	
Gross Rent	0.00
Indicated Value	

### Multiple Regression

MRA Code	1	Test
Adusted R	0.8445	
Indicated Value	386,212	159.33 Per SqFt

### Direct Comparables

Selection Model	A	Adam Test
Adjustment Model	1	2022 Residential
Comparables	8	
Indicated Value	519,190	Per SqFt

### Value Reconciliation

Selected Approach	Cost Approach		
Improvements	376,370		
Lot Value	64,133		
Indicated Value	440,503	181.73	Per SqFt
Agland Value			
Site Improvements			
Total Value	440,503	181.73	Total Value Per SqFt

Cost Approach		Manual : 01/2025	
Base Cost	113.79	Total Misc Impr	+ 12,776
Roofing Adj	+ 5.84	Garage Cost	+ 38,589
Subfloor Adj	+ -4.61	Total RCN	= 388,010
Heat/Cool Adj	+ 16.31	Depreciation ( 3%)	- 11,640
Plumbing Adj	+ 7.55	Lump Sums	+ 0
Basement Adj	+ 0.00	RCNLD	= 376,370
Adj Base Cost	= 138.88	Lot Value	+ 64,133
Total Area	x 2,424	Indicated Value	= 440,503
Adjusted Cost	= 336,645	Value Per SqFt	181.73

### Miscellaneous Improvements

Code	Description	Sketch ID	Size	Year	Units	Unit Cost	Depr	Value
PRCH	Slab Porch - Covered	154650	365		365	31.74		11,585
PRCH	Slab Porch - Covered	154651	6x6		36	33.08		1,191



# Rogers

## Assessment Property Record Card for Tax Year 2026

Data provided by LISA DELOZIER County Assessor

Date 04/18/2026

Time 10:30:10

Page 3

Sketch Image

660105579

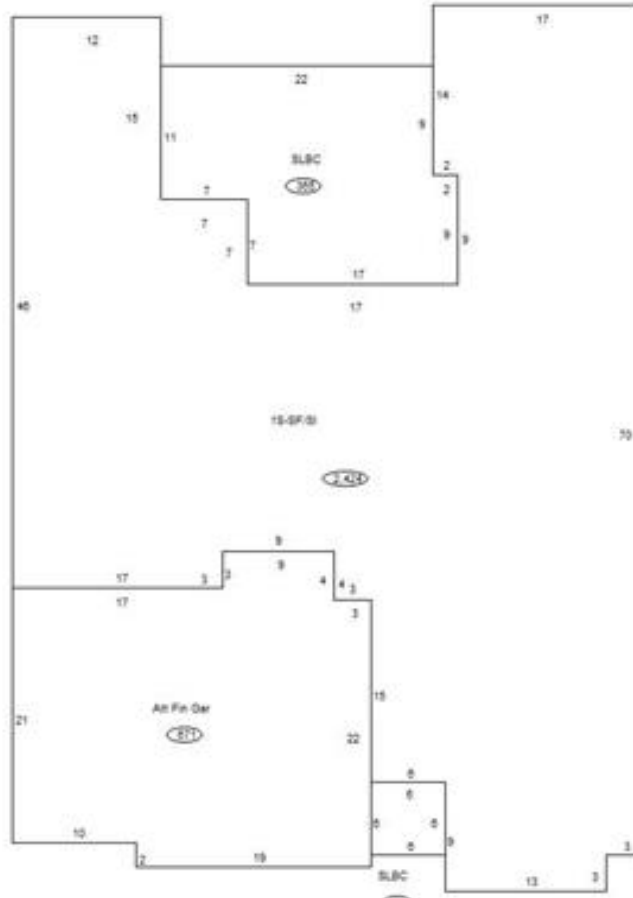

### Sketch Vector Information

Sequence	Code	Type	Built Over	Scale	Section Label	Base Area	Multiplier	Total Area
1	R	1	Slab	10	1S-SF/Sl	2,424	1.000	2,424
2	G	5		10	Att Fin Gar	671	1.000	671
3	M	PRCH		10	SLBC	365	1.000	365
4	M	PRCH		10	SLBC	36	1.000	36
<b>Total Building Area</b>						<b>2,424</b>		<b>2,424</b>