



Rogers

Assessment Property Record Card for Tax Year 2026

Data provided by LISA DELOZIER County Assessor

Date 04/18/2026
Time 10:31:13
Page 1

| Assessment Data | | | | | Primary Image | | | | |
|--|--------------------------|-----------------------|----------|-------------|---------------|---------------|---------------|-------------|-----------|
| Account | 660105613 | | | | | | | | |
| Parcel ID | 000000-0009-008-0-000-00 | | | | | | | | |
| Cadastral ID | 27-21-14-08420 | | | | | | | | |
| Property Type | REAL - Real Property | | | | | | | | |
| Property Class | URP | VI Area | 4 | | | | | | |
| Tax Area | 40 - OWASSO CITY | | | | | | | | |
| Name ID | 344389 | | | | | | | | |
| CALVERT, PERCY & JOAN | | | | | | | | | |
| 7713 N 147TH E AVE OWASSO OK 74055-0000 | | | | | | | | | |
| Parcel Location | | | | | | | | | |
| Situs | 07713 N 147TH E AVE | | | | | | | | |
| Subdivision | PRESLEY HOLLOW | | | | | | | | |
| Lot/Block | 0008 / 0009 | Parcel Size | 1 - Lots | | | | | | |
| Sec/Twn/Rng | 27 / 21 / 14 / 5 | | | | | | | | |
| Neighborhood | 1087 - R-V04-SW OWASSO | | | | | | | | |
| School District | S021 - OWASSO SCHOOLS | | | | | | | | |
| Legal Description Lat/Long: 36.26586325 -95.80919943 | | | | | | | | | |
| Building Permits | | | | | | | | | |
| LOT 8 BLOCK 9 PRESLEY HOLLOW | | | | | | | | | |
| Number | Description | Opened | Closed | Amount | | | | | |
| R23 905X | R24 NEW SFR 3407 SQ FT | 10/2023 | 03/2024 | 279,900 | | | | | |
| Exemptions | | | | | | | | | |
| Code | Type | Active | Maximum | Exemption | | | | | |
| HV | Veteran | Yes | 999,999 | 70,246 | | | | | |
| Sale History | | | | | | | | | |
| Bk/Pg | Grantor | Date | Price | Code | | | | | |
| / | EXECUTIVE HOMES LLC | 05/20/2024 | 620,000 | YES | | | | | |
| / | BLUE CHIP LAND CO LLC | 08/31/2023 | 0 | WB | | | | | |
| Parcel Valuation | | | | | | | | | |
| Source | REAL | Fair Cash | Capped | Asmnt Level | Assessed | Levy Rate | 97.960 | Current Tax | |
| Remove Cap | 2025 | Land Value | 96,730 | 96,730 | 11% | 10,640 | Assessed | 70,246 | 6,881.30 |
| Year Frozen | | Improvements | 549,494 | 541,870 | | 59,606 | Penalty | 0 | |
| Uncapped Value | 0 | Mobile Home | 0 | 0 | | 0 | Exemption | 70,246 | -6,881.00 |
| TIF Project ID | 0 | Total Value | 646,224 | 638,600 | | 70,246 | Total Taxable | 0 | 0.00 |
| Assessment History | | | | | | | | | |
| Tax Year | Statement Number | Billed Owner | Tax Area | Total Value | Exemptions | Taxable Value | Billed Tax | | |
| 2025 | 2025-660105613 | CALVERT, PERCY & JOAN | 40 | 620,000 | 68200 | | .00 | | |
| 2024 | 2024-660105613 | CALVERT, PERCY & JOAN | 40 | 3,394 | 373 | | .00 | | |
| 2023 | 2023-660105613 | EXECUTIVE HOMES LLC | 40 | 3,394 | 0 | 373 | 35.00 | | |
| 2022 | 2022-660105613 | BLUE CHIP LAND CO LLC | 40 | 3,394 | 0 | 373 | 37.00 | | |



Rogers

Assessment Property Record Card for Tax Year 2026

Data provided by LISA DELOZIER County Assessor

Date 04/18/2026
 Time 10:31:13
 Page 2

| Lot Data | | Square-Foot - NBHD 1087 #1 | |
|-----------------|--------------------------|----------------------------|---|
| Lot Size | 0 | 0 | |
| Lot Count | 1 | | |
| Units Buildable | | | |
| Non-Ag Acres | 0.2292 | | |
| Topography | | | |
| Street Access | | | |
| Utilities | | | |
| Amenities | | | 0 |
| | | | 0 |
| Method | Square-Foot | | |
| Base Lot Value | 9,983.00 x 6.00 = 59,898 | | |
| Factor Value | | | |
| Adjustments | 1.6149 | | |
| Lot Value | 96,730 | | |



001 3/18/2024

| Residential Data | |
|------------------|---------------------------------------|
| Type | 1 Single Family Residence |
| Condition | 4 - Good |
| Quality | 4.5 - Good |
| Architecture | |
| Style | 100% 1 1/2 Story Finished |
| Exterior Wall | 90% Veneer, Masonry 10% Veneer, Stone |
| Base/Total Area | 2,803 / 3,746 |
| Style | 100% 1 1/2 Story Finished |
| HVAC | 100% Warmed & Cooled Air |
| Roof Cover | 1 Composition Shingle |
| Area on Slab | 2,803 |
| Fixture/RghIn | / |
| Bed/F/H Bath | 5 / 3.0 / 1.0 |
| Basement Area | |
| Garage Type | 712 Attached Garage - Finished |
| Remodel | |
| Year/Eff Age | 2024 / 1 |

GRM Approach

| | |
|-----------------|------|
| GRM Code | |
| Gross Rent | 0.00 |
| Indicated Value | |

Multiple Regression

| | |
|-----------------|--|
| MRA Code | |
| Adjusted R | |
| Indicated Value | |

Direct Comparables

| | |
|------------------|--------------------|
| Selection Model | A Adam Test |
| Adjustment Model | 1 2022 Residential |
| Comparables | |
| Indicated Value | |

Value Reconciliation

| | | | |
|-------------------|---------------|--------|----------------------|
| Selected Approach | Cost Approach | | |
| Improvements | 549,494 | | |
| Lot Value | 96,730 | | |
| Indicated Value | 646,224 | 172.51 | Per SqFt |
| Agland Value | | | |
| Site Improvements | | | |
| Total Value | 646,224 | 172.51 | Total Value Per SqFt |

Cost Approach Manual : 01/2025

| | | | | |
|---------------|-----------|--------------------|---|---------|
| Base Cost | 105.55 | Total Misc Impr | + | 21,486 |
| Roofing Adj | + 4.55 | Garage Cost | + | 43,282 |
| Subfloor Adj | + -3.27 | Total RCN | = | 555,044 |
| Heat/Cool Adj | + 17.38 | Depreciation (1%) | - | 5,550 |
| Plumbing Adj | + 6.67 | Lump Sums | + | 0 |
| Basement Adj | + 0.00 | RCNLD | = | 549,494 |
| Adj Base Cost | = 130.88 | Lot Value | + | 96,730 |
| Total Area | x 3,746 | Indicated Value | = | 646,224 |
| Adjusted Cost | = 490,276 | Value Per SqFt | | 172.51 |

Miscellaneous Improvements

| Code | Description | Sketch ID | Size | Year | Units | Unit Cost | Depr | Value |
|------|---------------------------|-----------|------|--------|-------|-----------|------|--------|
| FPPF | Fireplace - Prefabricated | 0 | | 1 2025 | 1 | 7,141.75 | | 7,142 |
| PRCH | Slab Porch - Covered | 159805 | 9x5 | | 45 | 36.52 | | 1,643 |
| PRCH | Porch | 159806 | 363 | | 363 | 34.99 | | 12,701 |



Rogers
Assessment Property Record Card for Tax Year 2026

Data provided by LISA DELOZIER County Assessor

Date 04/18/2026
 Time 10:31:13
 Page 3

Sketch Image

660105613

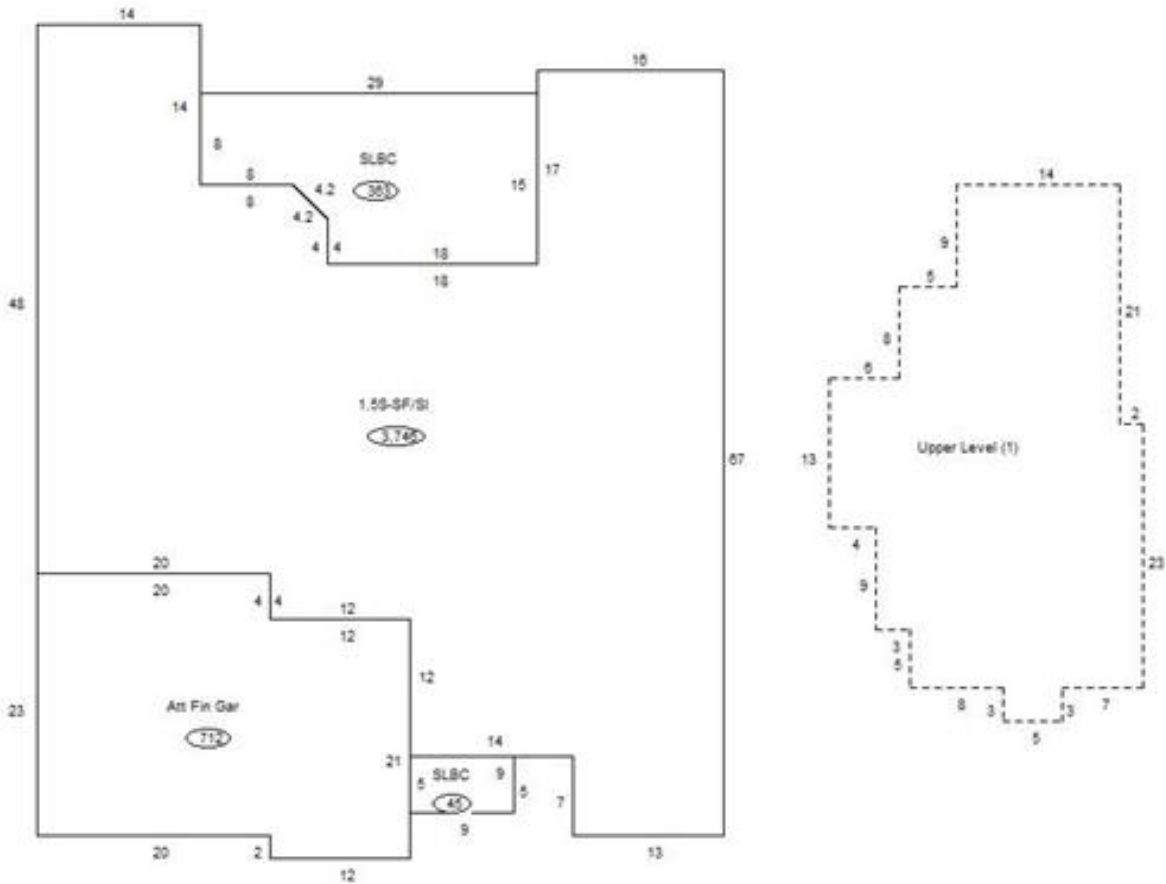

Sketch Vector Information

| Sequence | Code | Type | Built Over | Scale | Section Label | Base Area | Multiplier | Total Area |
|----------------------------|------|------|------------|-------|-----------------|--------------|------------|--------------|
| 1 | R | 5 | Slab | 13 | 1.5S-SF/SI | 2,803 | 1.336 | 3,746 |
| 2 | U | ^UL | | 13 | Upper Level (1) | 943 | 1.000 | 943 |
| 3 | G | 5 | | 13 | Att Fin Gar | 712 | 1.000 | 712 |
| 4 | M | PRCH | | 13 | SLBC | 45 | 1.000 | 45 |
| 5 | M | PRCH | | 13 | SLBC | 363 | 1.000 | 363 |
| Total Building Area | | | | | | 2,803 | | 3,746 |