



# Rogers

## Assessment Property Record Card for Tax Year 2026

Data provided by LISA DELOZIER County Assessor

Date 04/18/2026  
Time 10:32:53  
Page 1

Assessment Data					Primary Image																																												
<b>Account</b> 660105667 <b>Parcel ID</b> 000000-0012-009-0-000-00 <b>Cadastral ID</b> 27-21-14-08960 <b>Property Type</b> REAL - Real Property <b>Property Class</b> URP VI Area 4 <b>Tax Area</b> 40 - OWASSO CITY <b>Name ID</b> 336858 MOSQUEDA, MIGUEL ANGEL JR  7901 N 149TH E AVE OWASSO OK 74055-0000  <b>Parcel Location</b> <b>Situs</b> 07901 N 149TH E AVE <b>Subdivision</b> PRESLEY HOLLOW <b>Lot/Block</b> 0009 / 0012 <b>Parcel Size</b> 1 - Lots <b>Sec/Twn/Rng</b> 27 / 21 / 14 / 5 <b>Neighborhood</b> 1087 - R-V04-SW OWASSO <b>School District</b> S021 - OWASSO SCHOOLS																																																	
<b>Legal Description</b> Lot/Long: 36.26839007 -95.80702479																																																	
<b>Building Permits</b>					<table border="1"> <thead> <tr> <th>Number</th> <th>Description</th> <th>Opened</th> <th>Closed</th> <th>Amount</th> </tr> </thead> <tbody> <tr> <td>R21 0431X</td> <td>R22- NEW 2430 SQ FT SFR</td> <td>08/2021</td> <td>01/2022</td> <td>171,765</td> </tr> </tbody> </table>					Number	Description	Opened	Closed	Amount	R21 0431X	R22- NEW 2430 SQ FT SFR	08/2021	01/2022	171,765																														
Number	Description	Opened	Closed	Amount																																													
R21 0431X	R22- NEW 2430 SQ FT SFR	08/2021	01/2022	171,765																																													
<b>Exemptions</b>					<b>Sale History</b>																																												
<table border="1"> <thead> <tr> <th>Code</th> <th>Type</th> <th>Active</th> <th>Maximum</th> <th>Exemption</th> </tr> </thead> <tbody> <tr> <td></td> <td></td> <td></td> <td></td> <td></td> </tr> </tbody> </table>					Code	Type	Active	Maximum	Exemption						<table border="1"> <thead> <tr> <th>Bk/Pg</th> <th>Grantor</th> <th>Date</th> <th>Price</th> <th>Code</th> </tr> </thead> <tbody> <tr> <td>/</td> <td>EXECUTIVE HOMES LLC</td> <td>12/17/2021</td> <td>361,000</td> <td>YES</td> </tr> <tr> <td>/</td> <td>BLUE CHIP LAND CO LLC</td> <td>06/11/2021</td> <td>0</td> <td>WB</td> </tr> </tbody> </table>					Bk/Pg	Grantor	Date	Price	Code	/	EXECUTIVE HOMES LLC	12/17/2021	361,000	YES	/	BLUE CHIP LAND CO LLC	06/11/2021	0	WB															
Code	Type	Active	Maximum	Exemption																																													
Bk/Pg	Grantor	Date	Price	Code																																													
/	EXECUTIVE HOMES LLC	12/17/2021	361,000	YES																																													
/	BLUE CHIP LAND CO LLC	06/11/2021	0	WB																																													
<b>Parcel Valuation</b>																																																	
<table border="1"> <thead> <tr> <th>Source</th> <th>REAL</th> </tr> </thead> <tbody> <tr> <td>Remove Cap</td> <td>2022</td> </tr> </tbody> </table>		Source	REAL	Remove Cap	2022	<table border="1"> <thead> <tr> <th>Fair Cash</th> <th>Capped</th> <th>Asmnt Level</th> <th>Assessed</th> </tr> </thead> <tbody> <tr> <td>Land Value</td> <td>50,526</td> <td>50,526</td> <td>5,558</td> </tr> <tr> <td>Improvements</td> <td>358,401</td> <td>358,401</td> <td>39,424</td> </tr> <tr> <td>Uncapped Value</td> <td>0</td> <td>0</td> <td>0</td> </tr> <tr> <td>TIF Project ID</td> <td>0</td> <td></td> <td></td> </tr> <tr> <td><b>Total Value</b></td> <td><b>408,927</b></td> <td><b>408,927</b></td> <td><b>44,982</b></td> </tr> </tbody> </table>			Fair Cash	Capped	Asmnt Level	Assessed	Land Value	50,526	50,526	5,558	Improvements	358,401	358,401	39,424	Uncapped Value	0	0	0	TIF Project ID	0			<b>Total Value</b>	<b>408,927</b>	<b>408,927</b>	<b>44,982</b>	<table border="1"> <thead> <tr> <th>Levy Rate</th> <th>Current Tax</th> </tr> </thead> <tbody> <tr> <td>97.960</td> <td>4,406.44</td> </tr> <tr> <td><b>Assessed</b></td> <td><b>44,982</b></td> </tr> <tr> <td><b>Penalty</b></td> <td><b>0</b></td> </tr> <tr> <td><b>Exemption</b></td> <td><b>0</b></td> </tr> <tr> <td><b>Total Taxable</b></td> <td><b>44,982</b></td> </tr> </tbody> </table>		Levy Rate	Current Tax	97.960	4,406.44	<b>Assessed</b>	<b>44,982</b>	<b>Penalty</b>	<b>0</b>	<b>Exemption</b>	<b>0</b>	<b>Total Taxable</b>	<b>44,982</b>			
Source	REAL																																																
Remove Cap	2022																																																
Fair Cash	Capped	Asmnt Level	Assessed																																														
Land Value	50,526	50,526	5,558																																														
Improvements	358,401	358,401	39,424																																														
Uncapped Value	0	0	0																																														
TIF Project ID	0																																																
<b>Total Value</b>	<b>408,927</b>	<b>408,927</b>	<b>44,982</b>																																														
Levy Rate	Current Tax																																																
97.960	4,406.44																																																
<b>Assessed</b>	<b>44,982</b>																																																
<b>Penalty</b>	<b>0</b>																																																
<b>Exemption</b>	<b>0</b>																																																
<b>Total Taxable</b>	<b>44,982</b>																																																
<b>Assessment History</b>																																																	
<table border="1"> <thead> <tr> <th>Tax Year</th> <th>Statement Number</th> <th>Billed Owner</th> <th>Tax Area</th> <th>Total Value</th> <th>Exemptions</th> <th>Taxable Value</th> <th>Billed Tax</th> </tr> </thead> <tbody> <tr> <td>2025</td> <td>2025-660105667</td> <td>MOSQUEDA, MIGUEL ANGEL JR</td> <td>40</td> <td>397,813</td> <td>0</td> <td>43,760</td> <td>4,287.00</td> </tr> <tr> <td>2024</td> <td>2024-660105667</td> <td>MOSQUEDA, MIGUEL ANGEL JR</td> <td>40</td> <td>422,406</td> <td>0</td> <td>41,696</td> <td>4,006.00</td> </tr> <tr> <td>2023</td> <td>2023-660105667</td> <td>MOSQUEDA, MIGUEL ANGEL JR</td> <td>40</td> <td>361,000</td> <td>0</td> <td>39,710</td> <td>3,721.00</td> </tr> <tr> <td>2022</td> <td>2022-660105667</td> <td>MOSQUEDA, MIGUEL ANGEL JR</td> <td>40</td> <td>361,000</td> <td>0</td> <td>39,710</td> <td>3,890.00</td> </tr> </tbody> </table>										Tax Year	Statement Number	Billed Owner	Tax Area	Total Value	Exemptions	Taxable Value	Billed Tax	2025	2025-660105667	MOSQUEDA, MIGUEL ANGEL JR	40	397,813	0	43,760	4,287.00	2024	2024-660105667	MOSQUEDA, MIGUEL ANGEL JR	40	422,406	0	41,696	4,006.00	2023	2023-660105667	MOSQUEDA, MIGUEL ANGEL JR	40	361,000	0	39,710	3,721.00	2022	2022-660105667	MOSQUEDA, MIGUEL ANGEL JR	40	361,000	0	39,710	3,890.00
Tax Year	Statement Number	Billed Owner	Tax Area	Total Value	Exemptions	Taxable Value	Billed Tax																																										
2025	2025-660105667	MOSQUEDA, MIGUEL ANGEL JR	40	397,813	0	43,760	4,287.00																																										
2024	2024-660105667	MOSQUEDA, MIGUEL ANGEL JR	40	422,406	0	41,696	4,006.00																																										
2023	2023-660105667	MOSQUEDA, MIGUEL ANGEL JR	40	361,000	0	39,710	3,721.00																																										
2022	2022-660105667	MOSQUEDA, MIGUEL ANGEL JR	40	361,000	0	39,710	3,890.00																																										



# Rogers

## Assessment Property Record Card for Tax Year 2026

Data provided by LISA DELOZIER County Assessor

Date 04/18/2026  
 Time 10:32:53  
 Page 2

Lot Data		Square-Foot - NBHD 1087 #1	
Lot Size	0	0	
Lot Count	1		
Units Buildable			
Non-Ag Acres	0.1933		
Topography			
Street Access			
Utilities			
Amenities			0
			0
Method	Square-Foot		
Base Lot Value	8,421.00 x 6.00 = 50,526		
Factor Value			
Adjustments	1.0000		
Lot Value	50,526		



Residential Data	
Type	1 Single Family Residence
Condition	4 - Good
Quality	3.5 - Average
Architecture	
Style	100% One Story
Exterior Wall	100% Veneer, Masonry
Base/Total Area	2,462 / 2,462
Style	100% One Story
HVAC	100% Warmed & Cooled Air
Roof Cover	1 Composition Shingle
Area on Slab	2,462
Fixture/RghIn	/
Bed/F/H Bath	3 / 2.0 / 1.0
Basement Area	
Garage Type	694 Attached Garage - Finished
Remodel	
Year/Eff Age	2021 / 4

### GRM Approach

GRM Code	
Gross Rent	0.00
Indicated Value	

### Multiple Regression

MRA Code	1	Test
Adusted R	0.8445	
Indicated Value	358,750	145.71 Per SqFt

### Direct Comparables

Selection Model	A	Adam Test
Adjustment Model	1	2022 Residential
Comparables	5	
Indicated Value	498,140	Per SqFt

### Value Reconciliation

Selected Approach	Cost Approach		
Improvements	358,401		
Lot Value	50,526		
Indicated Value	408,927	166.10	Per SqFt
Agland Value			
Site Improvements			
Total Value	408,927	166.10	Total Value Per SqFt

### Cost Approach Manual : 01/2025

Base Cost	108.91	Total Misc Impr	+	16,416
Roofing Adj	+ 5.18	Garage Cost	+	32,549
Subfloor Adj	+ -3.39	Total RCN	=	373,334
Heat/Cool Adj	+ 14.47	Depreciation ( 4%)	-	14,933
Plumbing Adj	+ 6.58	Lump Sums	+	0
Basement Adj	+ 0.00	RCNLD	=	358,401
Adj Base Cost	= 131.75	Lot Value	+	50,526
Total Area	x 2,462	Indicated Value	=	408,927
Adjusted Cost	= 324,369	Value Per SqFt		166.10

### Miscellaneous Improvements

Code	Description	Sketch ID	Size	Year	Units	Unit Cost	Depr	Value
PRCH	Slab Porch - Covered	152901	314		314	28.43		8,927
PRCH	Slab Porch - Covered	152902	6x6		36	29.42		1,059
FPR1	Fireplace - Residential 1 Story			1	1	6,429.63		6,430



# Rogers

## Assessment Property Record Card for Tax Year 2026

Data provided by LISA DELOZIER County Assessor

Date 04/18/2026

Time 10:32:53

Page 3

Sketch Image

660105667

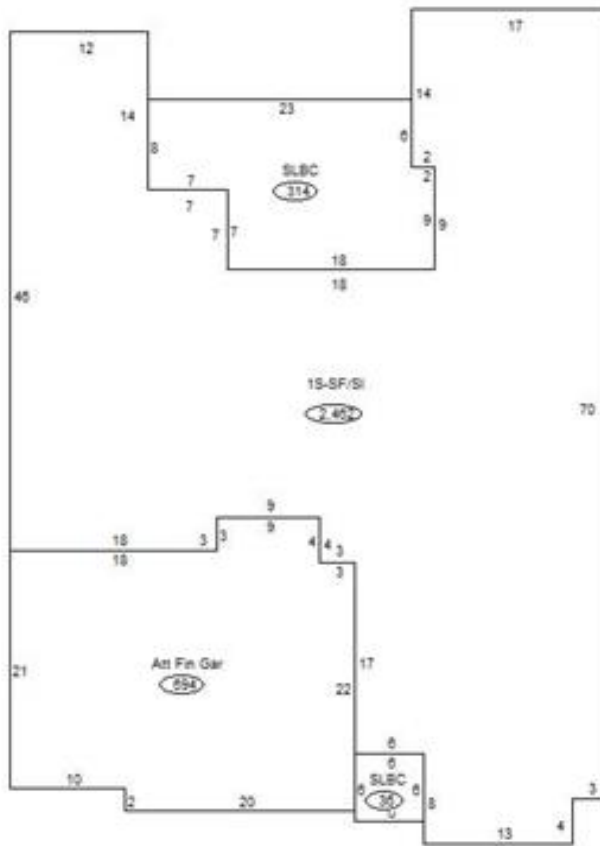

### Sketch Vector Information

Sequence	Code	Type	Built Over	Scale	Section Label	Base Area	Multiplier	Total Area
1	R	1	Slab	13	1S-SF/SI	2,462	1.000	2,462
2	G	5		13	Att Fin Gar	694	1.000	694
3	M	PRCH		13	SLBC	314	1.000	314
4	M	PRCH		13	SLBC	36	1.000	36
<b>Total Building Area</b>						<b>2,462</b>		<b>2,462</b>