



Rogers

Assessment Property Record Card for Tax Year 2026

Data provided by LISA DELOZIER County Assessor

Date 04/18/2026
Time 10:43:17
Page 1

Assessment Data					Primary Image																																												
Account 660106239 Parcel ID 000000-0-0-00859-009-0001 Cadastral ID 24-20-14-04330 Property Type REAL - Real Property Property Class URP VI Area 3 Tax Area 1 - CATOOSA OT Name ID 339321 MYERS, JACOB P & SHAUNA M 18493 E ROUND MOUNTAIN RD CATOOSA OK 74015-0000 Parcel Location Situs 18493 ROUND MOUNTAIN RD Subdivision VALE AT REDBUD PHASE II Lot/Block 0001 / 0009 Parcel Size 1 - Lots Sec/Twn/Rng 24 / 20 / 14 / 5 Neighborhood 1135 - R-V01-NW CATOOSA School District S002 - CATOOSA SCHOOLS																																																	
Legal Description Lot/Long: 36.20217715 -95.76373826																																																	
Building Permits					<table border="1"> <thead> <tr> <th>Number</th> <th>Description</th> <th>Opened</th> <th>Closed</th> <th>Amount</th> </tr> </thead> <tbody> <tr> <td>R22 171378</td> <td>R23 NEW SFR</td> <td>02/2022</td> <td>09/2022</td> <td>400,000</td> </tr> </tbody> </table>					Number	Description	Opened	Closed	Amount	R22 171378	R23 NEW SFR	02/2022	09/2022	400,000																														
Number	Description	Opened	Closed	Amount																																													
R22 171378	R23 NEW SFR	02/2022	09/2022	400,000																																													
Exemptions					Sale History																																												
<table border="1"> <thead> <tr> <th>Code</th> <th>Type</th> <th>Active</th> <th>Maximum</th> <th>Exemption</th> </tr> </thead> <tbody> <tr> <td></td> <td></td> <td></td> <td></td> <td></td> </tr> </tbody> </table>					Code	Type	Active	Maximum	Exemption						<table border="1"> <thead> <tr> <th>Bk/Pg</th> <th>Grantor</th> <th>Date</th> <th>Price</th> <th>Code</th> </tr> </thead> <tbody> <tr> <td>/</td> <td>HIGGINS HOMES LLC</td> <td>08/18/2022</td> <td>459,000</td> <td>YES</td> </tr> <tr> <td>/</td> <td>THE VALE AT REDBUD LLC</td> <td>03/04/2022</td> <td>80,000</td> <td>15</td> </tr> </tbody> </table>					Bk/Pg	Grantor	Date	Price	Code	/	HIGGINS HOMES LLC	08/18/2022	459,000	YES	/	THE VALE AT REDBUD LLC	03/04/2022	80,000	15															
Code	Type	Active	Maximum	Exemption																																													
Bk/Pg	Grantor	Date	Price	Code																																													
/	HIGGINS HOMES LLC	08/18/2022	459,000	YES																																													
/	THE VALE AT REDBUD LLC	03/04/2022	80,000	15																																													
Parcel Valuation																																																	
<table border="1"> <thead> <tr> <th>Source</th> <th>REAL</th> </tr> </thead> <tbody> <tr> <td>Remove Cap</td> <td>2023</td> </tr> </tbody> </table>		Source	REAL	Remove Cap	2023	<table border="1"> <thead> <tr> <th>Fair Cash</th> <th>Capped</th> <th>Asmnt Level</th> <th>Assessed</th> </tr> </thead> <tbody> <tr> <td>Land Value</td> <td>164,258</td> <td>164,258</td> <td>11%</td> </tr> <tr> <td>Improvements</td> <td>341,687</td> <td>341,687</td> <td></td> </tr> <tr> <td>Mobile Home</td> <td>0</td> <td>0</td> <td>0</td> </tr> <tr> <td>Total Value</td> <td>505,945</td> <td>505,945</td> <td>55,654</td> </tr> </tbody> </table>			Fair Cash	Capped	Asmnt Level	Assessed	Land Value	164,258	164,258	11%	Improvements	341,687	341,687		Mobile Home	0	0	0	Total Value	505,945	505,945	55,654	<table border="1"> <thead> <tr> <th>Levy Rate</th> <th>Current Tax</th> </tr> </thead> <tbody> <tr> <td>106.660</td> <td>5,936.06</td> </tr> <tr> <td>Assessed</td> <td>55,654</td> </tr> <tr> <td>Penalty</td> <td>0</td> </tr> <tr> <td>Exemption</td> <td>0</td> </tr> <tr> <td>Total Taxable</td> <td>55,654</td> </tr> </tbody> </table>		Levy Rate	Current Tax	106.660	5,936.06	Assessed	55,654	Penalty	0	Exemption	0	Total Taxable	55,654							
Source	REAL																																																
Remove Cap	2023																																																
Fair Cash	Capped	Asmnt Level	Assessed																																														
Land Value	164,258	164,258	11%																																														
Improvements	341,687	341,687																																															
Mobile Home	0	0	0																																														
Total Value	505,945	505,945	55,654																																														
Levy Rate	Current Tax																																																
106.660	5,936.06																																																
Assessed	55,654																																																
Penalty	0																																																
Exemption	0																																																
Total Taxable	55,654																																																
Assessment History																																																	
<table border="1"> <thead> <tr> <th>Tax Year</th> <th>Statement Number</th> <th>Billed Owner</th> <th>Tax Area</th> <th>Total Value</th> <th>Exemptions</th> <th>Taxable Value</th> <th>Billed Tax</th> </tr> </thead> <tbody> <tr> <td>2025</td> <td>2025-660106239</td> <td>MYERS, JACOB P & SHAUNA M</td> <td>1</td> <td>490,489</td> <td>0</td> <td>53,953</td> <td>5,755.00</td> </tr> <tr> <td>2024</td> <td>2024-660106239</td> <td>MYERS, JACOB P & SHAUNA M</td> <td>1</td> <td>488,473</td> <td>0</td> <td>53,015</td> <td>5,593.00</td> </tr> <tr> <td>2023</td> <td>2023-660106239</td> <td>MYERS, JACOB P & SHAUNA M</td> <td>1</td> <td>459,000</td> <td>0</td> <td>50,490</td> <td>5,182.00</td> </tr> <tr> <td>2022</td> <td>2022-660106239</td> <td>MYERS, JACOB P & SHAUNA M</td> <td>1</td> <td>3,893</td> <td>0</td> <td>428</td> <td>43.00</td> </tr> </tbody> </table>										Tax Year	Statement Number	Billed Owner	Tax Area	Total Value	Exemptions	Taxable Value	Billed Tax	2025	2025-660106239	MYERS, JACOB P & SHAUNA M	1	490,489	0	53,953	5,755.00	2024	2024-660106239	MYERS, JACOB P & SHAUNA M	1	488,473	0	53,015	5,593.00	2023	2023-660106239	MYERS, JACOB P & SHAUNA M	1	459,000	0	50,490	5,182.00	2022	2022-660106239	MYERS, JACOB P & SHAUNA M	1	3,893	0	428	43.00
Tax Year	Statement Number	Billed Owner	Tax Area	Total Value	Exemptions	Taxable Value	Billed Tax																																										
2025	2025-660106239	MYERS, JACOB P & SHAUNA M	1	490,489	0	53,953	5,755.00																																										
2024	2024-660106239	MYERS, JACOB P & SHAUNA M	1	488,473	0	53,015	5,593.00																																										
2023	2023-660106239	MYERS, JACOB P & SHAUNA M	1	459,000	0	50,490	5,182.00																																										
2022	2022-660106239	MYERS, JACOB P & SHAUNA M	1	3,893	0	428	43.00																																										



Rogers

Assessment Property Record Card for Tax Year 2026

Data provided by LISA DELOZIER County Assessor

Date 04/18/2026
 Time 10:43:17
 Page 2

Lot Data		Square-Foot - NBHD 1135 #1	
Lot Size	0	0	
Lot Count	1		
Units Buildable			
Non-Ag Acres	0.6295		
Topography			
Street Access			
Utilities			
Amenities			0
			0
Method	Square-Foot		
Base Lot Value	27,422.00 x 5.99 = 164,258		
Factor Value			
Adjustments	1.0000		
Lot Value	164,258		



Residential Data	
Type	1 Single Family Residence
Condition	3 - Average
Quality	3.5 - Average
Architecture	TRAD TRADITIONAL
Style	100% 1 1/2 Story Finished
Exterior Wall	95% Veneer, Masonry 5% Frame, Siding, Wood
Base/Total Area	1,931 / 2,487
Style	100% 1 1/2 Story Finished
HVAC	100% Warmed & Cooled Air
Roof Cover	1 Composition Shingle
Area on Slab	1,931
Fixture/RghIn	14 /
Bed/F/H Bath	4 / 3.0 / 1.0
Basement Area	
Garage Type	568 Attached Garage - Finished 3 Stalls
Remodel	
Year/Eff Age	2022 / 3

660106239_001.JPG 9/13/2025

GRM Approach	
GRM Code	
Gross Rent	0.00
Indicated Value	

Multiple Regression			
MRA Code	1	Test	
Adusted R	0.8445		
Indicated Value	352,677	141.81	Per SqFt

Direct Comparables			
Selection Model	A	Adam Test	
Adjustment Model	1	2022 Residential	
Comparables	8		
Indicated Value	436,750		Per SqFt

Cost Approach				Manual : 01/2025			
Base Cost	100.76	Total Misc Impr	+	11,953			
Roofing Adj	+ 4.21	Garage Cost	+	27,537			
Subfloor Adj	+ -2.67	Total RCN	=	352,255			
Heat/Cool Adj	+ 14.47	Depreciation (3%)	-	10,568			
Plumbing Adj	+ 8.99	Lump Sums	+	0			
Basement Adj	+ 0.00	RCNLD	=	341,687			
Adj Base Cost	= 125.76	Lot Value	+	164,258			
Total Area	x 2,487	Indicated Value	=	505,945			
Adjusted Cost	= 312,765	Value Per SqFt		203.44			

Value Reconciliation			
Selected Approach	Cost Approach		
Improvements	341,687		
Lot Value	164,258		
Indicated Value	505,945	203.44	Per SqFt
Agland Value			
Site Improvements			
Total Value	505,945	203.44	Total Value Per SqFt

Miscellaneous Improvements								
Code	Description	Sketch ID	Size	Year	Units	Unit Cost	Depr	Value
PRCH	Slab Porch - Covered	155247	118		118	29.13		3,437
PRCH	Slab Porch - Covered	155248	23x13		299	28.48		8,516



Rogers
Assessment Property Record Card for Tax Year 2026

Data provided by LISA DELOZIER County Assessor

Date 04/18/2026
 Time 10:43:17
 Page 3

Sketch Image

660106239

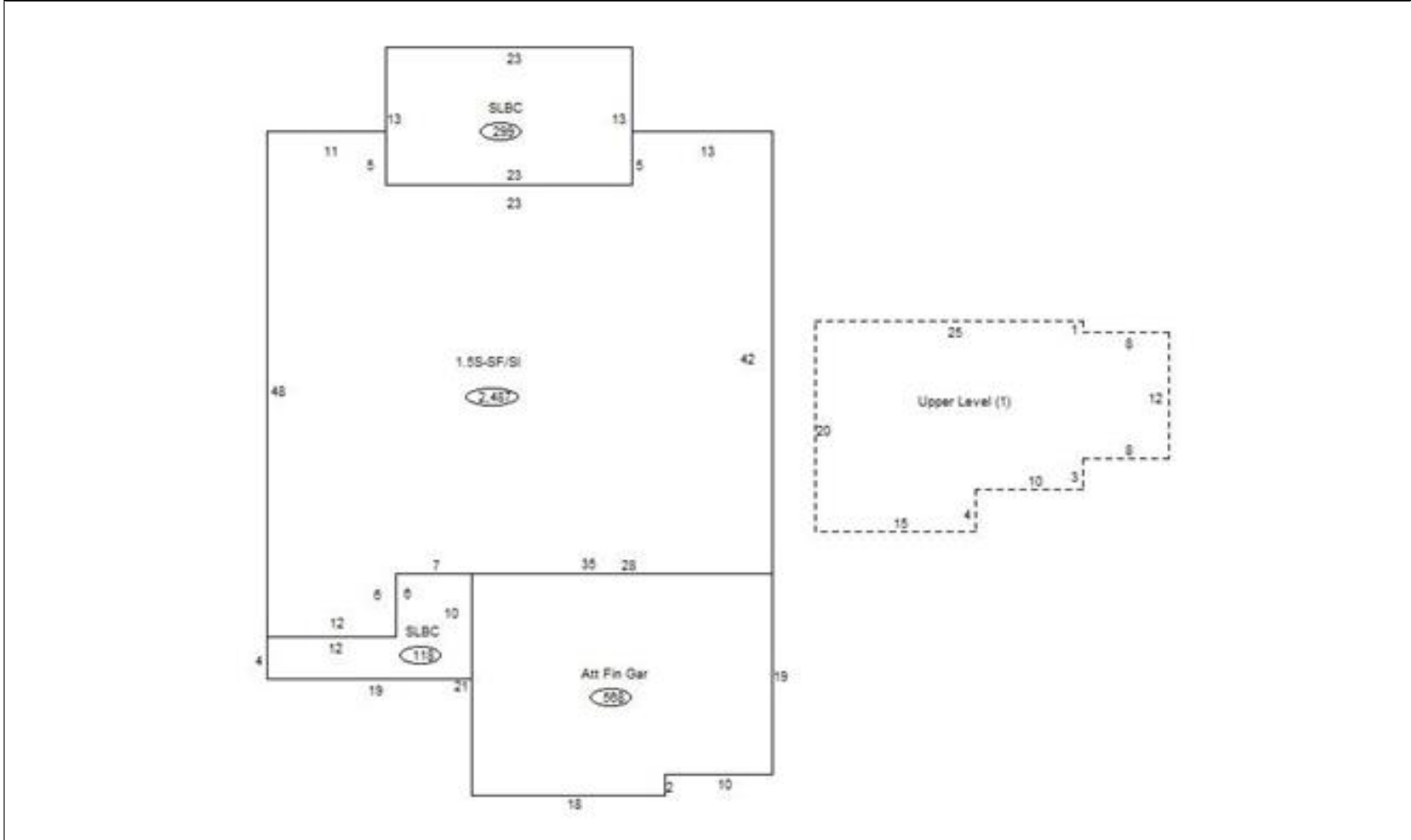

Sketch Vector Information

Sequence	Code	Type	Built Over	Scale	Section Label	Base Area	Multiplier	Total Area
1	R	5	Slab	13	1.5S-SF/SI	1,931	1.288	2,487
2	G	5		13	Att Fin Gar	568	1.000	568
3	M	PRCH		13	SLBC	118	1.000	118
4	M	PRCH		13	SLBC	299	1.000	299
5	U	^UL		13	Upper Level (1)	556	1.000	556
Total Building Area						1,931		2,487