



# Rogers

## Assessment Property Record Card for Tax Year 2026

Data provided by LISA DELOZIER County Assessor

Date 04/18/2026  
Time 10:45:54  
Page 1

Assessment Data					Primary Image																																																																
<b>Account</b> 660106328 <b>Parcel ID</b> 000000-0002-007-0-000-00 <b>Cadastral ID</b> 20-21-16-12170 <b>Property Type</b> REAL - Real Property <b>Property Class</b> URP VI Area 1 <b>Tax Area</b> 17 - CLAREMORE OT <b>Name ID</b> 339063 BRINKLEY, STEPHEN TYLER  1004 RAVEN DR CLAREMORE OK 74019-0000  <b>Parcel Location</b> <b>Situs</b> 01004 RAVEN DR <b>Subdivision</b> RED PLAINS PHASE I <b>Lot/Block</b> 0007 / 0002 Parcel Size 1 - Lots <b>Sec/Twn/Rng</b> 20 / 21 / 16 / 5 <b>Neighborhood</b> 1166 - R-V01-SW CLAREMORE <b>School District</b> S001 - CLAREMORE SCHOOLS					 <p>\\tsclient\T\LOGAN\LOGAN RESIDENTIAL VI\2023-10-5\IMG_001; 10/5/2023</p>																																																																
<b>Legal Description</b> Lot/Long: 36.28735063 -95.62004401 LOT 7 BLOCK 2 RED PLAINS PHASE I																																																																					
<b>Exemptions</b> <table border="1"> <thead> <tr> <th>Code</th> <th>Type</th> <th>Active</th> <th>Maximum</th> <th>Exemption</th> </tr> </thead> <tbody> <tr> <td></td> <td></td> <td></td> <td></td> <td></td> </tr> </tbody> </table>					Code	Type	Active	Maximum	Exemption						<b>Building Permits</b> <table border="1"> <thead> <tr> <th>Number</th> <th>Description</th> <th>Opened</th> <th>Closed</th> <th>Amount</th> </tr> </thead> <tbody> <tr> <td>R22 181</td> <td>R23 NEW SFR 1613 SQ FT</td> <td>04/2022</td> <td>08/2022</td> <td>163,000</td> </tr> </tbody> </table>					Number	Description	Opened	Closed	Amount	R22 181	R23 NEW SFR 1613 SQ FT	04/2022	08/2022	163,000																																								
Code	Type	Active	Maximum	Exemption																																																																	
Number	Description	Opened	Closed	Amount																																																																	
R22 181	R23 NEW SFR 1613 SQ FT	04/2022	08/2022	163,000																																																																	
<b>Parcel Valuation</b> <table border="1"> <thead> <tr> <th>Source</th> <th>REAL</th> <th>Fair Cash</th> <th>Capped</th> <th>Asmnt Level</th> <th>Assessed</th> <th>Levy Rate</th> <th>92.430</th> <th>Current Tax</th> </tr> </thead> <tbody> <tr> <td>Remove Cap</td> <td>2023</td> <td>Land Value</td> <td>51,545</td> <td>51,545</td> <td>11%</td> <td>5,670</td> <td>Assessed</td> <td>28,323 2,617.89</td> </tr> <tr> <td>Year Frozen</td> <td></td> <td>Improvements</td> <td>205,935</td> <td>205,935</td> <td></td> <td>22,653</td> <td>Penalty</td> <td>0</td> </tr> <tr> <td>Uncapped Value</td> <td>0</td> <td>Mobile Home</td> <td>0</td> <td>0</td> <td></td> <td>0</td> <td>Exemption</td> <td>0 0.00</td> </tr> <tr> <td>TIF Project ID</td> <td>0</td> <td>Total Value</td> <td>257,480</td> <td>257,480</td> <td></td> <td>28,323</td> <td>Total Taxable</td> <td>28,323 2,618.00</td> </tr> </tbody> </table>					Source	REAL	Fair Cash	Capped	Asmnt Level	Assessed	Levy Rate	92.430	Current Tax	Remove Cap	2023	Land Value	51,545	51,545	11%	5,670	Assessed	28,323 2,617.89	Year Frozen		Improvements	205,935	205,935		22,653	Penalty	0	Uncapped Value	0	Mobile Home	0	0		0	Exemption	0 0.00	TIF Project ID	0	Total Value	257,480	257,480		28,323	Total Taxable	28,323 2,618.00	<b>Sale History</b> <table border="1"> <thead> <tr> <th>Bk/Pg</th> <th>Grantor</th> <th>Date</th> <th>Price</th> <th>Code</th> </tr> </thead> <tbody> <tr> <td>/</td> <td>RAUSCH COLEMAN HOMES OF TULSA</td> <td>07/20/2022</td> <td>248,000</td> <td>YES</td> </tr> <tr> <td>/</td> <td>TULSA L DEV LLC</td> <td>10/06/2021</td> <td>0</td> <td>WB</td> </tr> </tbody> </table>					Bk/Pg	Grantor	Date	Price	Code	/	RAUSCH COLEMAN HOMES OF TULSA	07/20/2022	248,000	YES	/	TULSA L DEV LLC	10/06/2021	0	WB
Source	REAL	Fair Cash	Capped	Asmnt Level	Assessed	Levy Rate	92.430	Current Tax																																																													
Remove Cap	2023	Land Value	51,545	51,545	11%	5,670	Assessed	28,323 2,617.89																																																													
Year Frozen		Improvements	205,935	205,935		22,653	Penalty	0																																																													
Uncapped Value	0	Mobile Home	0	0		0	Exemption	0 0.00																																																													
TIF Project ID	0	Total Value	257,480	257,480		28,323	Total Taxable	28,323 2,618.00																																																													
Bk/Pg	Grantor	Date	Price	Code																																																																	
/	RAUSCH COLEMAN HOMES OF TULSA	07/20/2022	248,000	YES																																																																	
/	TULSA L DEV LLC	10/06/2021	0	WB																																																																	
<b>Assessment History</b> <table border="1"> <thead> <tr> <th>Tax Year</th> <th>Statement Number</th> <th>Billed Owner</th> <th>Tax Area</th> <th>Total Value</th> <th>Exemptions</th> <th>Taxable Value</th> <th>Billed Tax</th> </tr> </thead> <tbody> <tr> <td>2025</td> <td>2025-660106328</td> <td>BRINKLEY, STEPHEN TYLER</td> <td>17</td> <td>248,886</td> <td>0</td> <td>27,378</td> <td>2,531.00</td> </tr> <tr> <td>2024</td> <td>2024-660106328</td> <td>BRINKLEY, STEPHEN &amp; PATRICIA E</td> <td>17</td> <td>247,732</td> <td>0</td> <td>27,251</td> <td>2,519.00</td> </tr> <tr> <td>2023</td> <td>2023-660106328</td> <td>BRINKLEY, STEPHEN &amp; PATRICIA E</td> <td>17</td> <td>247,732</td> <td>0</td> <td>27,251</td> <td>2,496.00</td> </tr> <tr> <td>2022</td> <td>2022-660106328</td> <td>BRINKLEY, STEPHEN &amp; PATRICIA E</td> <td>17</td> <td>3,834</td> <td>0</td> <td>422</td> <td>39.00</td> </tr> </tbody> </table>					Tax Year	Statement Number	Billed Owner	Tax Area	Total Value	Exemptions	Taxable Value	Billed Tax	2025	2025-660106328	BRINKLEY, STEPHEN TYLER	17	248,886	0	27,378	2,531.00	2024	2024-660106328	BRINKLEY, STEPHEN & PATRICIA E	17	247,732	0	27,251	2,519.00	2023	2023-660106328	BRINKLEY, STEPHEN & PATRICIA E	17	247,732	0	27,251	2,496.00	2022	2022-660106328	BRINKLEY, STEPHEN & PATRICIA E	17	3,834	0	422	39.00																									
Tax Year	Statement Number	Billed Owner	Tax Area	Total Value	Exemptions	Taxable Value	Billed Tax																																																														
2025	2025-660106328	BRINKLEY, STEPHEN TYLER	17	248,886	0	27,378	2,531.00																																																														
2024	2024-660106328	BRINKLEY, STEPHEN & PATRICIA E	17	247,732	0	27,251	2,519.00																																																														
2023	2023-660106328	BRINKLEY, STEPHEN & PATRICIA E	17	247,732	0	27,251	2,496.00																																																														
2022	2022-660106328	BRINKLEY, STEPHEN & PATRICIA E	17	3,834	0	422	39.00																																																														



# Rogers

## Assessment Property Record Card for Tax Year 2026

Data provided by LISA DELOZIER County Assessor

Date 04/18/2026  
 Time 10:45:54  
 Page 2

Lot Data		Square-Foot - NBHD 1166 #1	
Lot Size	0	0	
Lot Count	1		
Units Buildable			
Non-Ag Acres	0.1766		
Topography			
Street Access			
Utilities			
Amenities	LAND QUALITY		0
			0
Method	Square-Foot		
Base Lot Value	7,694.00 x 5.74 = 44,188		
Factor Value			
Adjustments	1.1665		
Lot Value	51,545		



\\tsclient\T\LOGAN\LOGAN RESIDENTIAL VI\2023-10-5\IMG\_001: 10/5/2023

Residential Data	
Type	1 Single Family Residence
Condition	3 - Average
Quality	2.5 - Fair
Architecture	
Style	100% One Story
Exterior Wall	40% Veneer, Masonry 60% Frame, Siding, Vinyl
Base/Total Area	1,608 / 1,608
Style	100% One Story
HVAC	100% Warmed & Cooled Air
Roof Cover	1 Composition Shingle
Area on Slab	1,608
Fixture/RghIn	/
Bed/F/H Bath	4 / 2.0 /
Basement Area	
Garage Type	392 Attached Garage - Finished
Remodel	
Year/Eff Age	2022 / 3

GRM Approach	
GRM Code	
Gross Rent	0.00
Indicated Value	

Multiple Regression			
MRA Code	1	Test	
Adusted R	0.8445		
Indicated Value	221,997	138.06	Per SqFt

Direct Comparables	
Selection Model	A Adam Test
Adjustment Model	1 2022 Residential
Comparables	
Indicated Value	

Cost Approach		Manual : 01/2025	
Base Cost	99.77	Total Misc Impr	+ 3,215
Roofing Adj	+ 4.46	Garage Cost	+ 14,441
Subfloor Adj	+ -1.15	Total RCN	= 212,304
Heat/Cool Adj	+ 11.47	Depreciation ( 3%)	- 6,369
Plumbing Adj	+ 6.50	Lump Sums	+ 0
Basement Adj	+ 0.00	RCNLD	= 205,935
Adj Base Cost	= 121.05	Lot Value	+ 51,545
Total Area	x 1,608	Indicated Value	= 257,480
Adjusted Cost	= 194,648	Value Per SqFt	160.12

Value Reconciliation			
Selected Approach	Cost Approach		
Improvements	205,935		
Lot Value	51,545		
Indicated Value	257,480	160.12	Per SqFt
Agland Value			
Site Improvements			
Total Value	257,480	160.12	Total Value Per SqFt

Miscellaneous Improvements								
Code	Description	Sketch ID	Size	Year	Units	Unit Cost	Depr	Value
PRCH	Slab Porch - Covered	154878	13x8		104	23.94		2,490
PRCH	Slab Porch - Covered	154879	6x5		30	24.17		725



# Rogers

## Assessment Property Record Card for Tax Year 2026

Data provided by LISA DELOZIER County Assessor

Date 04/18/2026  
 Time 10:45:54  
 Page 3

Sketch Image

660106328

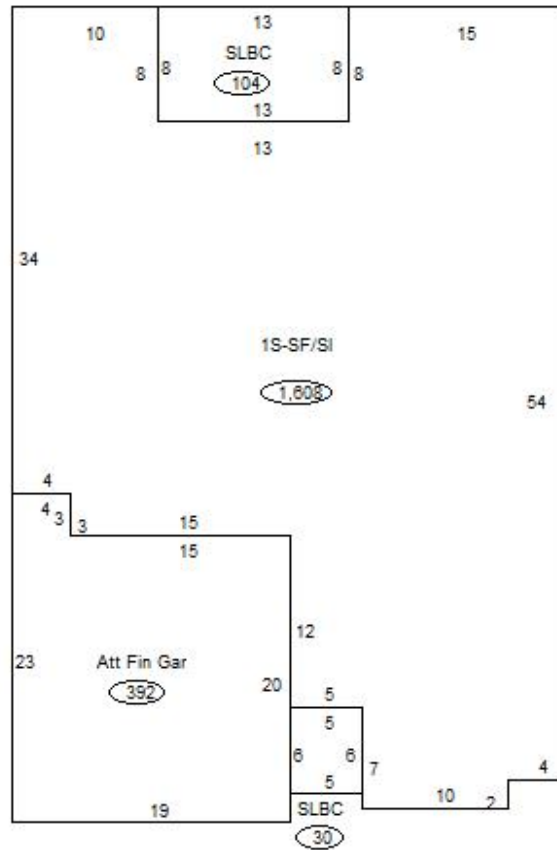

### Sketch Vector Information

Sequence	Code	Type	Built Over	Scale	Section Label	Base Area	Multiplier	Total Area
1	R	1	Slab	13	1S-SF/SI	1,608	1.000	1,608
2	G	5		13	Att Fin Gar	392	1.000	392
3	M	PRCH		13	SLBC	104	1.000	104
4	M	PRCH		13	SLBC	30	1.000	30
<b>Total Building Area</b>						1,608		1,608