



Rogers

Assessment Property Record Card for Tax Year 2026

Data provided by LISA DELOZIER County Assessor

Date 04/18/2026
 Time 10:48:21
 Page 1

Assessment Data					Primary Image				
Account 660106426 Parcel ID 24N16E-13-1-00000-001-0000 Cadastral ID 13-24-16-00220 Property Type REAL - Real Property Property Class RR VI Area 2 Tax Area 14 - CHELSEA RURAL Name ID 336694 MARSHALL, AMY C 16106 E 340 RD CHELSEA OK 74016-0000 Parcel Location Situs 15980 E 310 RD Subdivision Lot/Block / Parcel Size 2 - Acres Sec/Twn/Rng 13 / 24 / 16 / 1 Neighborhood 4050 - CHELSEA FOYIL RURAL School District S003 - CHELSEA SCHOOLS					<p>660106426_001.JPG 1/30/2025</p>				
Legal Description Lat/Long: 36.56817135 -95.54389769									
N 217' E 401.50' NE NE.					Building Permits				
					Number	Description	Opened	Closed	Amount
					R24	NEW SFR OBSERVED	05/2024	05/2024	
Exemptions					Sale History				
Code	Type	Active	Maximum	Exemption	Bk/Pg	Grantor	Date	Price	Code
H	Homestead	Yes	1,000	1,000	/	HAYES, BETTY SUE	10/18/2021	8,000	YES
Parcel Valuation									
Source	REAL		Fair Cash	Capped	Asmnt Level	Assessed	Levy Rate	82.750	Current Tax
Remove Cap	2022	Land Value	33,107	9,539	11%	1,049	Assessed	21,295	1,762.16
Year Frozen		Improvements	184,473	184,056		20,246	Penalty	0	
Uncapped Value	0	Mobile Home	0	0		0	Exemption	1,000	-83.00
TIF Project ID	0	Total Value	217,580	193,595		21,295	Total Taxable	20,295	1,679.00
Assessment History									
Tax Year	Statement Number	Billed Owner			Tax Area	Total Value	Exemptions	Taxable Value	Billed Tax
2025	2025-660106426	MARSHALL, AMY C			14	209,192	0	20,676	1,711.00
2024	2024-660106426	MARSHALL, AMY C			14	30,496	0	970	82.00
2023	2023-660106426	MARSHALL, AMY C			14	13,395	0	924	79.00
2022	2022-660106426	MARSHALL, AMY C			14	8,000	0	880	74.00



Rogers

Assessment Property Record Card for Tax Year 2026

Data provided by LISA DELOZIER County Assessor

Date 04/18/2026
 Time 10:48:22
 Page 2

Lot Data	Square-Foot - NBHD 4050 #1	Primary Image
Lot Size Lot Count Units Buildable Non-Ag Acres 2.0003 Topography Street Access Utilities Amenities LAND QUALITY 0 0 Method Square-Foot Base Lot Value 87,131.00 x .38 = 33,107 Factor Value Adjustments 1.0000 Lot Value 33,107		

Residential Data	
Type	1 Single Family Residence
Condition	3 - Average
Quality	2 - Fair
Architecture	MTL METAL HOME
Style	100% One Story
Exterior Wall	100% Frame, Siding, Metal
Base/Total Area	1,700 / 1,700
Style	100% One Story
HVAC	100% Warmed & Cooled Air
Roof Cover	4 Metal, Preformed
Area on Slab	1,700
Fixture/RghIn	/
Bed/F/H Bath	3 / 2.0 /
Basement Area	
Garage Type	400 Attached Garage - Finished
Remodel	
Year/Eff Age	2024 / 2



660106426_001.JPG 1/30/2025

GRM Approach	
GRM Code	
Gross Rent	0.00
Indicated Value	

Multiple Regression	
MRA Code	
Adjusted R	
Indicated Value	

Direct Comparables	
Selection Model	1 Res
Adjustment Model	A2 AO Test
Comparables	
Indicated Value	

Cost Approach				Manual : 01/2025			
Base Cost	80.27	Total Misc Impr	+ 0				
Roofing Adj	+ 4.23	Garage Cost	+ 12,215				
Subfloor Adj	+ 0.00	Total RCN	= 182,232				
Heat/Cool Adj	+ 10.09	Depreciation (2%)	- 3,645				
Plumbing Adj	+ 5.41	Lump Sums	+ 5,886				
Basement Adj	+ 0.00	RCNLD	= 184,473				
Adj Base Cost	= 100.01	Lot Value	+ 33,107				
Total Area	x 1,700	Indicated Value	= 217,580				
Adjusted Cost	= 170,017	Value Per SqFt	127.99				

Value Reconciliation			
Selected Approach	Cost Approach		
Improvements	184,473		
Lot Value	33,107		
Indicated Value	217,580	127.99	Per SqFt
Agland Value			
Site Improvements			
Total Value	217,580	127.99	Total Value Per SqFt

Miscellaneous Improvements							
Code	Description	Sketch ID	Size	Year	Units	Unit Cost	Depr Value
WODC	Wood Deck - Covered	160098	20x8		160	36.79	5,886



Rogers

Assessment Property Record Card for Tax Year 2026

Data provided by LISA DELOZIER County Assessor

Date 04/18/2026

Time 10:48:22

Page 3

Sketch Image

660106426

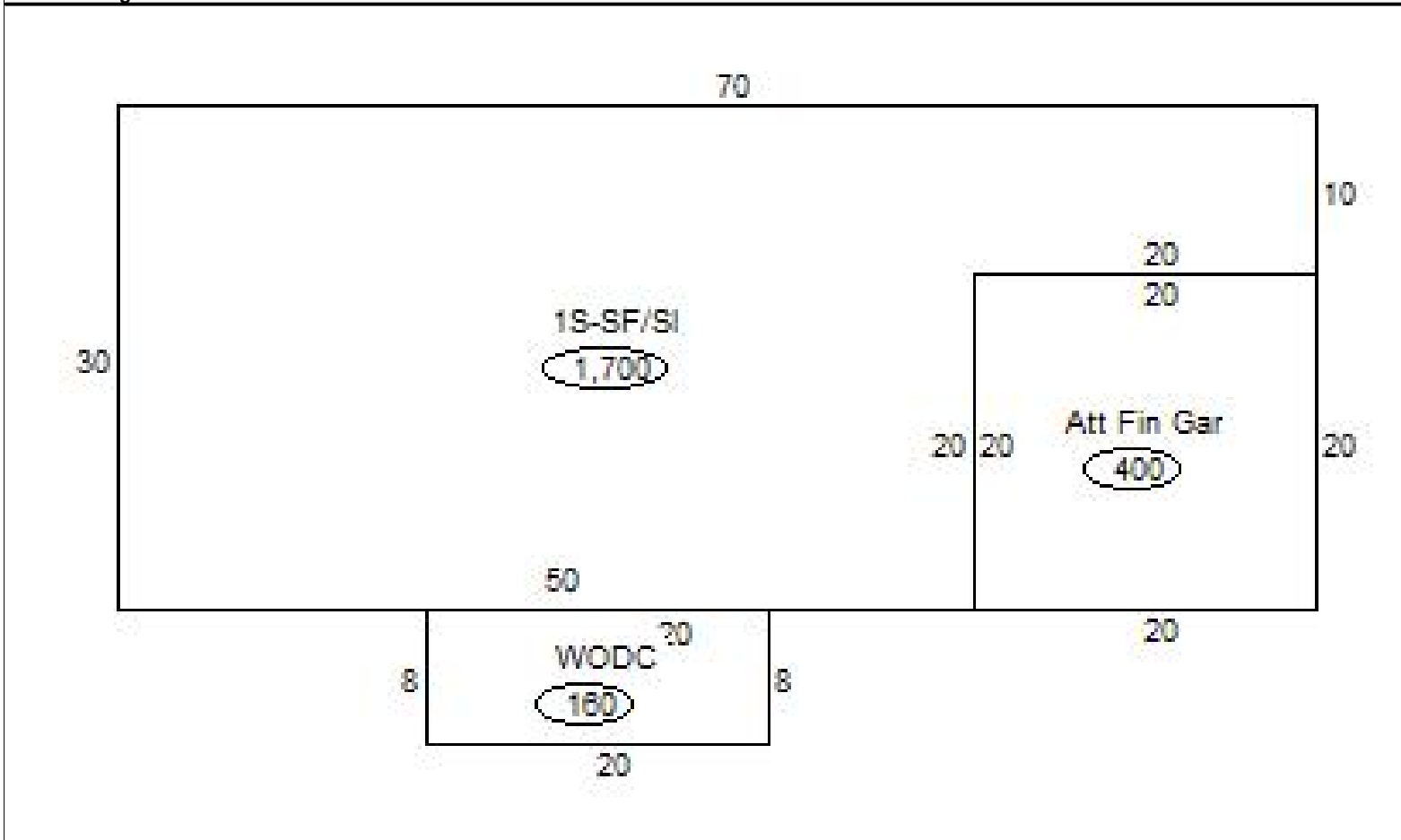

Sketch Vector Information

Sequence	Code	Type	Built Over	Scale	Section Label	Base Area	Multiplier	Total Area
1	R	1	Slab	20	1S-SF/SI	1,700	1.000	1,700
2	G	5		20	Att Fin Gar	400	1.000	400
3	M	WODC		20	WODC	160	1.000	160
Total Building Area						1,700		1,700