



# Rogers

## Assessment Property Record Card for Tax Year 2026

Data provided by LISA DELOZIER County Assessor

Date 04/18/2026  
Time 11:00:05  
Page 1

Assessment Data					Primary Image																																																					
<b>Account</b> 660107555 <b>Parcel ID</b> 23N17E-35-3-00000-001-0000 <b>Cadastral ID</b> 35-23-17-03810 <b>Property Type</b> REAL - Real Property <b>Property Class</b> RR VI Area 2 <b>Tax Area</b> 71 - CHELSEA RURAL/FOYIL FIRE <b>Name ID</b> 340116 MITCHELL, TREY & CHRISTINA  20063 E 410 RD CHELSEA OK 74016-0000  <b>Parcel Location</b> <b>Situs</b> 20063 E 410 RD <b>Subdivision</b> <b>Lot/Block</b> / <b>Parcel Size</b> 3.88 - Acres <b>Sec/Twn/Rng</b> 35 / 23 / 17 / 3 <b>Neighborhood</b> 4070 - FOYIL SEQUOYAH AREA <b>School District</b> S003 - CHELSEA SCHOOLS																																																										
<b>Legal Description</b> Lat/Long: 36.42404262 -95.46869749 TR DESC 2022-016878 AS BEG SE/C W2 SE SW SW; S88.4818W 240'; N01.4634W 230'; S88.4818W 140'; N01.4634W 300'; N88.4818E 380'; S01.4634E 530' TO POB.										<b>Building Permits</b> <table border="1"> <thead> <tr> <th>Number</th> <th>Description</th> <th>Opened</th> <th>Closed</th> <th>Amount</th> </tr> </thead> <tbody> <tr> <td>S22107557</td> <td>S23 SPLIT</td> <td>12/2022</td> <td>12/2023</td> <td></td> </tr> </tbody> </table>					Number	Description	Opened	Closed	Amount	S22107557	S23 SPLIT	12/2022	12/2023																																			
Number	Description	Opened	Closed	Amount																																																						
S22107557	S23 SPLIT	12/2022	12/2023																																																							
<b>Exemptions</b> <table border="1"> <thead> <tr> <th>Code</th> <th>Type</th> <th>Active</th> <th>Maximum</th> <th>Exemption</th> </tr> </thead> <tbody> <tr> <td>H</td> <td>Homestead</td> <td>Yes</td> <td>1,000</td> <td>1,000</td> </tr> </tbody> </table>					Code	Type	Active	Maximum	Exemption	H	Homestead	Yes	1,000	1,000	<b>Sale History</b> <table border="1"> <thead> <tr> <th>Bk/Pg</th> <th>Grantor</th> <th>Date</th> <th>Price</th> <th>Code</th> </tr> </thead> <tbody> <tr> <td>/</td> <td>MALLORY, GEORGE L &amp; PAMELA R</td> <td>10/14/2022</td> <td>287,000</td> <td>YES</td> </tr> </tbody> </table>					Bk/Pg	Grantor	Date	Price	Code	/	MALLORY, GEORGE L & PAMELA R	10/14/2022	287,000	YES																													
Code	Type	Active	Maximum	Exemption																																																						
H	Homestead	Yes	1,000	1,000																																																						
Bk/Pg	Grantor	Date	Price	Code																																																						
/	MALLORY, GEORGE L & PAMELA R	10/14/2022	287,000	YES																																																						
<b>Parcel Valuation</b> <table border="1"> <thead> <tr> <th>Source</th> <th>REAL</th> <th>Fair Cash</th> <th>Capped</th> <th>Asmnt Level</th> <th>Assessed</th> <th>Levy Rate</th> <th>95.740</th> <th>Current Tax</th> </tr> </thead> <tbody> <tr> <td>Remove Cap</td> <td>2023</td> <td>Land Value</td> <td>126,298</td> <td>126,298</td> <td>11%</td> <td>13,893</td> <td>Assessed</td> <td>33,493</td> <td>3,206.62</td> </tr> <tr> <td>Year Frozen</td> <td></td> <td>Improvements</td> <td>186,937</td> <td>178,180</td> <td></td> <td>19,600</td> <td>Penalty</td> <td>0</td> <td></td> </tr> <tr> <td>Uncapped Value</td> <td>0</td> <td>Mobile Home</td> <td>0</td> <td>0</td> <td></td> <td>0</td> <td>Exemption</td> <td>1,000</td> <td>-83.00</td> </tr> <tr> <td>TIF Project ID</td> <td>0</td> <td>Total Value</td> <td>313,235</td> <td>304,478</td> <td></td> <td>33,493</td> <td>Total Taxable</td> <td>32,493</td> <td>3,124.00</td> </tr> </tbody> </table>										Source	REAL	Fair Cash	Capped	Asmnt Level	Assessed	Levy Rate	95.740	Current Tax	Remove Cap	2023	Land Value	126,298	126,298	11%	13,893	Assessed	33,493	3,206.62	Year Frozen		Improvements	186,937	178,180		19,600	Penalty	0		Uncapped Value	0	Mobile Home	0	0		0	Exemption	1,000	-83.00	TIF Project ID	0	Total Value	313,235	304,478		33,493	Total Taxable	32,493	3,124.00
Source	REAL	Fair Cash	Capped	Asmnt Level	Assessed	Levy Rate	95.740	Current Tax																																																		
Remove Cap	2023	Land Value	126,298	126,298	11%	13,893	Assessed	33,493	3,206.62																																																	
Year Frozen		Improvements	186,937	178,180		19,600	Penalty	0																																																		
Uncapped Value	0	Mobile Home	0	0		0	Exemption	1,000	-83.00																																																	
TIF Project ID	0	Total Value	313,235	304,478		33,493	Total Taxable	32,493	3,124.00																																																	
<b>Assessment History</b> <table border="1"> <thead> <tr> <th>Tax Year</th> <th>Statement Number</th> <th>Billed Owner</th> <th>Tax Area</th> <th>Total Value</th> <th>Exemptions</th> <th>Taxable Value</th> <th>Billed Tax</th> </tr> </thead> <tbody> <tr> <td>2025</td> <td>2025-660107555</td> <td>MITCHELL, TREY &amp; CHRISTINA</td> <td>71</td> <td>309,227</td> <td>1000</td> <td>31,518</td> <td>3,030.00</td> </tr> <tr> <td>2024</td> <td>2024-660107555</td> <td>MITCHELL, TREY &amp; CHRISTINA</td> <td>71</td> <td>287,000</td> <td>1000</td> <td>30,571</td> <td>2,997.00</td> </tr> <tr> <td>2023</td> <td>2023-660107555</td> <td>MITCHELL, TREY &amp; CHRISTINA</td> <td>71</td> <td>287,000</td> <td>1000</td> <td>30,570</td> <td>3,028.00</td> </tr> </tbody> </table>										Tax Year	Statement Number	Billed Owner	Tax Area	Total Value	Exemptions	Taxable Value	Billed Tax	2025	2025-660107555	MITCHELL, TREY & CHRISTINA	71	309,227	1000	31,518	3,030.00	2024	2024-660107555	MITCHELL, TREY & CHRISTINA	71	287,000	1000	30,571	2,997.00	2023	2023-660107555	MITCHELL, TREY & CHRISTINA	71	287,000	1000	30,570	3,028.00																	
Tax Year	Statement Number	Billed Owner	Tax Area	Total Value	Exemptions	Taxable Value	Billed Tax																																																			
2025	2025-660107555	MITCHELL, TREY & CHRISTINA	71	309,227	1000	31,518	3,030.00																																																			
2024	2024-660107555	MITCHELL, TREY & CHRISTINA	71	287,000	1000	30,571	2,997.00																																																			
2023	2023-660107555	MITCHELL, TREY & CHRISTINA	71	287,000	1000	30,570	3,028.00																																																			



# Rogers

## Assessment Property Record Card for Tax Year 2026

Data provided by LISA DELOZIER County Assessor

Date 04/18/2026  
 Time 11:00:05  
 Page 2

Lot Data		Square-Foot - NBHD 4070 #1	
Lot Size	0	0	
Lot Count	0		
Units Buildable	0		
Non-Ag Acres	0		
Topography			
Street Access			
Utilities			
Amenities	LAND QUALITY		0
			0
Method	Square-Foot		
Base Lot Value	173,222.00 x .38 = 65,086		
Factor Value			
Adjustments	1.9405		
Lot Value	126,298		



\\tsclient\C\Users\Randy Necessary\Pictures\2020-12-09\IMG\_000 12/15/2020

Residential Data	
Type	1 Single Family Residence
Condition	3 - Average
Quality	2 - Fair
Architecture	TRAD TRADITIONAL
Style	100% One Story
Exterior Wall	80% Veneer, Stone 20% Frame, Plywood or Hardt
Base/Total Area	1,863 / 1,863
Style	100% One Story
HVAC	100% Warmed & Cooled Air
Roof Cover	1 Composition Shingle
Area on Slab	1,863
Fixture/RghIn	7 /
Bed/F/H Bath	3 / 2.0 /
Basement Area	
Garage Type	650 Attached Garage - Finished
Remodel	PARTIAL -
Year/Eff Age	1985 / 21

### GRM Approach

GRM Code	
Gross Rent	0.00
Indicated Value	

### Multiple Regression

MRA Code	1 Test
Adusted R	0.8445
Indicated Value	195,361 104.86 Per SqFt

### Direct Comparables

Selection Model	1 Res
Adjustment Model	A2 AO Test
Comparables	
Indicated Value	

### Value Reconciliation

Selected Approach	Cost Approach
Improvements	172,710
Lot Value	126,298
Indicated Value	299,008 160.50 Per SqFt
Agland Value	
Site Improvements	14,227
Total Value	313,235 168.13 Total Value Per SqFt

Cost Approach		Manual : 01/2025	
Base Cost	93.12	Total Misc Impr	+ 14,626
Roofing Adj	+ 3.80	Garage Cost	+ 18,038
Subfloor Adj	+ 0.00	Total RCN	= 240,705
Heat/Cool Adj	+ 10.30	Depreciation ( 29%)	- 69,804
Plumbing Adj	+ 4.45	Lump Sums	+ 1,809
Basement Adj	+ 0.00	RCNLD	= 172,710
Adj Base Cost	= 111.67	Lot Value	+ 126,298
Total Area	x 1,863	Indicated Value	= 299,008
Adjusted Cost	= 208,041	Value Per SqFt	160.50

### Miscellaneous Improvements

Code	Description	Sketch ID	Size	Year	Units	Unit Cost	Depr	Value
FPR1	FIREPLACE - RESIDENTIAL 1 STORY	0		1	1	4,576.55		4,577
WODO	WOOD DECK - OPEN	73164		288	288	15.70	60%	1,809
CPDT	Carport - Detached	73165		32x31	992	10.13		10,049



**Rogers**  
**Assessment Property Record Card for Tax Year 2026**

Data provided by LISA DELOZIER County Assessor

Date 04/18/2026  
 Time 11:00:05  
 Page 3

Sketch Image

660107555

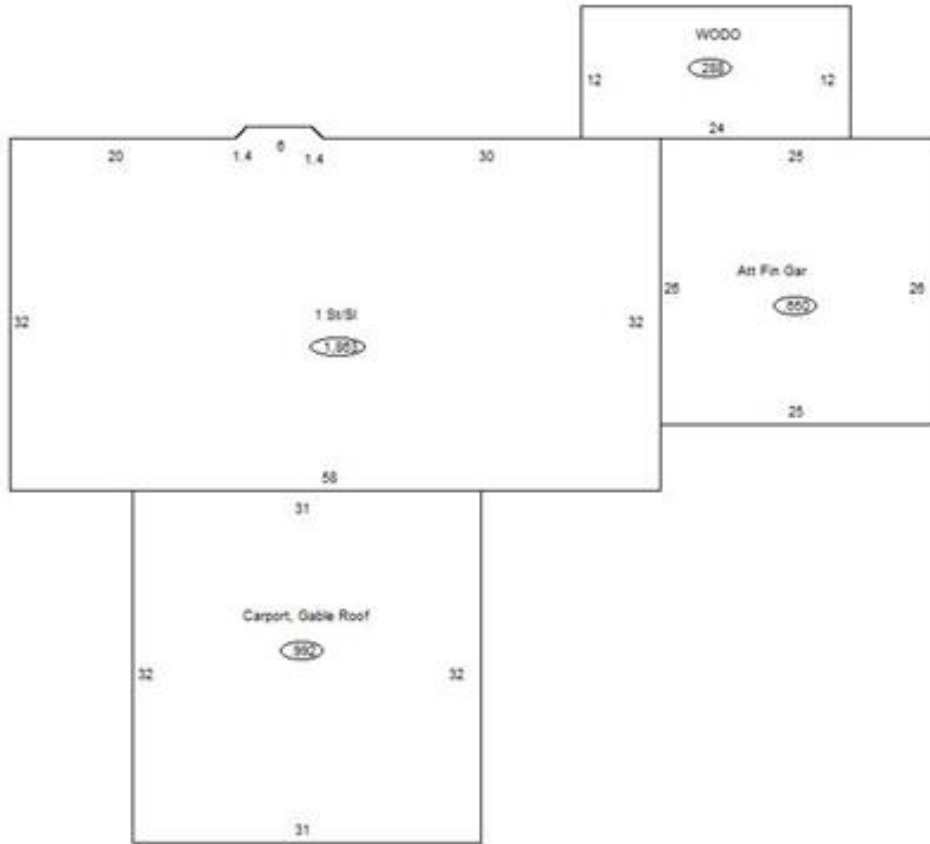

**Sketch Vector Information**

Sequence	Code	Type	Built Over	Scale	Section Label	Base Area	Multiplier	Total Area
1	R	1	Slab	13	1 St/SI	1,863	1.000	1,863
2	G	5		13	Att Fin Gar	650	1.000	650
3	M	WODO		13	WODO	288	1.000	288
4	G	3		13	Carport, Gable Roof	992	1.000	992
<b>Total Building Area</b>						1,863		1,863



# Rogers

## Assessment Property Record Card for Tax Year 2026

Data provided by LISA DELOZIER County Assessor

Date 04/18/2026  
 Time 11:00:05  
 Page 4

660107555

### Outbuildings/Site Improvements

Building Image	Code	Description	Dimensions	Floor	Roofing	Total Units
	SHDS	STG FAIR	12x24x8	Plank	Formed Metal	288
	Qual	3	Cond 3	Year 2020	Eff Age 5	
	<b>Valuation Summary</b>		<b>Modifier Total</b>	<b>RCN</b>	<b>Depr (100% Phys/ % Func)</b>	<b>RCNLD</b>
	Base Cost (22.15 x 288)		6,379	6,379	6,379	
	EQSH	Equipment Shed	20x40x10	Dirt	Formed Metal	800
	Qual	3	Cond 3	Year 2016	Eff Age 8	
	<b>Valuation Summary</b>		<b>Modifier Total</b>	<b>RCN</b>	<b>Depr (15% Phys/ % Func)</b>	<b>RCNLD</b>
	Base Cost (20.11 x 800)		16,088	16,088	2,413	13,675
	LOAF	LOAFING SHED	12x12x8	Dirt	Formed Metal	144
	Qual	2	Cond 3	Year 2016	Eff Age 8	
	<b>Valuation Summary</b>		<b>Modifier Total</b>	<b>RCN</b>	<b>Depr (37% Phys/ % Func)</b>	<b>RCNLD</b>
	Base Cost (6.08 x 144)		876	876	324	552