



# Rogers

## Assessment Property Record Card for Tax Year 2026

Data provided by LISA DELOZIER County Assessor

Date 04/18/2026  
Time 11:01:36  
Page 1

Assessment Data	Primary Image																									
<b>Account</b> 660107610 <b>Parcel ID</b> 000000-0003-016-0-000-00 <b>Cadastral ID</b> 05-21-16-18970 <b>Property Type</b> REAL - Real Property <b>Property Class</b> URP VI Area 1 <b>Tax Area</b> 17 - CLAREMORE OT <b>Name ID</b> 345122 MCELHANEY, TAYLOR ANN & KALA  1307 STONEBROOK ST CLAREMORE OK 74017-0000  <b>Parcel Location</b> <b>Situs</b> 01307 STONEBROOK ST <b>Subdivision</b> ESTATES AT STONE CREEK <b>Lot/Block</b> 0016 / 0003 Parcel Size 1 - Lots <b>Sec/Twn/Rng</b> 5 / 21 / 16 / 5 <b>Neighborhood</b> 1154 - R-V01-NW CLAREMORE <b>School District</b> S001 - CLAREMORE SCHOOLS	 <p>660107610_001.JPG 9/25/2024</p>																									
<b>Legal Description</b> Lat/Long: 36.33447679 -95.62310413 LOT 16 BLOCK 3 ESTATES AT STONE CREEK	<b>Building Permits</b> <table border="1"> <thead> <tr> <th>Number</th> <th>Description</th> <th>Opened</th> <th>Closed</th> <th>Amount</th> </tr> </thead> <tbody> <tr> <td>R24 037</td> <td>NEW SFR 1796 SQ FT</td> <td>04/2024</td> <td>09/2024</td> <td>160,000</td> </tr> </tbody> </table>	Number	Description	Opened	Closed	Amount	R24 037	NEW SFR 1796 SQ FT	04/2024	09/2024	160,000															
Number	Description	Opened	Closed	Amount																						
R24 037	NEW SFR 1796 SQ FT	04/2024	09/2024	160,000																						
<b>Exemptions</b> <table border="1"> <thead> <tr> <th>Code</th> <th>Type</th> <th>Active</th> <th>Maximum</th> <th>Exemption</th> </tr> </thead> <tbody> <tr> <td></td> <td></td> <td></td> <td></td> <td></td> </tr> </tbody> </table>	Code	Type	Active	Maximum	Exemption						<b>Sale History</b> <table border="1"> <thead> <tr> <th>Bk/Pg</th> <th>Grantor</th> <th>Date</th> <th>Price</th> <th>Code</th> </tr> </thead> <tbody> <tr> <td>/</td> <td>D.R. HORTON-TEXAS LTD LP</td> <td>08/15/2024</td> <td>275,000</td> <td>YES</td> </tr> <tr> <td>/</td> <td>RLM CONSTRUCTION CO INC</td> <td>03/15/2024</td> <td>288,000</td> <td>WB</td> </tr> </tbody> </table>	Bk/Pg	Grantor	Date	Price	Code	/	D.R. HORTON-TEXAS LTD LP	08/15/2024	275,000	YES	/	RLM CONSTRUCTION CO INC	03/15/2024	288,000	WB
Code	Type	Active	Maximum	Exemption																						
Bk/Pg	Grantor	Date	Price	Code																						
/	D.R. HORTON-TEXAS LTD LP	08/15/2024	275,000	YES																						
/	RLM CONSTRUCTION CO INC	03/15/2024	288,000	WB																						

Parcel Valuation									
Source	REAL		Fair Cash	Capped	Asmnt Level	Assessed	Levy Rate	92.430	Current Tax
Remove Cap	2025	Land Value	40,000	40,000	11%	4,400	Assessed	32,371	2,992.05
Year Frozen		Improvements	254,278	254,278		27,971	Penalty	0	
Uncapped Value	0	Mobile Home	0	0		0	Exemption	0	0.00
TIF Project ID	0	Total Value	294,278	294,278		32,371	Total Taxable	32,371	2,992.00
Assessment History									
Tax Year	Statement Number	Billed Owner	Tax Area	Total Value	Exemptions	Taxable Value	Billed Tax		
2025	2025-660107610	MCELHANEY, TAYLOR ANN &	17	286,123	0	31,474	2,909.00		
2024	2024-660107610	MCELHANEY, TAYLOR ANN &	17	4,792	0	527	49.00		
2023	2023-660107610	RLM CONSTRUCTION CO INC	17	4,792	0	527	48.00		



# Rogers

## Assessment Property Record Card for Tax Year 2026

Data provided by LISA DELOZIER County Assessor

Date 04/18/2026  
 Time 11:01:37  
 Page 2

Lot Data		Lot - ESTATES AT STONE CREEK	
Lot Size	0	0	
Lot Count	1		
Units Buildable			
Non-Ag Acres	0.23		
Topography			
Street Access			
Utilities			
Amenities	LOT SIZE ADJUSTMENT		0
			0
Method	Lot		
Base Lot Value	1.00 x 40,000.00 = 40,000		
Factor Value			
Adjustments	1.0000		
Lot Value	40,000		



660107610\_001.JPG 9/25/2024

Residential Data	
Type	1 Single Family Residence
Condition	3 - Average
Quality	3 - Average
Architecture	
Style	100% One Story
Exterior Wall	75% Veneer, Masonry 25% Veneer, Stone
Base/Total Area	1,798 / 1,798
Style	100% One Story
HVAC	100% Warmed & Cooled Air
Roof Cover	1 Composition Shingle
Area on Slab	1,798
Fixture/RghIn	/
Bed/F/H Bath	4 / 2.0 /
Basement Area	
Garage Type	400 Attached Garage - Finished
Remodel	
Year/Eff Age	2024 / 2

GRM Approach	
GRM Code	
Gross Rent	0.00
Indicated Value	

Multiple Regression	
MRA Code	
Adjusted R	
Indicated Value	

Direct Comparables	
Selection Model	A Adam Test
Adjustment Model	1 2022 Residential
Comparables	3
Indicated Value	271,460 Per SqFt

Cost Approach		Manual : 01/2025	
Base Cost	111.32	Total Misc Impr	+ 3,579
Roofing Adj	+ 4.81	Garage Cost	+ 17,024
Subfloor Adj	+ -2.31	Total RCN	= 259,467
Heat/Cool Adj	+ 12.64	Depreciation ( 2%)	- 5,189
Plumbing Adj	+ 6.39	Lump Sums	+ 0
Basement Adj	+ 0.00	RCNLD	= 254,278
Adj Base Cost	= 132.85	Lot Value	+ 40,000
Total Area	x 1,798	Indicated Value	= 294,278
Adjusted Cost	= 238,864	Value Per SqFt	163.67

Value Reconciliation			
Selected Approach	Cost Approach		
Improvements	254,278		
Lot Value	40,000		
Indicated Value	294,278	163.67	Per SqFt
Agland Value			
Site Improvements			
Total Value	294,278	163.67	Total Value Per SqFt

Miscellaneous Improvements								
Code	Description	Sketch ID	Size	Year	Units	Unit Cost	Depr	Value
PRCH	Porch	161316	9x6		54	26.76		1,445
PRCH	Porch	161317	10x8		80	26.68		2,134



# Rogers

## Assessment Property Record Card for Tax Year 2026

Data provided by LISA DELOZIER County Assessor

Date 04/18/2026

Time 11:01:37

Page 3

Sketch Image

660107610

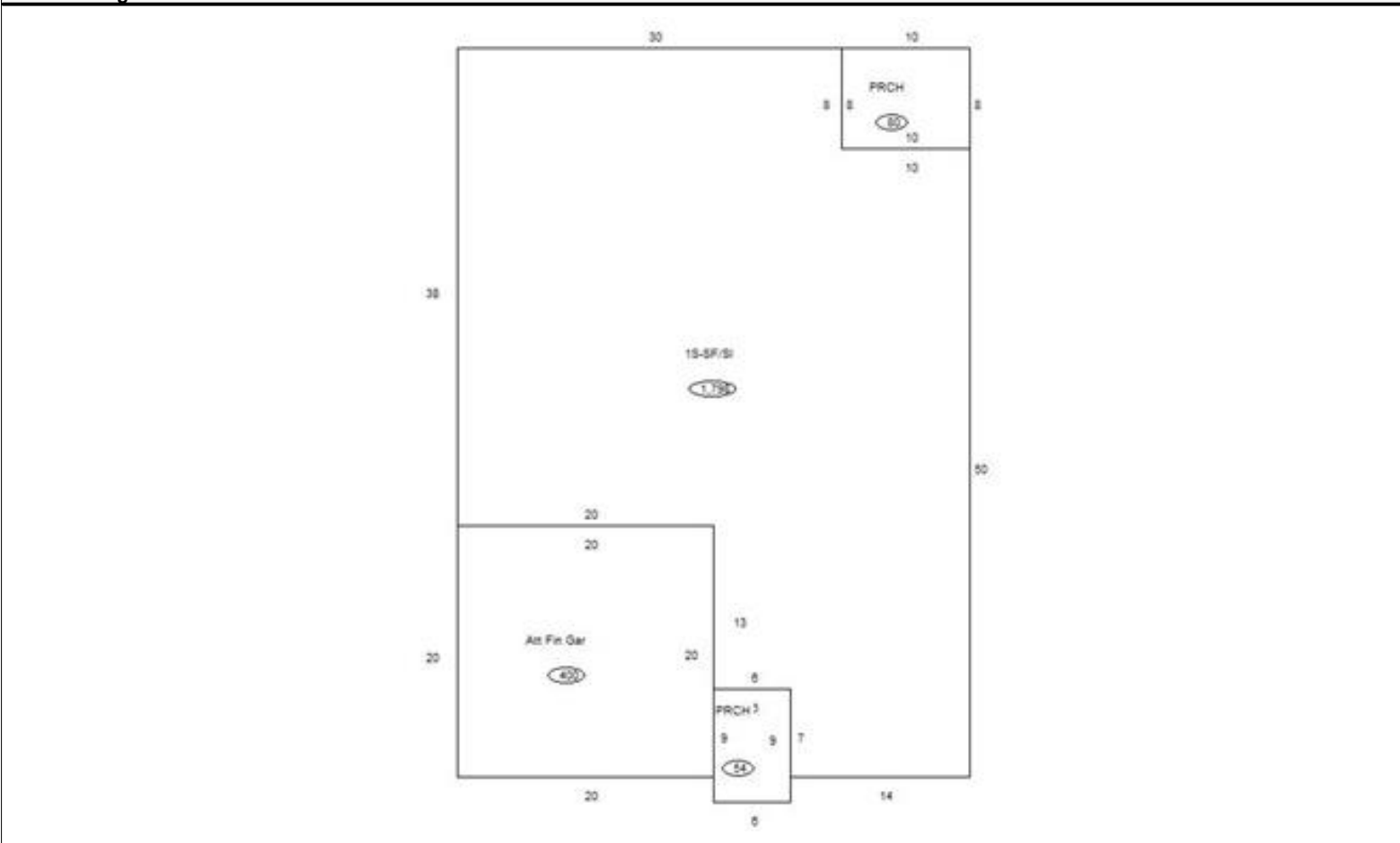

### Sketch Vector Information

Sequence	Code	Type	Built Over	Scale	Section Label	Base Area	Multiplier	Total Area
1	R	1	Slab	10	1S-SF/SI	1,798	1.000	1,798
2	G	5		10	Att Fin Gar	400	1.000	400
3	M	PRCH		10	PRCH	54	1.000	54
4	M	PRCH		10	PRCH	80	1.000	80
<b>Total Building Area</b>						<b>1,798</b>		<b>1,798</b>