



Rogers

Assessment Property Record Card for Tax Year 2026

Data provided by LISA DELOZIER County Assessor

Date 04/18/2026
Time 11:03:29
Page 1

Assessment Data					Primary Image																																									
Account 660107718 Parcel ID 22N15E-29-1-00000-016-0000 Cadastral ID 29-22-15-00510 Property Type REAL - Real Property Property Class RA VI Area 4 Tax Area 28 - COLLINSVILLE/LIME FIRE Name ID 340704 BURTON, MATTHEW JEREMIAH & JENNIFER LYNN 17865 S RANCH RD CLAREMORE OK 74019-0000 Parcel Location Situs 17865 S RANCH RD Subdivision Lot/Block / Parcel Size 12.04 - Acres Sec/Twn/Rng 29 / 22 / 15 / 1 Neighborhood 6020 - UNPLATTED School District S026 - COLLINSVILLE SCHOOLS					<p>\\tsclient\T\ROB STUFF\2024-1-11\IMG_0005.JPG 1/11/2024</p>																																									
Legal Description Lat/Long: 36.35324563 -95.73841836																																														
ONLY THAT PORTION CONTAINED IN SECTION 29 OF THE TR CONTAINED IN 29-22-15 & 30-22-15 SAID OVERALL TRACT DESC ON 2025-013362 AS COMM SW/C SEC 29; N01.2436W 1024.89' TO POB; S34.3507E 32.41'; S60.1650E 234.09'; S47.2142E 45.80'; S39.5448E 110 54'; S32.4459E 123.15'; S55.5340E 245.84'; S52.341E 200.19';					Building Permits																																									
					<table border="1"> <thead> <tr> <th>Number</th> <th>Description</th> <th>Opened</th> <th>Closed</th> <th>Amount</th> </tr> </thead> <tbody> <tr> <td>R23 173</td> <td>R24 SFR 6000 SQ FT</td> <td>07/2023</td> <td>01/2024</td> <td>350,000</td> </tr> <tr> <td>S23</td> <td>S24 SPLIT</td> <td>02/2023</td> <td>05/2023</td> <td></td> </tr> </tbody> </table>					Number	Description	Opened	Closed	Amount	R23 173	R24 SFR 6000 SQ FT	07/2023	01/2024	350,000	S23	S24 SPLIT	02/2023	05/2023																							
Number	Description	Opened	Closed	Amount																																										
R23 173	R24 SFR 6000 SQ FT	07/2023	01/2024	350,000																																										
S23	S24 SPLIT	02/2023	05/2023																																											
Exemptions					Sale History																																									
<table border="1"> <thead> <tr> <th>Code</th> <th>Type</th> <th>Active</th> <th>Maximum</th> <th>Exemption</th> </tr> </thead> <tbody> <tr> <td>H</td> <td>Homestead</td> <td>Yes</td> <td>1,000</td> <td>1,000</td> </tr> </tbody> </table>					Code	Type	Active	Maximum	Exemption	H	Homestead	Yes	1,000	1,000	<table border="1"> <thead> <tr> <th>Bk/Pg</th> <th>Grantor</th> <th>Date</th> <th>Price</th> <th>Code</th> </tr> </thead> <tbody> <tr> <td>/</td> <td>BURTON, MATTHEW JEREMIAH &</td> <td>09/19/2025</td> <td>0</td> <td>4</td> </tr> <tr> <td>/</td> <td>TITAN HOMES LLC</td> <td>01/20/2023</td> <td>400,000</td> <td>21</td> </tr> </tbody> </table>					Bk/Pg	Grantor	Date	Price	Code	/	BURTON, MATTHEW JEREMIAH &	09/19/2025	0	4	/	TITAN HOMES LLC	01/20/2023	400,000	21												
Code	Type	Active	Maximum	Exemption																																										
H	Homestead	Yes	1,000	1,000																																										
Bk/Pg	Grantor	Date	Price	Code																																										
/	BURTON, MATTHEW JEREMIAH &	09/19/2025	0	4																																										
/	TITAN HOMES LLC	01/20/2023	400,000	21																																										
Parcel Valuation																																														
<table border="1"> <thead> <tr> <th>Source</th> <th>REAL</th> </tr> </thead> <tbody> <tr> <td>Remove Cap</td> <td>2024</td> </tr> </tbody> </table>		Source	REAL	Remove Cap	2024	<table border="1"> <thead> <tr> <th>Fair Cash</th> <th>Capped</th> <th>Asmnt Level</th> <th>Assessed</th> </tr> </thead> <tbody> <tr> <td>Land Value</td> <td>433</td> <td>433</td> <td>11%</td> </tr> <tr> <td>Improvements</td> <td>445,309</td> <td>354,475</td> <td>38,992</td> </tr> <tr> <td>Uncapped Value</td> <td>0</td> <td>0</td> <td>0</td> </tr> <tr> <td>TIF Project ID</td> <td>0</td> <td></td> <td></td> </tr> <tr> <td>Total Value</td> <td>445,742</td> <td>354,908</td> <td>39,040</td> </tr> </tbody> </table>			Fair Cash	Capped	Asmnt Level	Assessed	Land Value	433	433	11%	Improvements	445,309	354,475	38,992	Uncapped Value	0	0	0	TIF Project ID	0			Total Value	445,742	354,908	39,040	<table border="1"> <thead> <tr> <th>Levy Rate</th> <th>Current Tax</th> </tr> </thead> <tbody> <tr> <td>112.698</td> <td></td> </tr> <tr> <td>Assessed</td> <td>39,040</td> </tr> <tr> <td>Penalty</td> <td>0</td> </tr> <tr> <td>Exemption</td> <td>1,000</td> </tr> <tr> <td>Total Taxable</td> <td>38,040</td> </tr> </tbody> </table>		Levy Rate	Current Tax	112.698		Assessed	39,040	Penalty	0	Exemption	1,000	Total Taxable	38,040
Source	REAL																																													
Remove Cap	2024																																													
Fair Cash	Capped	Asmnt Level	Assessed																																											
Land Value	433	433	11%																																											
Improvements	445,309	354,475	38,992																																											
Uncapped Value	0	0	0																																											
TIF Project ID	0																																													
Total Value	445,742	354,908	39,040																																											
Levy Rate	Current Tax																																													
112.698																																														
Assessed	39,040																																													
Penalty	0																																													
Exemption	1,000																																													
Total Taxable	38,040																																													
Assessment History																																														
<table border="1"> <thead> <tr> <th>Tax Year</th> <th>Statement Number</th> <th>Billed Owner</th> <th>Tax Area</th> <th>Total Value</th> <th>Exemptions</th> <th>Taxable Value</th> <th>Billed Tax</th> </tr> </thead> <tbody> <tr> <td>2025</td> <td>2025-660107718</td> <td>BURTON, MATTHEW JEREMIAH &</td> <td>28</td> <td>344,571</td> <td>1000</td> <td>36,903</td> <td>4,170.00</td> </tr> <tr> <td>2024</td> <td>2024-660107718</td> <td>BURTON, MATTHEW JEREMIAH & JENNIFER LYNN</td> <td>28</td> <td>367,198</td> <td>1000</td> <td>39,392</td> <td>4,524.00</td> </tr> <tr> <td>2023</td> <td>2023-660107718</td> <td>BURTON, MATTHEW JEREMIAH & JENNIFER LYNN</td> <td>28</td> <td>1,377</td> <td>0</td> <td>151</td> <td>17.00</td> </tr> </tbody> </table>										Tax Year	Statement Number	Billed Owner	Tax Area	Total Value	Exemptions	Taxable Value	Billed Tax	2025	2025-660107718	BURTON, MATTHEW JEREMIAH &	28	344,571	1000	36,903	4,170.00	2024	2024-660107718	BURTON, MATTHEW JEREMIAH & JENNIFER LYNN	28	367,198	1000	39,392	4,524.00	2023	2023-660107718	BURTON, MATTHEW JEREMIAH & JENNIFER LYNN	28	1,377	0	151	17.00					
Tax Year	Statement Number	Billed Owner	Tax Area	Total Value	Exemptions	Taxable Value	Billed Tax																																							
2025	2025-660107718	BURTON, MATTHEW JEREMIAH &	28	344,571	1000	36,903	4,170.00																																							
2024	2024-660107718	BURTON, MATTHEW JEREMIAH & JENNIFER LYNN	28	367,198	1000	39,392	4,524.00																																							
2023	2023-660107718	BURTON, MATTHEW JEREMIAH & JENNIFER LYNN	28	1,377	0	151	17.00																																							



Rogers

Assessment Property Record Card for Tax Year 2026

Data provided by LISA DELOZIER County Assessor

Date 04/18/2026
 Time 11:03:29
 Page 2

Lot Data	Square-Foot - NBHD 6020 #1
Lot Size	
Lot Count	
Units Buildable	
Non-Ag Acres	0
Topography	
Street Access	
Utilities	
Amenities	LAND QUALITY
Method	Square-Foot
Base Lot Value	
Factor Value	
Adjustments	
Lot Value	



\\tsclient\T\ROB STUFF\2024-1-11\IMG_0005.JPG 1/11/2024

Residential Data	
Type	1 Single Family Residence
Condition	3 - Average
Quality	3 - Average
Architecture	
Style	100% 1 1/2 Story Finished
Exterior Wall	100% Frame, Siding, Metal
Base/Total Area	1,612 / 2,640
Style	100% 1 1/2 Story Finished
HVAC	100% Warmed & Cooled Air
Roof Cover	4 Metal, Preformed
Area on Slab	1,612
Fixture/RghIn	/
Bed/F/H Bath	2 / 2.0 / 1.0
Basement Area	
Garage Type	4,388 Attached Garage - Finished
Remodel	
Year/Eff Age	2023 / 2

GRM Approach	
GRM Code	
Gross Rent	0.00
Indicated Value	

Multiple Regression	
MRA Code	
Adusted R	
Indicated Value	

Direct Comparables	
Selection Model	1 Res
Adjustment Model	A2 AO Test
Comparables	
Indicated Value	

Cost Approach				Manual : 01/2025			
Base Cost	82.24	Total Misc Impr	+ 20,741				
Roofing Adj	+ 3.36	Garage Cost	+ 163,848				
Subfloor Adj	+ -1.41	Total RCN	= 454,397				
Heat/Cool Adj	+ 12.64	Depreciation (2%)	- 9,088				
Plumbing Adj	+ 5.37	Lump Sums	+ 0				
Basement Adj	+ 0.00	RCNLD	= 445,309				
Adj Base Cost	= 102.20	Lot Value	+ 445,309				
Total Area	x 2,640	Indicated Value	= 445,309				
Adjusted Cost	= 269,808	Value Per SqFt	168.68				

Value Reconciliation			
Selected Approach	Cost Approach		
Improvements	445,309		
Lot Value			
Indicated Value	445,309	168.68	Per SqFt
Agland Value	433		
Site Improvements			
Total Value	891,051	337.52	Total Value Per SqFt

Miscellaneous Improvements								
Code	Description	Sketch ID	Size	Year	Units	Unit Cost	Depr	Value
PRCH	Slab Porch - Covered	159294	60x10		600	25.21		15,126
FPR1	Fireplace - Residential 1 Story			2023	1	5,615.40		5,615
SHLT	STORM SHELTER			2023	1	0.00		



Rogers
Assessment Property Record Card for Tax Year 2026
 Data provided by LISA DELOZIER County Assessor

Date 04/18/2026
 Time 11:03:29
 Page 3

Sketch Image

660107718

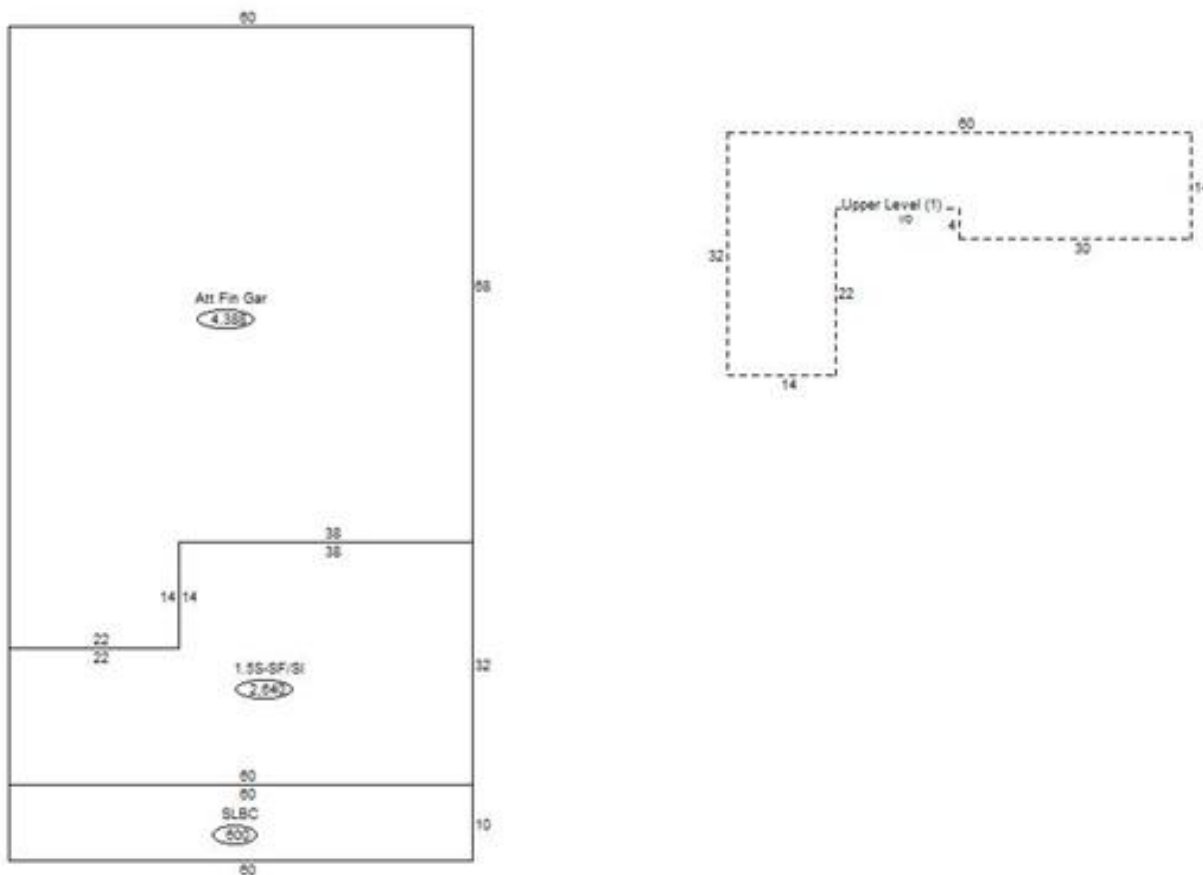

Sketch Vector Information

Sequence	Code	Type	Built Over	Scale	Section Label	Base Area	Multiplier	Total Area
1	R	5	Slab	20	1.5S-SF/SI	1,612	1.638	2,640
2	G	5		20	Att Fin Gar	4,388	1.000	4,388
3	M	PRCH		20	SLBC	600	1.000	600
4	U	^UL		20	Upper Level (1)	1,028	1.000	1,028
Total Building Area						1,612		2,640



Rogers

Assessment Property Record Card for Tax Year 2026

Data provided by LISA DELOZIER County Assessor

Date 04/18/2026
Time 11:03:29
Page 4

Agland Inventory

660107718

Soi	Description	Land Use	LPI	Adj Type	Adj Code	Acres	Use/Acre	Mkt/Acre	Use Value	Market Value
RS	ROUGH STONY LAND	TMBR	20			8.538	36	36	307	307
SO	SOGN SOILS	NTV PST	15			3.502	36	36	126	126
NTV PST Totals						12.040			433	433
Total Agland						12.040			433	433