



# Rogers

## Assessment Property Record Card for Tax Year 2026

Data provided by LISA DELOZIER County Assessor

Date 04/18/2026  
Time 11:06:29  
Page 1

| Assessment Data  | Primary Image  |            |             |           |           |        |     |           |         |         |  |       |         |      |       |      |   |                   |            |   |   |
|--|--|------------|-------------|-----------|-----------|--------|-----|-----------|---------|---------|--|-------|---------|------|-------|------|---|-------------------|------------|---|---|
| <b>Account</b> 660108090<br><b>Parcel ID</b> 21N16E-04-3-00000-002-0000<br><b>Cadastral ID</b> 04-21-16-04601<br><b>Property Type</b> REAL - Real Property<br><b>Property Class</b> UR VI Area 1<br><b>Tax Area</b> 17 - CLAREMORE OT<br><b>Name ID</b> 341722<br>HINDS, STONEY R & GINGER D<br><br>9500 E 510 RD<br>CLAREMORE OK 74019-0000<br><br><b>Parcel Location</b><br><b>Situs</b> 01204 N JAY ST<br><b>Subdivision</b><br><b>Lot/Block</b> / <b>Parcel Size</b> 1.11 - Acres<br><b>Sec/Twn/Rng</b> 4 / 21 / 16 / 3<br><b>Neighborhood</b> 2116 - UNPLATTED<br><b>School District</b> S001 - CLAREMORE SCHOOLS |  <p>\\tsclient\T\TOMMY DUNLAP\New folder (489)\IMG_0001.JPG 8/8/2025</p>   |            |             |           |           |        |     |           |         |         |  |       |         |      |       |      |   |                   |            |   |   |
| <b>Legal Description</b> Lat/Long: 36.32239300 -95.61454642<br>TR DESC 2023-006836 AS BEG SW/C SW SW; N00.1107E 350'; S88 5247E 164.95'; S00.1107W 165.50'; N89.5247W 52'; S00.1107W 184.50'; N89.5247W 113' TO POB.   | <b>Building Permits</b> <table border="1"> <thead> <tr> <th>Number</th> <th>Description</th> <th>Opened</th> <th>Closed</th> <th>Amount</th> </tr> </thead> <tbody> <tr> <td>S23</td> <td>S24 SPLIT</td> <td>06/2023</td> <td>12/2023</td> <td></td> </tr> </tbody> </table> | Number     | Description | Opened    | Closed    | Amount | S23 | S24 SPLIT | 06/2023 | 12/2023 |  |       |         |      |       |      |   |                   |            |   |   |
| Number   | Description  | Opened     | Closed      | Amount    |           |        |     |           |         |         |  |       |         |      |       |      |   |                   |            |   |   |
| S23  | S24 SPLIT  | 06/2023    | 12/2023     |           |           |        |     |           |         |         |  |       |         |      |       |      |   |                   |            |   |   |
| <b>Exemptions</b> <table border="1"> <thead> <tr> <th>Code</th> <th>Type</th> <th>Active</th> <th>Maximum</th> <th>Exemption</th> </tr> </thead> <tbody> <tr> <td></td> <td></td> <td></td> <td></td> <td></td> </tr> </tbody> </table>  | Code   | Type       | Active      | Maximum   | Exemption |        |     |           |         |         | <b>Sale History</b> <table border="1"> <thead> <tr> <th>Bk/Pg</th> <th>Grantor</th> <th>Date</th> <th>Price</th> <th>Code</th> </tr> </thead> <tbody> <tr> <td>/</td> <td>HINDS, STONEY R &amp;</td> <td>05/25/2023</td> <td>0</td> <td>4</td> </tr> </tbody> </table> | Bk/Pg | Grantor | Date | Price | Code | / | HINDS, STONEY R & | 05/25/2023 | 0 | 4 |
| Code   | Type   | Active     | Maximum     | Exemption |           |        |     |           |         |         |  |       |         |      |       |      |   |                   |            |   |   |
|  |  |            |             |           |           |        |     |           |         |         |  |       |         |      |       |      |   |                   |            |   |   |
| Bk/Pg  | Grantor  | Date       | Price       | Code      |           |        |     |           |         |         |  |       |         |      |       |      |   |                   |            |   |   |
| /  | HINDS, STONEY R &  | 05/25/2023 | 0           | 4         |           |        |     |           |         |         |  |       |         |      |       |      |   |                   |            |   |   |

| Parcel Valuation   |                  |                            |          |             |            |               |               |             |          |
|--------------------|------------------|----------------------------|----------|-------------|------------|---------------|---------------|-------------|----------|
| Source             | REAL             | Fair Cash                  | Capped   | Asmnt Level | Assessed   | Levy Rate     | 92.430        | Current Tax |          |
| Remove Cap         |                  | Land Value                 | 38,471   | 25,180      | 11%        | 2,770         | Assessed      | 16,210      | 1,498.29 |
| Year Frozen        |                  | Improvements               | 133,784  | 122,182     |            | 13,440        | Penalty       | 0           |          |
| Uncapped Value     | 0                | Mobile Home                | 0        | 0           |            | 0             | Exemption     | 0           | 0.00     |
| TIF Project ID     | 0                | Total Value                | 172,255  | 147,362     |            | 16,210        | Total Taxable | 16,210      | 1,498.00 |
| Assessment History |                  |                            |          |             |            |               |               |             |          |
| Tax Year           | Statement Number | Billed Owner               | Tax Area | Total Value | Exemptions | Taxable Value | Billed Tax    |             |          |
| 2025               | 2025-660108090   | HINDS, STONEY R & GINGER D | 17       | 161,073     | 0          | 15,438        | 1,427.00      |             |          |
| 2024               | 2024-660108090   | HINDS, STONEY R & GINGER D | 17       | 161,661     | 0          | 14,703        | 1,359.00      |             |          |
| 2023               | 2023-660108090   | HINDS, STONEY R & GINGER D | 17       | 127,298     | 0          | 14,002        | 1,283.00      |             |          |



# Rogers

## Assessment Property Record Card for Tax Year 2026

Data provided by LISA DELOZIER County Assessor

Date 04/18/2026  
 Time 11:06:29  
 Page 2

| Lot Data        |                          | Square-Foot - NBHD 2116 #1 |   |
|-----------------|--------------------------|----------------------------|---|
| Lot Size        | 0                        | 0                          |   |
| Lot Count       | 0                        |                            |   |
| Units Buildable | 0                        |                            |   |
| Non-Ag Acres    | 1.0072                   |                            |   |
| Topography      |                          |                            |   |
| Street Access   |                          |                            |   |
| Utilities       |                          |                            |   |
| Amenities       | LAND QUALITY             |                            | 0 |
|                 |                          |                            | 0 |
| Method          | Square-Foot              |                            |   |
| Base Lot Value  | 43,874.00 x .88 = 38,471 |                            |   |
| Factor Value    |                          |                            |   |
| Adjustments     | 1.0000                   |                            |   |
| Lot Value       | 38,471                   |                            |   |



\\tsclient\T\TOMMY DUNLAP\New folder (489)\IMG\_0001.JPG 8/8/2025

| Residential Data |                           |
|------------------|---------------------------|
| Type             | 1 Single Family Residence |
| Condition        | 3 - Average               |
| Quality          | 2 - Fair                  |
| Architecture     |                           |
| Style            | 100% One Story            |
| Exterior Wall    | 100% Veneer, Masonry      |
| Base/Total Area  | 858 / 858                 |
| Style            | 100% One Story            |
| HVAC             |                           |
| Roof Cover       | 1 Composition Shingle     |
| Area on Slab     | 0                         |
| Fixture/RghIn    | 4 /                       |
| Bed/F/H Bath     | 2 / 1.0 /                 |
| Basement Area    |                           |
| Garage Type      | 264 Carport - Gable Roof  |
| Remodel          |                           |
| Year/Eff Age     | 1952 / 56                 |

### GRM Approach

|                 |      |
|-----------------|------|
| GRM Code        |      |
| Gross Rent      | 0.00 |
| Indicated Value |      |

### Multiple Regression

|                 |                       |
|-----------------|-----------------------|
| MRA Code        | 1 Test                |
| Adusted R       | 0.8445                |
| Indicated Value | 68,992 80.41 Per SqFt |

### Direct Comparables

|                  |             |
|------------------|-------------|
| Selection Model  | A Adam Test |
| Adjustment Model | NewTest     |
| Comparables      |             |
| Indicated Value  |             |

### Value Reconciliation

|                   |                                   |
|-------------------|-----------------------------------|
| Selected Approach | Cost Approach                     |
| Improvements      | 38,285                            |
| Lot Value         | 38,471                            |
| Indicated Value   | 76,756 89.46 Per SqFt             |
| Agland Value      |                                   |
| Site Improvements |                                   |
| Total Value       | 76,756 89.46 Total Value Per SqFt |

| Cost Approach |           | Manual : 01/2025    |           |
|---------------|-----------|---------------------|-----------|
| Base Cost     | 108.56    | Total Misc Impr     | + 492     |
| Roofing Adj   | + 4.43    | Garage Cost         | + 1,727   |
| Subfloor Adj  | + 2.53    | Total RCN           | = 106,346 |
| Heat/Cool Adj | + 0.00    | Depreciation ( 64%) | - 68,061  |
| Plumbing Adj  | + 5.84    | Lump Sums           | + 0       |
| Basement Adj  | + 0.00    | RCNLD               | = 38,285  |
| Adj Base Cost | = 121.36  | Lot Value           | + 38,471  |
| Total Area    | x 858     | Indicated Value     | = 76,756  |
| Adjusted Cost | = 104,127 | Value Per SqFt      | 89.46     |

### Miscellaneous Improvements

| Code | Description       | Sketch ID | Size | Year | Units | Unit Cost | Depr | Value |
|------|-------------------|-----------|------|------|-------|-----------|------|-------|
| PATO | SLAB PORCH - OPEN | 8286      | 12x4 |      | 48    | 10.24     |      | 492   |



# Rogers

## Assessment Property Record Card for Tax Year 2026

Data provided by LISA DELOZIER County Assessor

Date 04/18/2026

Time 11:06:29

Page 3

Sketch Image

660108090

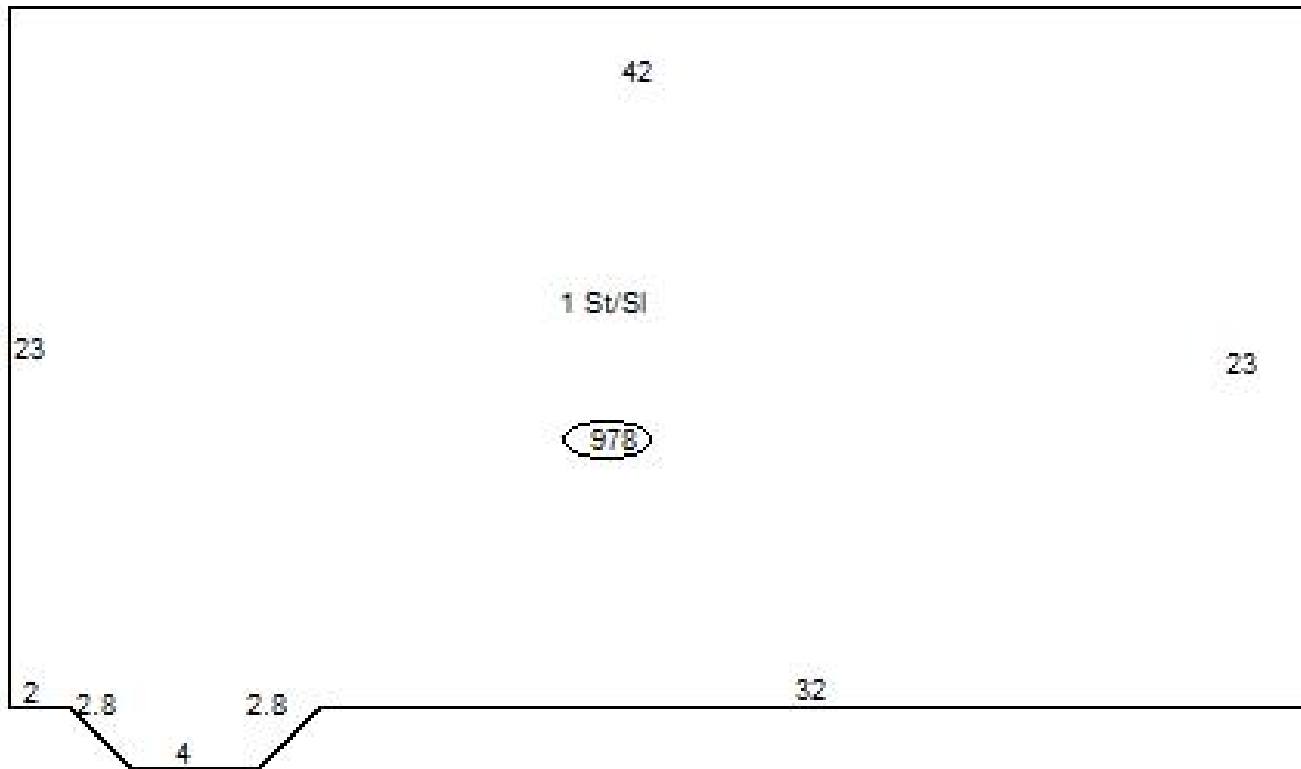

### Sketch Vector Information

| Sequence                   | Code | Type | Built Over | Scale | Section Label       | Base Area | Multiplier | Total Area |
|----------------------------|------|------|------------|-------|---------------------|-----------|------------|------------|
| 1                          | R    | 1    | Crawl      | 10    | 1 St/Cr             | 858       | 1.000      | 858        |
| 2                          | M    | PATO |            | 10    | Open Slab           | 48        | 1.000      | 48         |
| 3                          | G    | 3    |            | 10    | Carport, Gable Roof | 264       | 1.000      | 264        |
| <b>Total Building Area</b> |      |      |            |       |                     | 858       |            | 858        |



# Rogers

## Assessment Property Record Card for Tax Year 2026

Data provided by LISA DELOZIER County Assessor

Date 04/18/2026  
 Time 11:06:29  
 Page 4

| Lot Data        |              |
|-----------------|--------------|
| Lot Size        | -            |
| Lot Count       |              |
| Units Buildable |              |
| Non-Ag Acres    | 0            |
| Topography      |              |
| Street Access   |              |
| Utilities       |              |
| Amenities       | LAND QUALITY |
| Method          |              |
| Base Lot Value  |              |
| Factor Value    |              |
| Adjustments     |              |
| Lot Value       |              |



\\tsclient\T\TOMMY DUNLAP\New folder (489)\IMG\_0002.JPG 8/8/2025

| Residential Data |                           |
|------------------|---------------------------|
| Type             | 1 Single Family Residence |
| Condition        | 3 - Average               |
| Quality          | 2 - Fair                  |
| Architecture     |                           |
| Style            | 100% One Story            |
| Exterior Wall    | 100% Veneer, Masonry      |
| Base/Total Area  | 858 / 858                 |
| Style            | 100% One Story            |
| HVAC             |                           |
| Roof Cover       | 1 Composition Shingle     |
| Area on Slab     | 858                       |
| Fixture/RghIn    | 4 /                       |
| Bed/F/H Bath     | 2 / 1.0 /                 |
| Basement Area    |                           |
| Garage Type      | 264 Carport - Shed Roof   |
| Remodel          |                           |
| Year/Eff Age     | 1970 / 42                 |

| GRM Approach    |      |
|-----------------|------|
| GRM Code        |      |
| Gross Rent      | 0.00 |
| Indicated Value |      |

| Multiple Regression |  |
|---------------------|--|
| MRA Code            |  |
| Adusted R           |  |
| Indicated Value     |  |

| Direct Comparables |             |
|--------------------|-------------|
| Selection Model    | A Adam Test |
| Adjustment Model   | NewTest     |
| Comparables        |             |
| Indicated Value    |             |

| Cost Approach |           |                     |   | Manual : 01/2025 |  |
|---------------|-----------|---------------------|---|------------------|--|
| Base Cost     | 108.56    | Total Misc Impr     | + | 246              |  |
| Roofing Adj   | + 4.43    | Garage Cost         | + | 3,147            |  |
| Subfloor Adj  | + 0.00    | Total RCN           | = | 105,349          |  |
| Heat/Cool Adj | + 0.00    | Depreciation ( 52%) | - | 54,781           |  |
| Plumbing Adj  | + 5.84    | Lump Sums           | + | 0                |  |
| Basement Adj  | + 0.00    | RCNLD               | = | 50,568           |  |
| Adj Base Cost | = 118.83  | Lot Value           | + |                  |  |
| Total Area    | x 858     | Indicated Value     | = | 50,568           |  |
| Adjusted Cost | = 101,956 | Value Per SqFt      |   | 58.94            |  |

| Value Reconciliation |               |       |                      |
|----------------------|---------------|-------|----------------------|
| Selected Approach    | Cost Approach |       |                      |
| Improvements         | 50,568        |       |                      |
| Lot Value            |               |       |                      |
| Indicated Value      | 50,568        | 58.94 | Per SqFt             |
| Agland Value         |               |       |                      |
| Site Improvements    |               |       |                      |
| Total Value          | 50,568        | 58.94 | Total Value Per SqFt |

| Miscellaneous Improvements |                   |           |      |      |       |           |      |       |
|----------------------------|-------------------|-----------|------|------|-------|-----------|------|-------|
| Code                       | Description       | Sketch ID | Size | Year | Units | Unit Cost | Depr | Value |
| PATO                       | SLAB PORCH - OPEN | 8303      | 6x4  |      | 24    | 10.24     |      | 246   |



# Rogers

## Assessment Property Record Card for Tax Year 2026

Data provided by LISA DELOZIER County Assessor

Date 04/18/2026

Time 11:06:29

Page 5

### Sketch Image

660108090

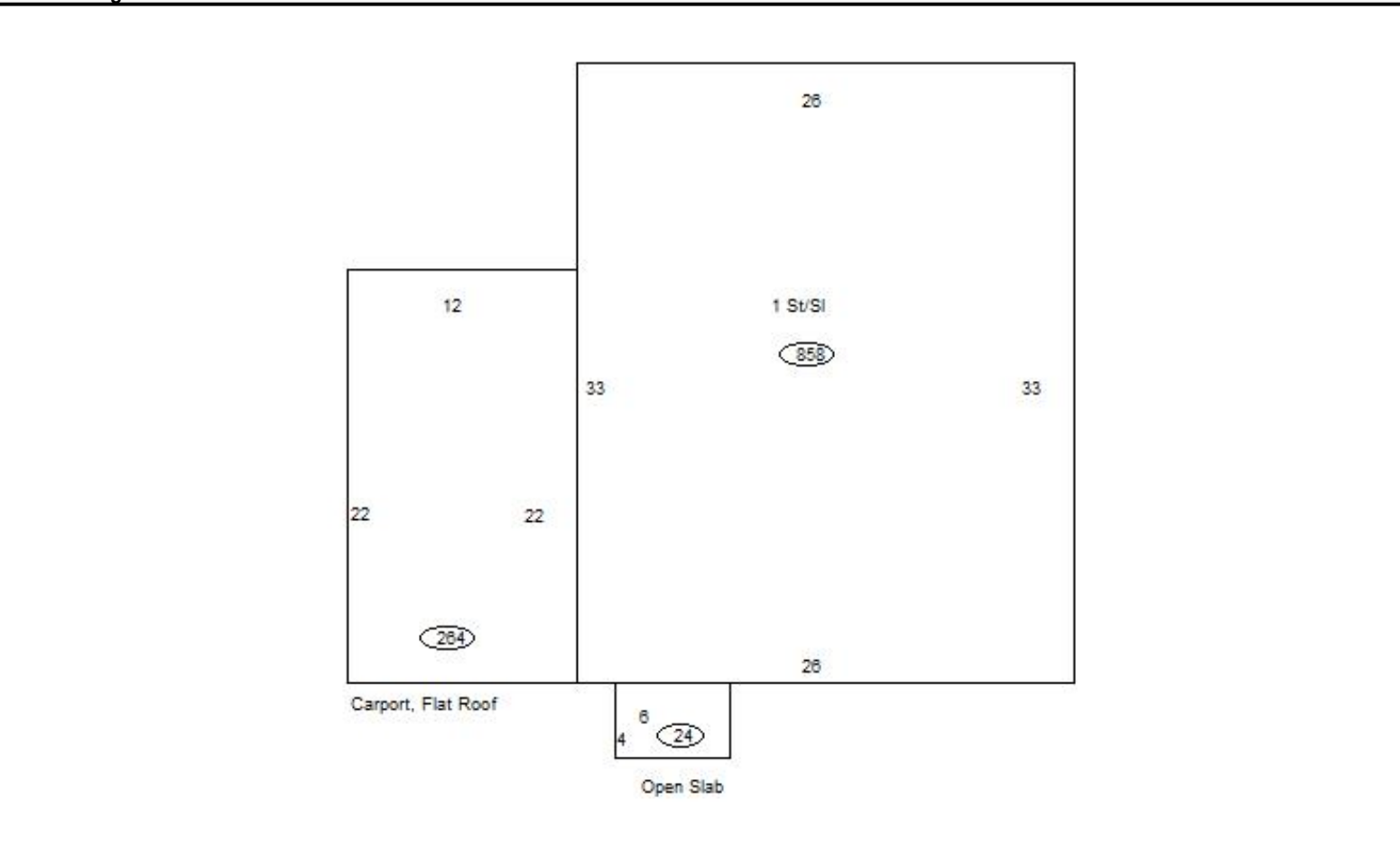

### Sketch Vector Information

| Sequence                   | Code | Type | Built Over | Scale | Section Label      | Base Area  | Multiplier | Total Area |
|----------------------------|------|------|------------|-------|--------------------|------------|------------|------------|
| 1                          | R    | 1    | Slab       | 10    | 1 St/SI            | 858        | 1.000      | 858        |
| 2                          | M    | PATO |            | 10    | Open Slab          | 24         | 1.000      | 24         |
| 3                          | G    | 4    |            | 10    | Carport, Flat Roof | 264        | 1.000      | 264        |
| <b>Total Building Area</b> |      |      |            |       |                    | <b>858</b> |            | <b>858</b> |



# Rogers

## Assessment Property Record Card for Tax Year 2026

Data provided by LISA DELOZIER County Assessor

Date 04/18/2026  
 Time 11:06:30  
 Page 6

| Lot Data        |              |
|-----------------|--------------|
| Lot Size        | -            |
| Lot Count       |              |
| Units Buildable |              |
| Non-Ag Acres    | 0            |
| Topography      |              |
| Street Access   |              |
| Utilities       |              |
| Amenities       | LAND QUALITY |
| Method          |              |
| Base Lot Value  |              |
| Factor Value    |              |
| Adjustments     |              |
| Lot Value       |              |



\\tsclient\T\TOMMY DUNLAP\New folder (489)\IMG\_0003.JPG 8/8/2025

| Residential Data |                           |
|------------------|---------------------------|
| Type             | 1 Single Family Residence |
| Condition        | 3 - Average               |
| Quality          | 2 - Fair                  |
| Architecture     |                           |
| Style            | 100% One Story            |
| Exterior Wall    | 100% Veneer, Masonry      |
| Base/Total Area  | 978 / 978                 |
| Style            | 100% One Story            |
| HVAC             |                           |
| Roof Cover       | 1 Composition Shingle     |
| Area on Slab     | 978                       |
| Fixture/RghIn    | 4 /                       |
| Bed/F/H Bath     | 2 / 1.0 /                 |
| Basement Area    |                           |
| Garage Type      |                           |
| Remodel          |                           |
| Year/Eff Age     | 1955 / 53                 |

### GRM Approach

|                 |      |
|-----------------|------|
| GRM Code        |      |
| Gross Rent      | 0.00 |
| Indicated Value |      |

### Multiple Regression

|                 |  |
|-----------------|--|
| MRA Code        |  |
| Adjusted R      |  |
| Indicated Value |  |

### Direct Comparables

|                  |             |
|------------------|-------------|
| Selection Model  | A Adam Test |
| Adjustment Model | NewTest     |
| Comparables      |             |
| Indicated Value  |             |

### Value Reconciliation

|                   |                                   |
|-------------------|-----------------------------------|
| Selected Approach | Cost Approach                     |
| Improvements      | 44,931                            |
| Lot Value         |                                   |
| Indicated Value   | 44,931                            |
| Agland Value      | 45.94 Per SqFt                    |
| Site Improvements |                                   |
| Total Value       | 44,931 45.94 Total Value Per SqFt |

### Cost Approach Manual : 01/2025

|               |           |                     |   |         |
|---------------|-----------|---------------------|---|---------|
| Base Cost     | 108.24    | Total Misc Impr     | + | 0       |
| Roofing Adj   | + 4.43    | Garage Cost         | + |         |
| Subfloor Adj  | + 0.00    | Total RCN           | = | 115,208 |
| Heat/Cool Adj | + 0.00    | Depreciation ( 61%) | - | 70,277  |
| Plumbing Adj  | + 5.13    | Lump Sums           | + | 0       |
| Basement Adj  | + 0.00    | RCNLD               | = | 44,931  |
| Adj Base Cost | = 117.80  | Lot Value           | + |         |
| Total Area    | x 978     | Indicated Value     | = | 44,931  |
| Adjusted Cost | = 115,208 | Value Per SqFt      |   | 45.94   |

### Miscellaneous Improvements

| Code | Description | Sketch ID | Size | Year | Units | Unit Cost | Depr | Value |
|------|-------------|-----------|------|------|-------|-----------|------|-------|
|------|-------------|-----------|------|------|-------|-----------|------|-------|



# Rogers

## Assessment Property Record Card for Tax Year 2026

Data provided by LISA DELOZIER County Assessor

Date 04/18/2026

Time 11:06:30

Page 7

### Sketch Image

660108090

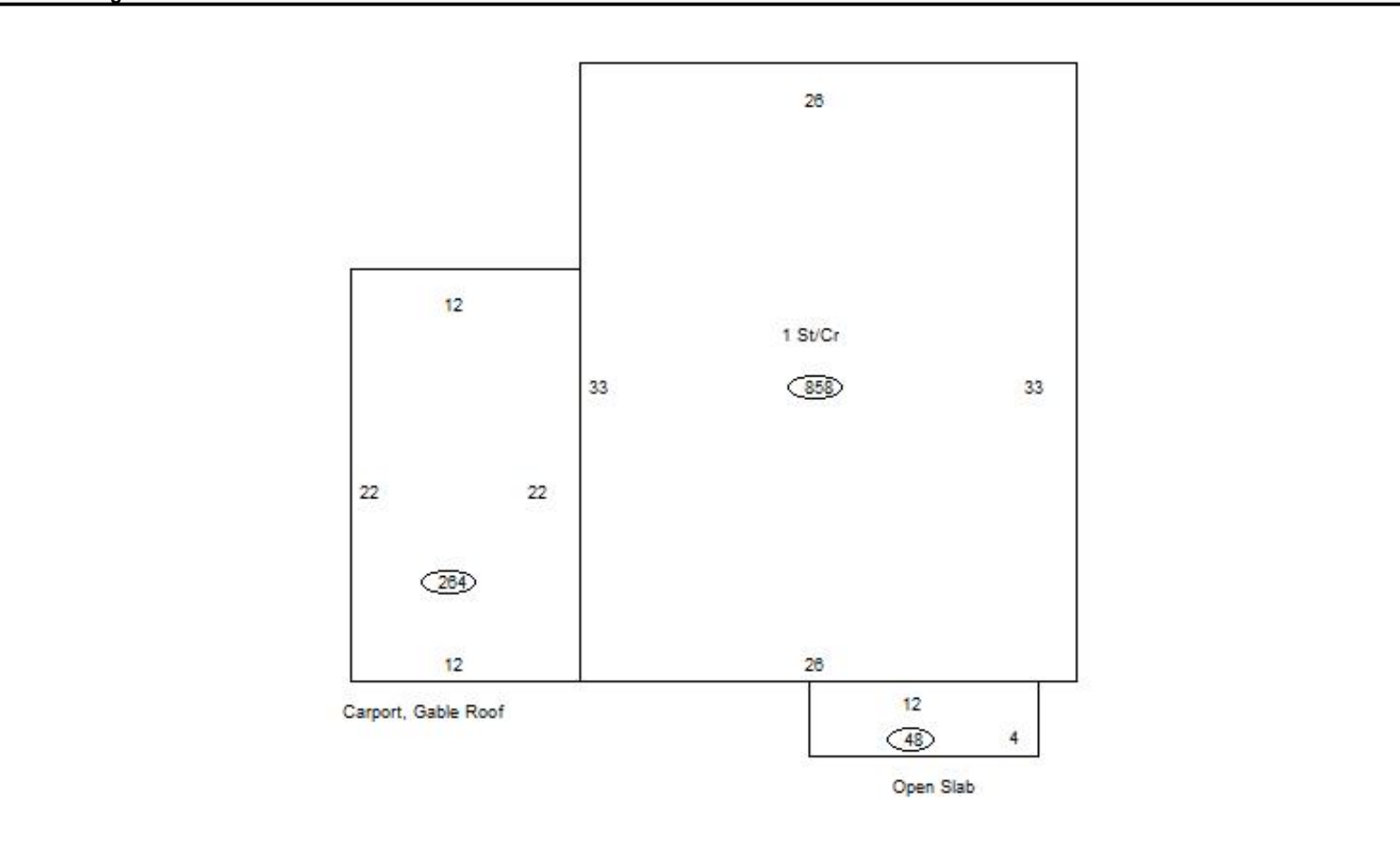

### Sketch Vector Information

| Sequence                   | Code | Type | Built Over | Scale | Section Label | Base Area | Multiplier | Total Area |
|----------------------------|------|------|------------|-------|---------------|-----------|------------|------------|
| 1                          | R    | 1    | Slab       | 10    | 1 St/Sl       | 978       | 1.000      | 978        |
| <b>Total Building Area</b> |      |      |            |       |               | 978       |            | 978        |