



Rogers

Assessment Property Record Card for Tax Year 2026

Data provided by LISA DELOZIER County Assessor

Date 04/18/2026
Time 11:06:53
Page 1

Assessment Data					Primary Image																																																																
Account 660108137 Parcel ID 000000-00-0-00642-001-0005 Cadastral ID 31-20-17-04041 Property Type REAL - Real Property Property Class RRP VI Area 3 Tax Area 2 - INOLA RURAL Name ID 345348 COMTOIS, ANGEL V & ALBERT LEE ROGERS 16155 E RANCHETTE RD UNIT A INOLA OK 74036-0000 Parcel Location Situs 16155 RANCHETTE RD UNIT A Subdivision R & R ESTATES Lot/Block 0005 / 0001 Parcel Size .4 - Lots Sec/Twn/Rng 31 / 20 / 17 / 5 Neighborhood 1093 - R-V03-SE INOLA School District S005 - INOLA SCHOOLS																																																																					
Legal Description Lat/Long: 36.17193394 -95.54448023 TR DESC 2023-007399 AS BEG SE/C LOT 5 BLOCK 1 R&R ESTATES; N01.1502W 232.97'; S88.2005W 174.39'; S01.1225E 2321.91'; N88 4058E 174.56' TO POB.																																																																					
Exemptions <table border="1"> <thead> <tr> <th>Code</th> <th>Type</th> <th>Active</th> <th>Maximum</th> <th>Exemption</th> </tr> </thead> <tbody> <tr> <td>H</td> <td>Homestead</td> <td>Yes</td> <td>1,000</td> <td>1,000</td> </tr> </tbody> </table>					Code	Type	Active	Maximum	Exemption	H	Homestead	Yes	1,000	1,000	Building Permits <table border="1"> <thead> <tr> <th>Number</th> <th>Description</th> <th>Opened</th> <th>Closed</th> <th>Amount</th> </tr> </thead> <tbody> <tr> <td>S23</td> <td>S24 SPLIT</td> <td>07/2023</td> <td>12/2023</td> <td></td> </tr> </tbody> </table>					Number	Description	Opened	Closed	Amount	S23	S24 SPLIT	07/2023	12/2023																																									
Code	Type	Active	Maximum	Exemption																																																																	
H	Homestead	Yes	1,000	1,000																																																																	
Number	Description	Opened	Closed	Amount																																																																	
S23	S24 SPLIT	07/2023	12/2023																																																																		
Parcel Valuation <table border="1"> <thead> <tr> <th>Source</th> <th>REAL</th> <th>Fair Cash</th> <th>Capped</th> <th>Asmnt Level</th> <th>Assessed</th> <th>Levy Rate</th> <th>80.060</th> <th>Current Tax</th> </tr> </thead> <tbody> <tr> <td>Remove Cap</td> <td>2025</td> <td>Land Value</td> <td>144,138</td> <td>144,138</td> <td>11%</td> <td>15,855</td> <td>Assessed</td> <td>17,600 1,409.06</td> </tr> <tr> <td>Year Frozen</td> <td></td> <td>Improvements</td> <td>15,864</td> <td>15,864</td> <td></td> <td>1,745</td> <td>Penalty</td> <td>0</td> </tr> <tr> <td>Uncapped Value</td> <td>0</td> <td>Mobile Home</td> <td>0</td> <td>0</td> <td></td> <td>0</td> <td>Exemption</td> <td>1,000 -80.00</td> </tr> <tr> <td>TIF Project ID</td> <td>0</td> <td>Total Value</td> <td>160,002</td> <td>160,002</td> <td></td> <td>17,600</td> <td>Total Taxable</td> <td>16,600 1,329.00</td> </tr> </tbody> </table>					Source	REAL	Fair Cash	Capped	Asmnt Level	Assessed	Levy Rate	80.060	Current Tax	Remove Cap	2025	Land Value	144,138	144,138	11%	15,855	Assessed	17,600 1,409.06	Year Frozen		Improvements	15,864	15,864		1,745	Penalty	0	Uncapped Value	0	Mobile Home	0	0		0	Exemption	1,000 -80.00	TIF Project ID	0	Total Value	160,002	160,002		17,600	Total Taxable	16,600 1,329.00	Sale History <table border="1"> <thead> <tr> <th>Bk/Pg</th> <th>Grantor</th> <th>Date</th> <th>Price</th> <th>Code</th> </tr> </thead> <tbody> <tr> <td>/</td> <td>MCCARTY, BOBBIE RAY</td> <td>09/10/2024</td> <td>160,000</td> <td>WG</td> </tr> <tr> <td>/</td> <td>MCCARTY, RICKY LEE</td> <td>06/22/2022</td> <td>0</td> <td>4</td> </tr> </tbody> </table>					Bk/Pg	Grantor	Date	Price	Code	/	MCCARTY, BOBBIE RAY	09/10/2024	160,000	WG	/	MCCARTY, RICKY LEE	06/22/2022	0	4
Source	REAL	Fair Cash	Capped	Asmnt Level	Assessed	Levy Rate	80.060	Current Tax																																																													
Remove Cap	2025	Land Value	144,138	144,138	11%	15,855	Assessed	17,600 1,409.06																																																													
Year Frozen		Improvements	15,864	15,864		1,745	Penalty	0																																																													
Uncapped Value	0	Mobile Home	0	0		0	Exemption	1,000 -80.00																																																													
TIF Project ID	0	Total Value	160,002	160,002		17,600	Total Taxable	16,600 1,329.00																																																													
Bk/Pg	Grantor	Date	Price	Code																																																																	
/	MCCARTY, BOBBIE RAY	09/10/2024	160,000	WG																																																																	
/	MCCARTY, RICKY LEE	06/22/2022	0	4																																																																	
Assessment History <table border="1"> <thead> <tr> <th>Tax Year</th> <th>Statement Number</th> <th>Billed Owner</th> <th>Tax Area</th> <th>Total Value</th> <th>Exemptions</th> <th>Taxable Value</th> <th>Billed Tax</th> </tr> </thead> <tbody> <tr> <td>2025</td> <td>2025-660108137</td> <td>COMTOIS, ANGEL V &</td> <td>2</td> <td>176,001</td> <td>1000</td> <td>18,360</td> <td>1,470.00</td> </tr> <tr> <td>2024</td> <td>2024-660108137</td> <td>COMTOIS, ANGEL V &</td> <td>2</td> <td>46,598</td> <td>879</td> <td></td> <td>.00</td> </tr> <tr> <td>2023</td> <td>2023-660108137</td> <td>MCCARTY, BOBBIE RAY</td> <td>2</td> <td>7,754</td> <td>0</td> <td>853</td> <td>69.00</td> </tr> </tbody> </table>					Tax Year	Statement Number	Billed Owner	Tax Area	Total Value	Exemptions	Taxable Value	Billed Tax	2025	2025-660108137	COMTOIS, ANGEL V &	2	176,001	1000	18,360	1,470.00	2024	2024-660108137	COMTOIS, ANGEL V &	2	46,598	879		.00	2023	2023-660108137	MCCARTY, BOBBIE RAY	2	7,754	0	853	69.00																																	
Tax Year	Statement Number	Billed Owner	Tax Area	Total Value	Exemptions	Taxable Value	Billed Tax																																																														
2025	2025-660108137	COMTOIS, ANGEL V &	2	176,001	1000	18,360	1,470.00																																																														
2024	2024-660108137	COMTOIS, ANGEL V &	2	46,598	879		.00																																																														
2023	2023-660108137	MCCARTY, BOBBIE RAY	2	7,754	0	853	69.00																																																														



Rogers

Assessment Property Record Card for Tax Year 2026

Data provided by LISA DELOZIER County Assessor

Date 04/18/2026
 Time 11:06:54
 Page 2

Lot Data		Square-Foot - NBHD 1093 #1		Primary Image			
Lot Size	0	0					
Lot Count	0.4						
Units Buildable	0						
Non-Ag Acres	0.9232						
Topography							
Street Access							
Utilities							
Amenities	LAND QUALITY		0				
			0				
Method	Square-Foot						
Base Lot Value	40,212.00 x 1.15 = 46,244						
Factor Value							
Adjustments	3.1169						
Lot Value	144,138						
Residential Data				GRM Approach			
Type				GRM Code			
Condition	-			Gross Rent	0.00		
Quality	-			Indicated Value			
Architecture				Multiple Regression			
Style				MRA Code			
Exterior Wall				Adjusted R			
Base/Total Area /				Indicated Value			
Style				Direct Comparables			
HVAC				Selection Model	A Adam Test		
Roof Cover				Adjustment Model	1 2022 Residential		
Area on Slab				Comparables			
Fixture/RghIn /				Indicated Value			
Bed/F/H Bath / /				Value Reconciliation			
Basement Area				Selected Approach	Cost Approach		
Garage Type				Improvements			
Remodel				Lot Value	144,138		
Year/Eff Age /				Indicated Value	144,138	0.00	Per SqFt
				Agland Value			
				Site Improvements	354		
				Total Value	144,492	0.00	Total Value Per SqFt
Cost Approach				Manual : 01/2025			
Base Cost	0.00	Total Misc Impr	+ 0				
Roofing Adj	+ 0.00	Garage Cost	+ 0				
Subfloor Adj	+ 0.00	Total RCN	= 0				
Heat/Cool Adj	+ 0.00	Depreciation (0%)	- 0				
Plumbing Adj	+ 0.00	Lump Sums	+ 0				
Basement Adj	+ 0.00	RCNLD	= 0				
Adj Base Cost	= 0.00	Lot Value	+ 144,138				
Total Area	x	Indicated Value	= 144,138				
Adjusted Cost	= 0	Value Per SqFt	0.00				
Miscellaneous Improvements							
Code	Description	Sketch ID	Size	Year	Units	Unit Cost	Depr Value



Rogers



Assessment Property Record Card for Tax Year 2026

Data provided by LISA DELOZIER County Assessor

Date 04/18/2026
 Time 11:06:54
 Page 3

660108137

Outbuildings/Site Improvements

Building Image	Code	Description	Dimensions	Floor	Roofing	Total Units
	LF	LOAFING SHED	8x16x0			128
	Qual	Cond	Year	Eff Age		
	Valuation Summary		Modifier Total	RCN	Depr (35% Phys/ % Func)	RCNLD
	Base Cost (4.26 x 128)		545		545 191	354
	STF	STG FAIR (PORTABLE)	0x0x0			
	Qual	Cond	Year	Eff Age		
	Valuation Summary		Modifier Total	RCN	Depr (100% Phys/ % Func)	RCNLD
	Base Cost (4.68 x)					



Rogers

Assessment Property Record Card for Tax Year 2026

Data provided by LISA DELOZIER County Assessor

Date 04/18/2026
Time 11:06:54
Page 4

Lot Data		Square-Foot - NBHD 1093 #1		Primary Image				
Lot Size								
Lot Count								
Units Buildable								
Non-Ag Acres								
Topography								
Street Access								
Utilities								
Amenities	LAND QUALITY							
Method	Square-Foot							
Base Lot Value								
Factor Value								
Adjustments								
Lot Value								
Residential Data				D:\Appraisers\JAYSON\JAYSON RESIDENTIAL VI\2021-8-18\IMG 8/18/2021				
Type	6 Mobile Home 40 x 22			GRM Approach				
Condition	3 - Average			GRM Code				
Quality	3 - Average			Gross Rent 0.00				
Architecture	6 MS ADJ			Indicated Value				
Style	100% Double Wide			Multiple Regression				
Exterior Wall	100% Lap			MRA Code				
Base/Total Area	880 / 880			Adusted R				
Style	100% Double Wide			Indicated Value				
HVAC	100% Warmed & Cooled Air			Direct Comparables				
Roof Cover	1 Composition Shingle			Selection Model A Adam Test				
Area on Slab	0			Adjustment Model 1 2022 Residential				
Fixture/RghIn	/			Comparables				
Bed/F/H Bath	/ /			Indicated Value				
Basement Area				Value Reconciliation				
Garage Type				Selected Approach Cost Approach				
Remodel				Improvements 15,510				
Year/Eff Age	1999 / 20			Lot Value				
Cost Approach		Manual : 01/2025		Indicated Value 15,510 17.63 Per SqFt				
Base Cost	39.49	Total Misc Impr	+	0	Agland Value			
Roofing Adj	+ 3.04	Garage Cost	+		Site Improvements			
Subfloor Adj	+ 0.00	Total RCN	=	52,395	Total Value 15,510 17.63 Total Value Per SqFt			
Heat/Cool Adj	+ 4.92	Depreciation (72%)	-	37,724				
Plumbing Adj	+ 12.09	Lump Sums	+	839				
Basement Adj	+ 0.00	RCNLD	=	15,510				
Adj Base Cost	= 59.54	Lot Value	+					
Total Area	x 880	Indicated Value	=	15,510				
Adjusted Cost	= 52,395	Value Per SqFt		17.63				
Miscellaneous Improvements								
Code	Description	Sketch ID	Size	Year	Units	Unit Cost	Depr	Value
WODO	Wood Deck - Open	151119	12x8		96	27.30	68%	839



Rogers

Assessment Property Record Card for Tax Year 2026

Data provided by LISA DELOZIER County Assessor

Date 04/18/2026
Time 11:06:54
Page 5

Sketch Image

660108137

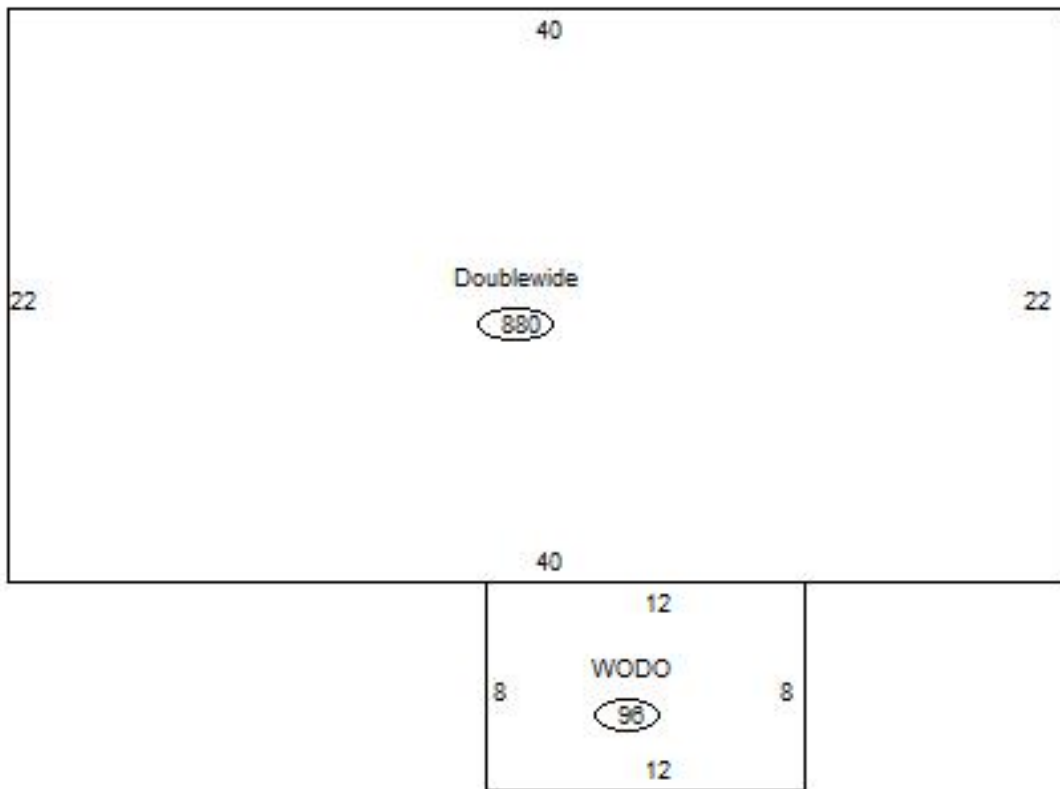

Sketch Vector Information

Sequence	Code	Type	Built Over	Scale	Section Label	Base Area	Multiplier	Total Area
1	R	14		10	Doublewide	880	1.000	880
2	M	WODO		10	WODO	96	1.000	96
Total Building Area						880		880