



# Rogers

## Assessment Property Record Card for Tax Year 2026

Data provided by LISA DELOZIER County Assessor

Date 04/18/2026  
Time 11:18:38  
Page 1

Assessment Data				Primary Image																				
<b>Account</b> 660108883 <b>Parcel ID</b> 000000-00-0-00567-001-0014 <b>Cadastral ID</b> 30-24-18-09261 <b>Property Type</b> REAL - Real Property <b>Property Class</b> URP VI Area 2 <b>Tax Area</b> 29 - CHELSEA OT <b>Name ID</b> 344714 KENNEDY, KASI N  101 E 1ST ST CHELSEA OK 74016-0000  <b>Parcel Location</b> <b>Situs</b> 00101 E 1ST ST <b>Subdivision</b> ORRS <b>Lot/Block</b> 0014 / 0001 <b>Parcel Size</b> 1 - Lots <b>Sec/Twn/Rng</b> 30 / 24 / 18 / 5 <b>Neighborhood</b> 1077 - R-V02-SE CHELSEA <b>School District</b> S003 - CHELSEA SCHOOLS				<p>\\tsclient\T\TOMMY DUNLAP\New folder (378)\IMG_0002.JPG 8/28/2024</p>																				
<b>Legal Description</b> Lat/Long: 36.53754194 -95.42569703										<b>Building Permits</b>														
LOT 14 BLOCK 1 ORR'S ADDITION				<table border="1"> <thead> <tr> <th>Number</th> <th>Description</th> <th>Opened</th> <th>Closed</th> <th>Amount</th> </tr> </thead> <tbody> <tr> <td>R24</td> <td>NEW SFR</td> <td>08/2024</td> <td>11/2024</td> <td></td> </tr> <tr> <td>S24</td> <td>S25 SPLIT + NEW ADDRESS APTS</td> <td>04/2024</td> <td>08/2024</td> <td></td> </tr> </tbody> </table>						Number	Description	Opened	Closed	Amount	R24	NEW SFR	08/2024	11/2024		S24	S25 SPLIT + NEW ADDRESS APTS	04/2024	08/2024	
Number	Description	Opened	Closed	Amount																				
R24	NEW SFR	08/2024	11/2024																					
S24	S25 SPLIT + NEW ADDRESS APTS	04/2024	08/2024																					
<b>Exemptions</b>				<b>Sale History</b>																				
<b>Code</b>	<b>Type</b>	<b>Active</b>	<b>Maximum</b>	<b>Exemption</b>	<b>Bk/Pg</b>	<b>Grantor</b>	<b>Date</b>	<b>Price</b>	<b>Code</b>															
					/	JBE PROPERTIES LLC	07/02/2024	109,000	YES															
					/	EAGLES NEST APARTMENTS LLC	04/01/2024	0	11															
<b>Parcel Valuation</b>																								
<b>Source</b>	<b>REAL</b>		<b>Fair Cash</b>	<b>Capped</b>	<b>Asmnt Level</b>	<b>Assessed</b>	<b>Levy Rate</b>	82.750	<b>Current Tax</b>															
<b>Remove Cap</b>	2025		<b>Land Value</b>	20,062	20,062	11%	<b>Assessed</b>	12,312	1,018.82															
<b>Year Frozen</b>			<b>Improvements</b>	91,864	91,864		<b>Penalty</b>	0																
<b>Uncapped Value</b>	0		<b>Mobile Home</b>	0	0		<b>Exemption</b>	0	0.00															
<b>TIF Project ID</b>	0		<b>Total Value</b>	111,926	111,926		<b>Total Taxable</b>	12,312	1,019.00															
<b>Assessment History</b>																								
<b>Tax Year</b>	<b>Statement Number</b>	<b>Billed Owner</b>			<b>Tax Area</b>	<b>Total Value</b>	<b>Exemptions</b>	<b>Taxable Value</b>	<b>Billed Tax</b>															
2025	2025-660108883	KENNEDY, KASI N			29	109,000	0	11,990	992.00															
2024	2024-660108883	KENNEDY, KASI N			29	14,640	0	1,610	136.00															



# Rogers

## Assessment Property Record Card for Tax Year 2026

Data provided by LISA DELOZIER County Assessor

Date 04/18/2026  
 Time 11:18:38  
 Page 2

Lot Data	Square-Foot - ORRS (SQUARE FOOT)	Primary Image
Lot Size	0 0	
Lot Count	1	
Units Buildable	0	
Non-Ag Acres	0	
Topography		
Street Access		
Utilities		
Amenities	LAND QUALITY 1 0	
Method	Square-Foot	
Base Lot Value	8,100.00 x .50 = 4,050	
Factor Value	1,013	
Adjustments	3.9625	
Lot Value	20,062	

Residential Data	
Type	1 Single Family Residence
Condition	3 - Average
Quality	2 - Fair
Architecture	
Style	100% One Story
Exterior Wall	100% Frame, Siding, Wood
Base/Total Area	720 / 720
Style	100% One Story
HVAC	100% Warmed & Cooled Air
Roof Cover	1 Composition Shingle
Area on Slab	720
Fixture/RghIn	/
Bed/F/H Bath	1 / 1.0 /
Basement Area	
Garage Type	
Remodel	
Year/Eff Age	2024 / 2



\\tsclient\T\TOMMY DUNLAP\New folder (378)\IMG\_0002.JPG 8/28/2024

GRM Approach	
GRM Code	
Gross Rent	0.00
Indicated Value	

Multiple Regression	
MRA Code	
Adusted R	
Indicated Value	

Direct Comparables	
Selection Model	A Adam Test
Adjustment Model	1 2022 Residential
Comparables	
Indicated Value	

Cost Approach		Manual : 01/2025	
Base Cost	104.51	Total Misc Impr	+ 1,586
Roofing Adj	+ 4.70	Garage Cost	+ 0
Subfloor Adj	+ 0.00	Total RCN	= 93,739
Heat/Cool Adj	+ 10.30	Depreciation ( 2%)	- 1,875
Plumbing Adj	+ 8.48	Lump Sums	+ 0
Basement Adj	+ 0.00	RCNLD	= 91,864
Adj Base Cost	= 127.99	Lot Value	+ 20,062
Total Area	x 720	Indicated Value	= 111,926
Adjusted Cost	= 92,153	Value Per SqFt	155.45

Value Reconciliation			
Selected Approach	Cost Approach		
Improvements	91,864		
Lot Value	20,062		
Indicated Value	111,926	155.45	Per SqFt
Agland Value			
Site Improvements			
Total Value	111,926	155.45	Total Value Per SqFt

Miscellaneous Improvements								
Code	Description	Sketch ID	Size	Year	Units	Unit Cost	Depr	Value
PRCH	Porch	160833	9x6		54	21.12		1,140
PRCH	Porch	160834	7x3		21	21.23		446



# Rogers

## Assessment Property Record Card for Tax Year 2026

Data provided by LISA DELOZIER County Assessor

Date 04/18/2026

Time 11:18:38

Page 3

Sketch Image

660108883

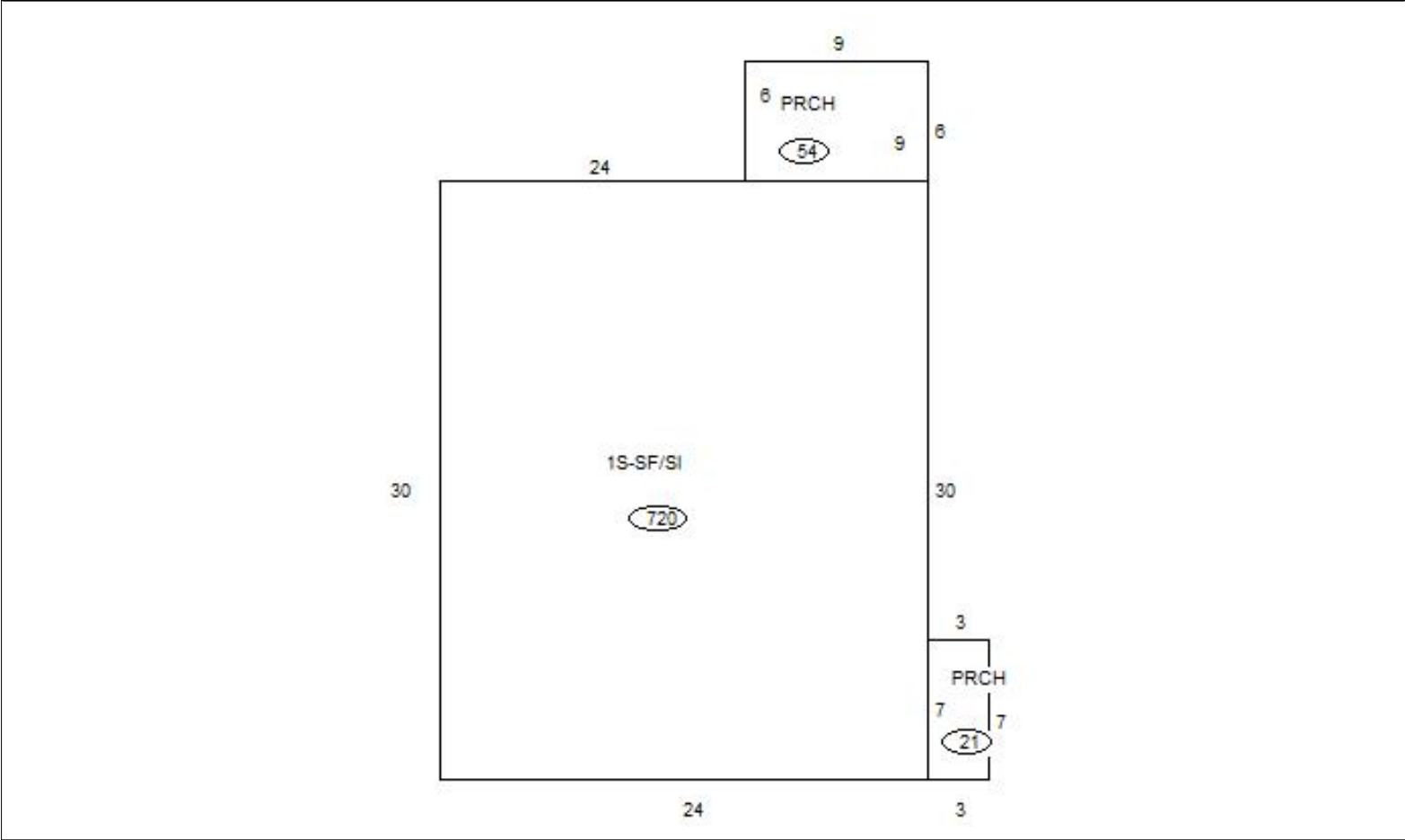

### Sketch Vector Information

Sequence	Code	Type	Built Over	Scale	Section Label	Base Area	Multiplier	Total Area
1	R	1	Slab	10	1S-SF/SI	720	1.000	720
2	M	PRCH		10	PRCH	54	1.000	54
3	M	PRCH		10	PRCH	21	1.000	21
<b>Total Building Area</b>						720		720