



Rogers

Assessment Property Record Card for Tax Year 2026

Data provided by LISA DELOZIER County Assessor

Date 04/18/2026
 Time 11:32:26
 Page 1

Assessment Data				Primary Image						
Account	660109732			No Image On File						
Parcel ID	000000-00-0-30010-049-0001									
Cadastral ID	30-24-18-03971									
Property Type	REAL - Real Property									
Property Class	URP	VI Area	2							
Tax Area	29 - CHELSEA OT									
Name ID	346247									
JBE PROPERTIES LLC										
PO BOX 137 CHELSEA OK 74016-0000										
Parcel Location										
Situs	00120 E 7TH ST									
Subdivision	CHELSEA O T									
Lot/Block	0001 / 0049	Parcel Size	.21 - Lots							
Sec/Twn/Rng	30 / 24 / 18 / 5									
Neighborhood	1195 - R-V02-NE CHELSEA									
School District	S003 - CHELSEA SCHOOLS									
Legal Description Lat/Long: 36.53261787 -95.42985346				Building Permits						
E 50' W 100' N 68' LOT 1 BLOCK 49 CHELSEA O T				Number	Description	Opened	Closed	Amount		
				R25	NEW SFR	01/2025	11/2025			
Exemptions				Sale History						
Code	Type	Active	Maximum	Exemption	Bk/Pg	Grantor	Date	Price	Code	
					/	GUERRERO, WANDA	01/21/2026	0	WB	
					/	JBE PROPERTIES LLC	05/29/2025	137,500	PQ	
					/	EAGLETON, BILLY RAY JR	01/10/2025	0	4	
Parcel Valuation										
Source	REAL		Fair Cash	Capped	Asmnt Level	Assessed	Levy Rate	82.750	Current Tax	
Remove Cap	2026	Land Value	3,740	3,740	11%	411	Assessed	13,159	1,088.91	
Year Frozen		Improvements	115,895	115,895		12,748	Penalty	0		
Uncapped Value	115,895	Mobile Home	0	0		0	Exemption	0	0.00	
TIF Project ID	0	Total Value	119,635	119,635		13,159	Total Taxable	13,159	1,089.00	
Assessment History										
Tax Year	Statement Number	Billed Owner			Tax Area	Total Value	Exemptions	Taxable Value	Billed Tax	
2025	2025-660109732	GUERRERO, WANDA			29	3,740	0	411	34.00	



Rogers

Assessment Property Record Card for Tax Year 2026

Data provided by LISA DELOZIER County Assessor

Date 04/18/2026
 Time 11:32:26
 Page 2

Lot Data		Square-Foot - NBHD 1195 #1	Primary Image
Lot Size	0	0	
Lot Count	0		
Units Buildable	0		
Non-Ag Acres	0		
Topography			
Street Access			
Utilities			
Amenities	LAND QUALITY	0	
		0	
Method	Square-Foot		
Base Lot Value	3,400.00 x 1.10 = 3,740		
Factor Value			
Adjustments	0.0000		
Lot Value	3,740		

Residential Data	
Type	1 Single Family Residence
Condition	3 - Average
Quality	2 - Fair
Architecture	
Style	100% One Story
Exterior Wall	100% Frame, Siding, Wood
Base/Total Area	990 / 990
Style	100% One Story
HVAC	100% Warmed & Cooled Air
Roof Cover	1 Composition Shingle
Area on Slab	990
Fixture/RghIn	/
Bed/F/H Bath	2 / 1.0 /
Basement Area	
Garage Type	
Remodel	
Year/Eff Age	2025 / 1

GRM Approach	
GRM Code	
Gross Rent	0.00
Indicated Value	

Multiple Regression	
MRA Code	
Adjusted R	
Indicated Value	

Direct Comparables	
Selection Model	A Adam Test
Adjustment Model	1 2022 Residential
Comparables	
Indicated Value	

Cost Approach		Manual : 01/2025	
Base Cost	95.92	Total Misc Impr	+ 1,513
Roofing Adj	+ 4.33	Garage Cost	+
Subfloor Adj	+ 0.00	Total RCN	= 117,066
Heat/Cool Adj	+ 10.30	Depreciation (1%)	- 1,171
Plumbing Adj	+ 6.17	Lump Sums	+ 0
Basement Adj	+ 0.00	RCNLD	= 115,895
Adj Base Cost	= 116.72	Lot Value	+ 3,740
Total Area	x 990	Indicated Value	= 119,635
Adjusted Cost	= 115,553	Value Per SqFt	120.84

Value Reconciliation			
Selected Approach	Cost Approach		
Improvements	115,895		
Lot Value	3,740		
Indicated Value	119,635	120.84	Per SqFt
Agland Value			
Site Improvements			
Total Value	119,635	120.84	Total Value Per SqFt

Miscellaneous Improvements								
Code	Description	Sketch ID	Size	Year	Units	Unit Cost	Depr	Value
PRCH	Porch	181407	12x5		60	21.11		1,267
PATO	Patio - Open	181408	6x4		24	10.24		246



Rogers

Assessment Property Record Card for Tax Year 2026

Data provided by LISA DELOZIER County Assessor

Date 04/18/2026

Time 11:32:26

Page 3

Sketch Image

660109732

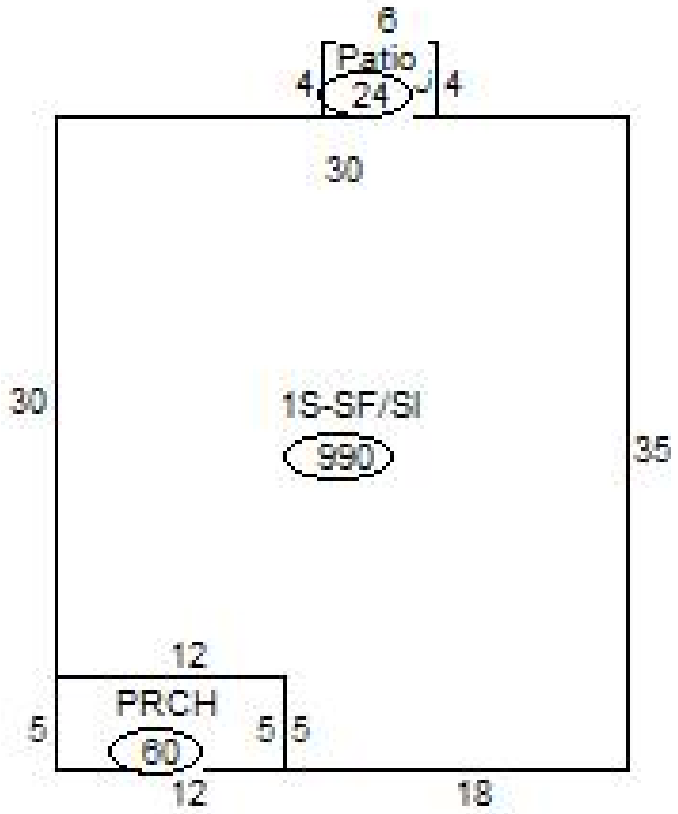

Sketch Vector Information

Sequence	Code	Type	Built Over	Scale	Section Label	Base Area	Multiplier	Total Area
1	R	1	Slab	20	1S-SF/SI	990	1.000	990
2	M	PRCH		20	PRCH	60	1.000	60
3	M	PATO		20	Patio	24	1.000	24
Total Building Area						990		990