



# Rogers

## Assessment Property Record Card for Tax Year 2026

Data provided by LISA DELOZIER County Assessor

Date 04/18/2026  
Time 11:41:49  
Page 1

Assessment Data					Primary Image																																																											
<b>Account</b> 660110459 <b>Parcel ID</b> 000000-00-0-00237-001-0003 <b>Cadastral ID</b> 30-24-15-00511 <b>Property Type</b> REAL - Real Property <b>Property Class</b> RRP VI Area 2 <b>Tax Area</b> 10 - OOLOGAH RURAL/NW FIRE <b>Name ID</b> 348259 TABOR, CRAIG & LEAH  4556 E 330 RD TALALA OK 74080-0000  <b>Parcel Location</b> <b>Situs</b> 04556 E 330 RD <b>Subdivision</b> CRESTWOOD ESTATES <b>Lot/Block</b> 0003 / 0001 <b>Parcel Size</b> 1 - Lots <b>Sec/Twn/Rng</b> 30 / 24 / 15 / 5 <b>Neighborhood</b> 1217 - R-V02-NW OOLOGAH <b>School District</b> S004 - OOLOGAH SCHOOLS					 <p>660026121 02/11/25</p> <p>660026121_001.JPG 2/25/2025</p>																																																											
<b>Legal Description</b> Lot/Long: 36.53756183 -95.74677140 LOT 3 BLOCK 1 CRESTWOOD ESTATES																																																																
<b>Exemptions</b> <table border="1"> <thead> <tr> <th>Code</th> <th>Type</th> <th>Active</th> <th>Maximum</th> <th>Exemption</th> </tr> </thead> <tbody> <tr> <td>H</td> <td>Homestead</td> <td>No</td> <td>1,000</td> <td></td> </tr> </tbody> </table>					Code	Type	Active	Maximum	Exemption	H	Homestead	No	1,000		<b>Building Permits</b> <table border="1"> <thead> <tr> <th>Number</th> <th>Description</th> <th>Opened</th> <th>Closed</th> <th>Amount</th> </tr> </thead> <tbody> <tr> <td>S25</td> <td>S26 SPLIT (MOVED ALL EXISTING IMP</td> <td>10/2025</td> <td></td> <td></td> </tr> </tbody> </table>					Number	Description	Opened	Closed	Amount	S25	S26 SPLIT (MOVED ALL EXISTING IMP	10/2025																																					
Code	Type	Active	Maximum	Exemption																																																												
H	Homestead	No	1,000																																																													
Number	Description	Opened	Closed	Amount																																																												
S25	S26 SPLIT (MOVED ALL EXISTING IMP	10/2025																																																														
<b>Parcel Valuation</b> <table border="1"> <thead> <tr> <th>Source</th> <th>REAL</th> <th>Fair Cash</th> <th>Capped</th> <th>Asmnt Level</th> <th>Assessed</th> <th>Levy Rate</th> <th>108.182</th> <th>Current Tax</th> </tr> </thead> <tbody> <tr> <td>Remove Cap</td> <td>2026</td> <td>Land Value</td> <td>221,106</td> <td>221,106</td> <td>11%</td> <td>24,322</td> <td>Assessed</td> <td>56,100 6,068.98</td> </tr> <tr> <td>Year Frozen</td> <td>2014</td> <td>Improvements</td> <td>288,895</td> <td>288,895</td> <td></td> <td>31,778</td> <td>Penalty</td> <td>0</td> </tr> <tr> <td>Uncapped Value</td> <td>0</td> <td>Mobile Home</td> <td>0</td> <td>0</td> <td></td> <td>0</td> <td>Exemption</td> <td>0 0.00</td> </tr> <tr> <td>TIF Project ID</td> <td>0</td> <td>Total Value</td> <td>510,001</td> <td>510,001</td> <td></td> <td>56,100</td> <td>Total Taxable</td> <td>56,100 6,069.00</td> </tr> </tbody> </table>					Source	REAL	Fair Cash	Capped	Asmnt Level	Assessed	Levy Rate	108.182	Current Tax	Remove Cap	2026	Land Value	221,106	221,106	11%	24,322	Assessed	56,100 6,068.98	Year Frozen	2014	Improvements	288,895	288,895		31,778	Penalty	0	Uncapped Value	0	Mobile Home	0	0		0	Exemption	0 0.00	TIF Project ID	0	Total Value	510,001	510,001		56,100	Total Taxable	56,100 6,069.00	<b>Sale History</b> <table border="1"> <thead> <tr> <th>Bk/Pg</th> <th>Grantor</th> <th>Date</th> <th>Price</th> <th>Code</th> </tr> </thead> <tbody> <tr> <td>/</td> <td>THOMPSON, JUDY C</td> <td>09/25/2025</td> <td>510,000</td> <td>22</td> </tr> </tbody> </table>					Bk/Pg	Grantor	Date	Price	Code	/	THOMPSON, JUDY C	09/25/2025	510,000	22
Source	REAL	Fair Cash	Capped	Asmnt Level	Assessed	Levy Rate	108.182	Current Tax																																																								
Remove Cap	2026	Land Value	221,106	221,106	11%	24,322	Assessed	56,100 6,068.98																																																								
Year Frozen	2014	Improvements	288,895	288,895		31,778	Penalty	0																																																								
Uncapped Value	0	Mobile Home	0	0		0	Exemption	0 0.00																																																								
TIF Project ID	0	Total Value	510,001	510,001		56,100	Total Taxable	56,100 6,069.00																																																								
Bk/Pg	Grantor	Date	Price	Code																																																												
/	THOMPSON, JUDY C	09/25/2025	510,000	22																																																												
<b>Assessment History</b> <table border="1"> <thead> <tr> <th>Tax Year</th> <th>Statement Number</th> <th>Billed Owner</th> <th>Tax Area</th> <th>Total Value</th> <th>Exemptions</th> <th>Taxable Value</th> <th>Billed Tax</th> </tr> </thead> <tbody> <tr> <td>2025</td> <td>2025-660110459</td> <td>TABOR, CRAIG &amp; LEAH</td> <td>10</td> <td>346,264</td> <td>1000</td> <td>19,572</td> <td>2,131.00</td> </tr> </tbody> </table>					Tax Year	Statement Number	Billed Owner	Tax Area	Total Value	Exemptions	Taxable Value	Billed Tax	2025	2025-660110459	TABOR, CRAIG & LEAH	10	346,264	1000	19,572	2,131.00																																												
Tax Year	Statement Number	Billed Owner	Tax Area	Total Value	Exemptions	Taxable Value	Billed Tax																																																									
2025	2025-660110459	TABOR, CRAIG & LEAH	10	346,264	1000	19,572	2,131.00																																																									



# Rogers

## Assessment Property Record Card for Tax Year 2026

Data provided by LISA DELOZIER County Assessor

Date 04/18/2026  
 Time 11:41:49  
 Page 2

Lot Data		Square-Foot - NBHD 1217 #1	
Lot Size	0	0	
Lot Count	0		
Units Buildable	0		
Non-Ag Acres	0		
Topography			
Street Access			
Utilities			
Amenities	LAND QUALITY		0
			0
Method	Square-Foot		
Base Lot Value	427,306.00 x .13 = 53,621		
Factor Value			
Adjustments	4.1235		
Lot Value	221,106		



Residential Data	
Type	1 Single Family Residence
Condition	3.5 - Average
Quality	3 - Average
Architecture	
Style	100% One Story
Exterior Wall	90% Veneer, Masonry 10% Frame, Siding, Wood
Base/Total Area	2,240 / 2,240
Style	100% One Story
HVAC	100% Warmed & Cooled Air
Roof Cover	1 Composition Shingle
Area on Slab	2,240
Fixture/RghIn	11 /
Bed/F/H Bath	3 / 2.0 /
Basement Area	
Garage Type	600 Attached Garage - Unfinished
Remodel	
Year/Eff Age	1999 / 18

GRM Approach	
GRM Code	
Gross Rent	0.00
Indicated Value	

Multiple Regression			
MRA Code	1	Test	
Adusted R	0.8445		
Indicated Value	297,035	132.60	Per SqFt

Direct Comparables	
Selection Model	A Adam Test
Adjustment Model	1 2022 Residential
Comparables	
Indicated Value	

Cost Approach		Manual : 01/2025	
Base Cost	104.04	Total Misc Impr	+ 21,353
Roofing Adj	+ 4.58	Garage Cost	+ 18,330
Subfloor Adj	+ -2.19	Total RCN	= 321,923
Heat/Cool Adj	+ 12.64	Depreciation ( 20%)	- 64,385
Plumbing Adj	+ 6.93	Lump Sums	+ 0
Basement Adj	+ 0.00	RCNLD	= 257,538
Adj Base Cost	= 126.00	Lot Value	+ 221,106
Total Area	x 2,240	Indicated Value	= 478,644
Adjusted Cost	= 282,240	Value Per SqFt	213.68

Value Reconciliation			
Selected Approach	Cost Approach		
Improvements	257,538		
Lot Value	221,106		
Indicated Value	478,644	213.68	Per SqFt
Agland Value			
Site Improvements	31,357		
Total Value	510,001	227.68	Total Value Per SqFt

Miscellaneous Improvements								
Code	Description	Sketch ID	Size	Year	Units	Unit Cost	Depr	Value
FPR1	FIREPLACE - RESIDENTIAL 1 STORY	0		1	1	5,615.40		5,615
SHLT	STORM SHELTER	0		1	2017	0.00		
PRCH	SLAB PORCH - COVERED	63777	333		333	25.89		8,621
PRCH	SLAB PORCH - COVERED	63778	39x7		273	26.07		7,117



# Rogers

## Assessment Property Record Card for Tax Year 2026

Data provided by LISA DELOZIER County Assessor

Date 04/18/2026

Time 11:41:49

Page 3

### Sketch Image

660110459

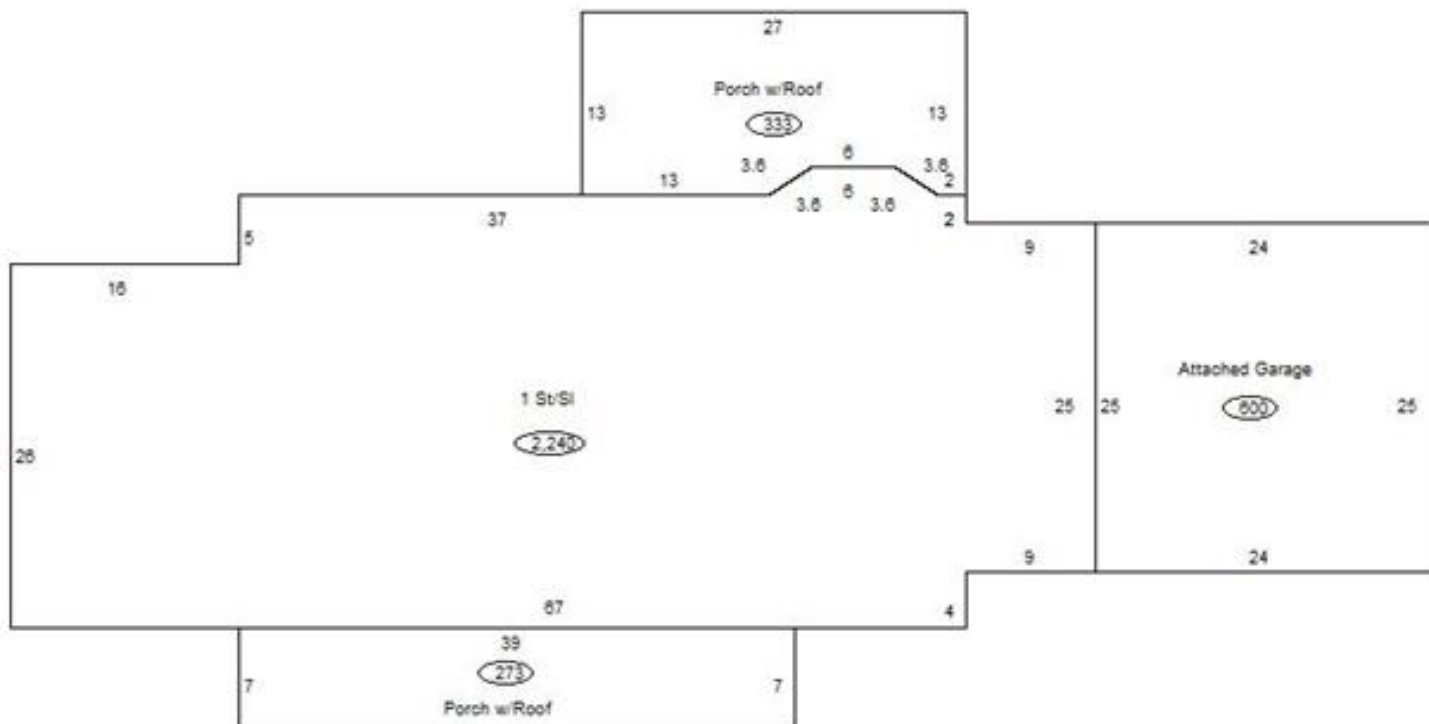

### Sketch Vector Information

Sequence	Code	Type	Built Over	Scale	Section Label	Base Area	Multiplier	Total Area
1	R	1	Slab	10	1 St/Sl	2,240	1.000	2,240
2	G	1		10	Attached Garage	600	1.000	600
3	M	PRCH		10	SLBC	333	1.000	333
4	M	PRCH		10	SLBC	273	1.000	273
<b>Total Building Area</b>						<b>2,240</b>		<b>2,240</b>



# Rogers



## Assessment Property Record Card for Tax Year 2026

Data provided by LISA DELOZIER County Assessor

Date 04/18/2026  
 Time 11:41:49  
 Page 4

660110459

### Outbuildings/Site Improvements

Building Image	Code	Description	Dimensions	Floor	Roofing	Total Units
	BARN	BARN	0x0x0			2,058
	Qual	3	Cond 3	Year	Eff Age	
	<b>Valuation Summary</b>		<b>Modifier Total</b>	<b>RCN</b>	<b>Depr (45% Phys/ % Func)</b>	<b>RCNLD</b>
	Base Cost (9.08 x 2,058)	18,687		18,687	8,409	10,278
	UTIL	SHOP BUILDING	0x0x0			864
	Qual	3	Cond 3	Year	Eff Age	
	<b>Valuation Summary</b>		<b>Modifier Total</b>	<b>RCN</b>	<b>Depr (25% Phys/ % Func)</b>	<b>RCNLD</b>
	Base Cost (32.53 x 864)	28,106		28,106	7,027	21,079